



# **INSTRUCTION MANUAL**

**BEDIENUNGSANLEITUNG**

**MANUAL DE INSTRUCCIONES**

**MANUEL D'INSTRUCTIONS**

**MANUALE D'ISTRUZIONI**

**РУКОВОДСТВО ПО ЭКСПЛУАТАЦИИ**

**yeedi vac 2**

# Contents

1. Package Contents .....	7
2. Operating and Programming.....	10
3. Maintenance .....	15
4. Indicator Light.....	20
5. Troubleshooting.....	21
6. Product Specifications.....	25

## **IMPORTANT SAFETY INSTRUCTIONS FOR HOUSEHOLD USE ONLY**

When using an electrical Appliance, basic precautions should always be followed, including the following:

**WARNING: READ ALL SAFETY WARNINGS AND INSTRUCTIONS. FAILURE TO FOLLOW THE WARNINGS AND INSTRUCTIONS MAY RESULT IN ELECTRIC SHOCK, FIRE OR SERIOUS INJURY.**

**READ ALL INSTRUCTIONS BEFORE USING THIS APPLIANCE**

**SAVE THESE INSTRUCTIONS**

1. This Appliance can be used by children aged from 8 years and above and persons with reduced physical, sensory or mental capabilities or lack of experience and knowledge if they have been given supervision or instruction concerning use of the Appliance in a safe way and understand the hazards involved. Children shall not play with the Appliance. Cleaning and user maintenance shall not be made by children without supervision.(For European Union countries)
2. Clear the area to be cleaned. Remove power cords and small objects from the floor that

could entangle the Appliance. Tuck rug fringe under the rug base, and lift items such as curtains and tablecloths off the floor.

3. If there is a drop off in the cleaning area due to a step or stairs, you should operate the Appliance to ensure that it can detect the step without falling over the edge. It may become necessary to place a physical barrier at the edge to keep the unit from falling. Make sure the physical barrier is not a trip hazard.
4. Only use as described in this manual. Only use attachments recommended or sold by the manufacturer.
5. Please make sure your power supply source voltage matches the power voltage marked on the Docking Station.
6. For INDOOR household use ONLY. Do not use the Appliance in outdoor, commercial or industrial environments.
7. Use only the original rechargeable battery and Docking Station provided with the Appliance from the manufacturer. Non-rechargeable batteries are prohibited. For battery information, please refer to Specifications section.

8. Do not use without dust bin and/or filters in place.
9. Do not operate the Appliance in an area where there are lit candles or fragile objects.
10. Do not use in extremely hot or cold environments (below -5°C/23°F or above 40°C/104°F).
11. Keep hair, loose clothing, fingers, and all parts of body away from any openings and moving parts.
12. Do not operate the Appliance in a room where an infant or child is sleeping.
13. Do not use Appliance on wet surfaces or surfaces with standing water.
14. Do not allow the Appliance to pick up large objects like stones, large pieces of paper or any item that may clog the Appliance.
15. Do not use Appliance to pick up flammable or combustible materials such as gasoline, printer or copier toner, or use in areas where they may be present.
16. Do not use Appliance to pick up anything that is burning or smoking, such as cigarettes, matches, hot ashes, or anything that could cause a fire.
17. Do not put objects into the suction intake. Do not use if the suction intake is blocked.
18. Take care not to damage the power cord. Do not pull on or carry the Appliance or Docking Station by the power cord, use the power cord as a handle, close a door on the power cord, or pull power cord around sharp edges or corners. Do not run Appliance over the power cord. Keep power cord away from hot surfaces.
19. If the power cord is damaged, it must be replaced by the manufacturer or its service agent in order to avoid a hazard.
20. Do not use the Docking Station if it is damaged. The power supply is not to be repaired and not to be used any longer if it is damaged or defective.
21. Do not use with a damaged power cord or receptacle. Do not use the Appliance or Docking Station if it is not working properly, has been dropped, damaged, left outdoors, or come in contact with water. It must be repaired by the manufacturer or its service agent in order to avoid a hazard.
22. Turn OFF the power switch before cleaning or maintaining the Appliance.

23. The plug must be removed from the receptacle before cleaning or maintaining the Docking Station.
24. Remove the Appliance from the Docking Station, and turn OFF the power switch to the Appliance before removing the battery for disposal of the Appliance.
25. The battery must be removed and discarded according to local laws and regulations before disposal of the Appliance.
26. Please dispose of used batteries according to local laws and regulations.
27. Do not incinerate the Appliance even if it is severely damaged. The batteries can explode in a fire.
28. When not using the Docking Station for a long period of time, please unplug it.
29. The Appliance must be used in accordance with the directions in this Instruction Manual. The manufacturer cannot be held liable or responsible for any damages or injuries caused by improper use.
30. The robot contains batteries that are only replaceable by skilled persons. To replace the robot's battery, please contact Customer Service.
31. If the robot will not be used for a long time, power OFF the robot for storage and unplug the Docking Station.
- 32. WARNING:** For the purposes of recharging the battery, only use the detachable supply unit CH1822 provided with the Appliance, or CH1918 sold separately as an accessory.
33. This Appliance is not intended for use by persons (including children) with reduced physical, sensory or mental capabilities, or lack of experience and knowledge, unless they have been given supervision or instruction concerning use of the Appliance by a person responsible for their safety. Children should be supervised to ensure that they do not play with the Appliance. (For Non-European Union countries)

To satisfy RF exposure requirements, a separation distance of 20 cm or more should be maintained between this device and persons during device operation.







To ensure compliance, operations at closer than this distance is not recommended. The antenna used for this transmitter must not be co-located in conjunction with any other antenna or transmitter.

To disable Wi-Fi module on Robot, power the robot ON.

Place the robot on the Docking Station making sure the Charging Contacts on Robot and the Docking Station Pins make a connection.

Press and hold the AUTO Mode Button on the robot for 20 seconds until Robot emits 3 beeps.

To enable Wi-Fi module on Robot, power the robot OFF and then power ON. The Wi-Fi module is turned on when Robot is restarted.

	<b>Class II</b>
	<b>Short-circuit-proof safety isolating transformer</b>
	<b>Switch mode power supply</b>
	<b>For indoor use only</b>
	<b>Direct current</b>
	<b>Alternating current</b>

## For EU Countries

For EU Declaration of Conformity information, visit <https://www.yeedi.com/support>



## Correct Disposal of this Product

This marking indicates that this product should not be disposed of with other household waste throughout the EU. To prevent possible harm to the environment or human health from uncontrolled waste disposal, recycle it responsibly to promote the sustainable reuse of material resources. To recycle your used device, please use the return and collection systems or contact the retailer where the product was purchased. They can safely recycle this product.

Working	Temperature	-5-40°C
	Humidity	5%-95%
Storage	Temperature	-5-40°C
	Humidity	5%-95%
Service Life		5 years

# 1. Package Contents/1.1 Package Contents

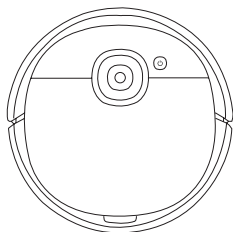

Robot

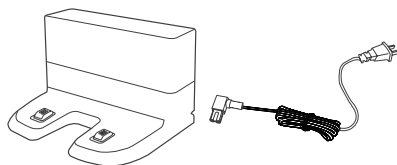

Docking Station



Edge Brush

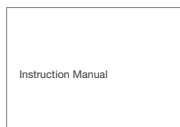

Instruction Manual



Washable Mopping Pad

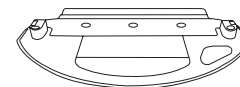

Mopping Pad Plate

**Note:** Figures and illustrations are for reference only and may differ from actual product appearance. Product design and specifications are subject to changes without notice.

\* Oscillating Mopping kit is sold separately .

Explore more accessories at <https://www.yeedi.com>.

# 1. Package Contents/1.2 Product Diagram

## Robot

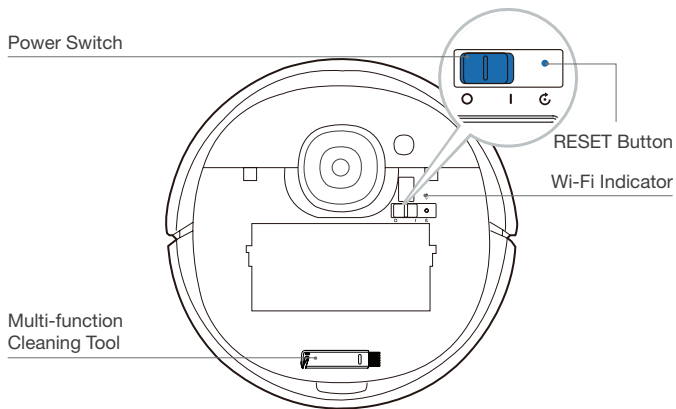
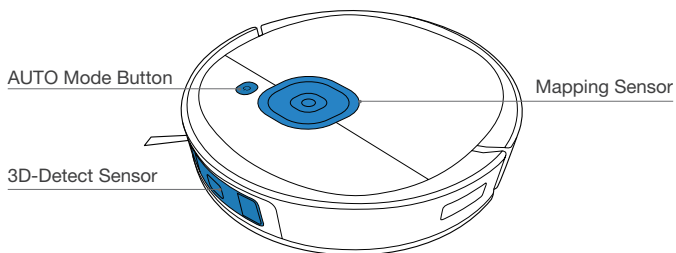

## Bottom View

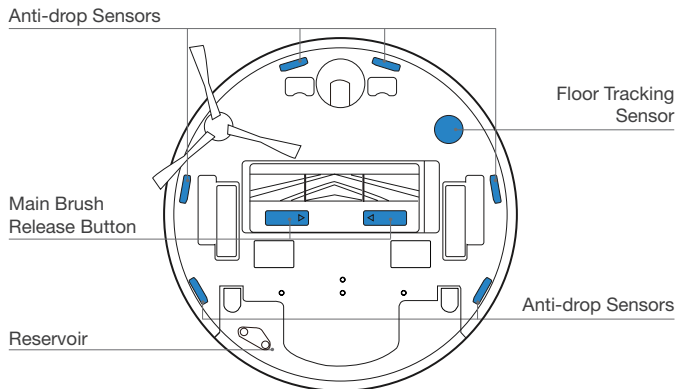
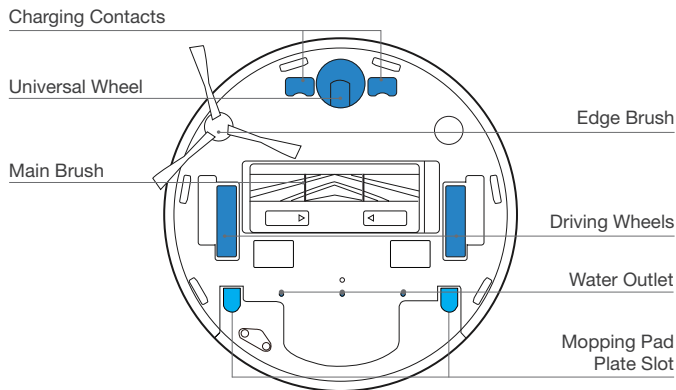



## Dust Bin

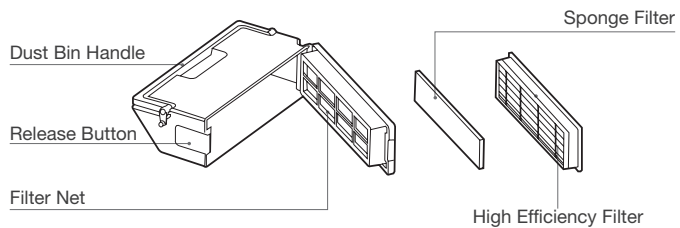

## Docking Station

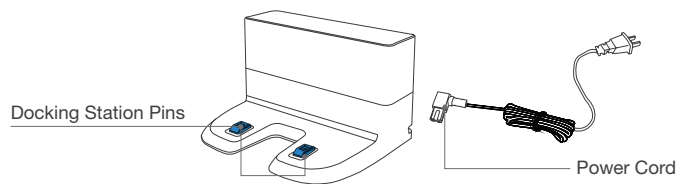

## Reservoir

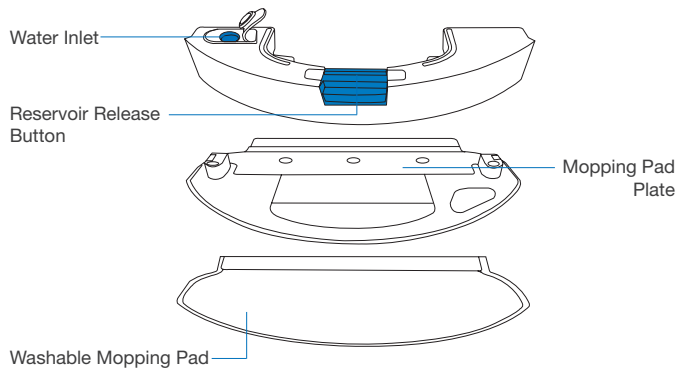

## 2. Operating and Programming/2.1 Notes Before Cleaning

Tidy up the area to be cleaned by putting furniture, such as chairs, in their proper place.

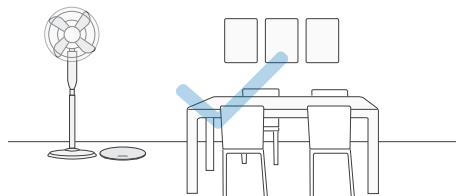

During the first use, make sure each room door is open to help Robot fully explore your house.

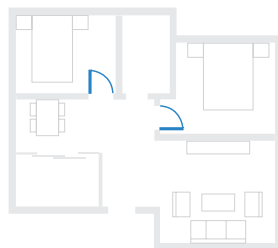

It may be necessary to place a physical barrier at the edge of a drop to stop the unit from falling over the edge.

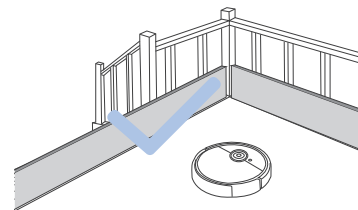

Put away objects including wires, cloths and slippers, etc. on the floor to improve the cleaning efficiency.



Before using the product on a rug with tasseled edges, please fold the rug edges under.



Please do not stand in narrow spaces, such as hallways, and make sure not to block the Detection Sensor.

## 2. Operating and Programming/2.2 Preparation

Please remove all protection materials on Robot and Docking Station before use.

### 1 Assemble Docking Station

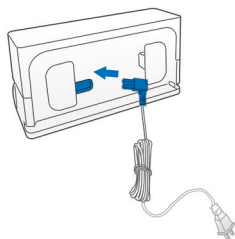

### 2 Docking Station Placement

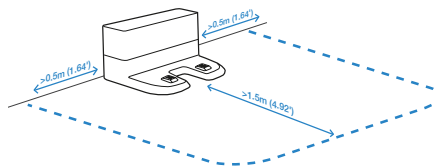

### 3 Install Edge Brush

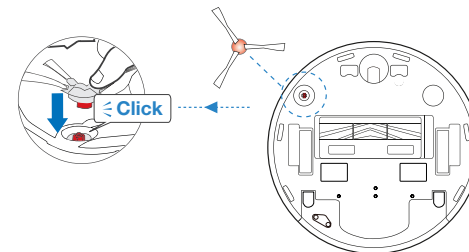

### 4 Power ON

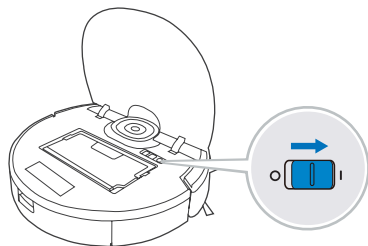

### 5 Charge Robot

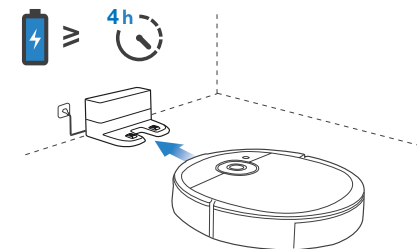

**Note:** When Robot completes the cleaning cycle or when the battery gets low, Robot automatically returns to the Docking Station to recharge itself. Robot can also be sent back to the Docking Station at any time by using the yeedi App or by pressing the AUTO Button on the robot for 3 seconds. Empty remaining water from the Reservoir and remove the Mopping Pad Plate before charging Robot.

## 2. Operating and Programming/2.3 yeedi App

To enjoy all available features, it is recommended to control your Robot via the yeedi App.

### Before you start, make sure that:

- Your mobile phone is connected to a Wi-Fi network.
- The 2.4GHz band wireless signal is enabled on your router.
- The Wi-Fi indicator light on Robot is slowly flashing.

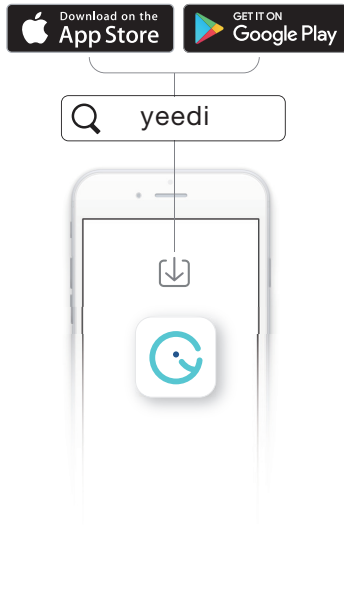

### Wi-Fi Indicator Light

	Slowly flashing	Disconnected to Wi-Fi or waiting for Wi-Fi connection
	Rapidly flashing	Connecting to Wi-Fi
	Solid	Connected to Wi-Fi

### Tips:

If you have any problems during the Wi-Fi setup process, refer to the Troubleshooting > Wi-Fi Connection section in this manual.

## 2. Operating and Programming/2.4 Start, Pause, Wake Up, Power Off

### During the first cleaning:

Please supervise Robot and assist it should there be a problem.

#### 1 Start

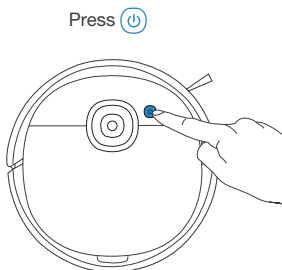

#### 3 Wake Up

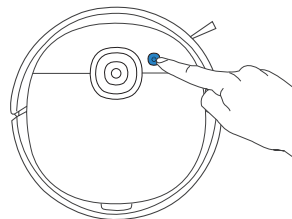

Press the AUTO button on Robot to wake it up

#### 2 Pause

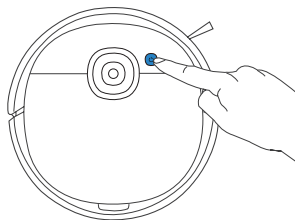

#### 4 Power OFF

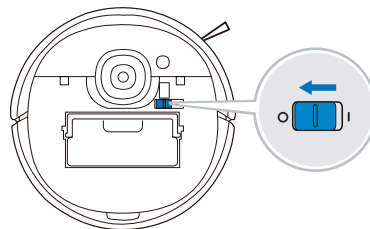

**Note:** The robot's Control Panel stops glowing after the robot is paused for a few minutes. Press the AUTO Mode Button on Robot to wake it up.

**Note:** When Robot is not working, it is recommended to keep it switched ON and charging.

## 2. Operating and Programming/2.5 Mopping System

### Note:

1. To prolong the service life of the reservoir, it is recommended to use purified water or softened water for the mopping system.
2. If you need to clean the carpet, please uninstall the Mopping Pad Plate first.
3. Empty the reservoir after Robot finishes mopping.

1

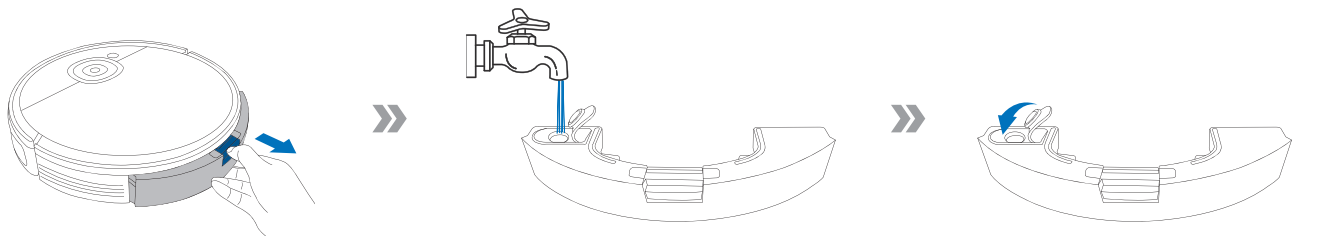

2

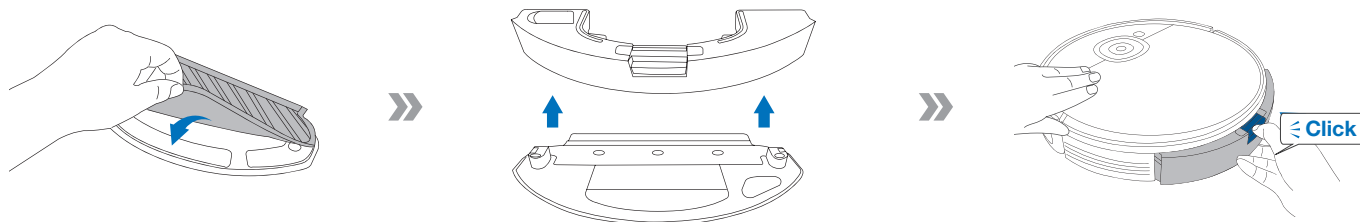

# 3. Maintenance/3.1 Mopping System

Before performing cleaning and maintenance tasks on Robot, turn the robot OFF and unplug the Docking Station.

1

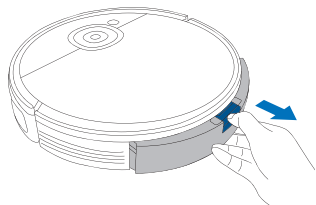

2

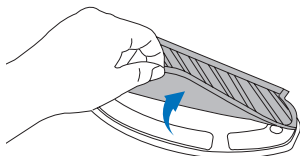

3

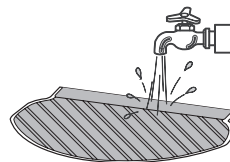

4

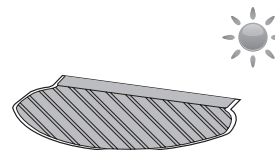

5

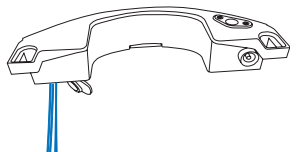

6

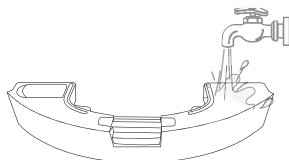

7

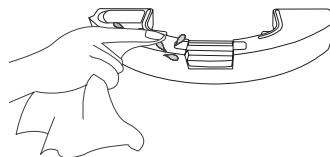

8

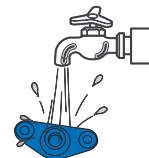
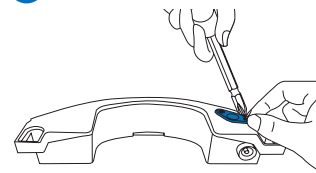

### 3. Maintenance/3.2 Dust Bin and Filters

1

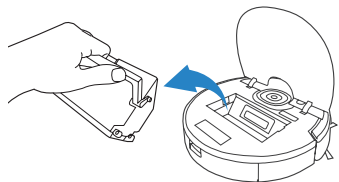

4

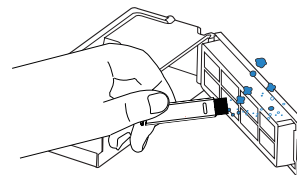

2

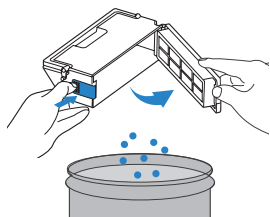

5

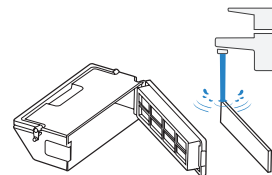

3

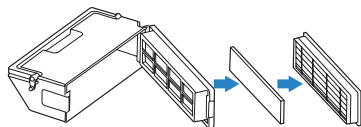

6

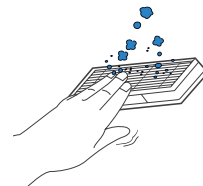

7

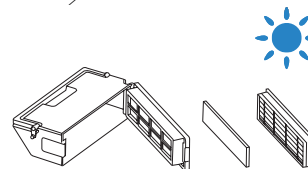

**Note:** 1. Please rinse the filter with water as shown above. 2. Do not use finger or brush to clean the filter. 3. Be sure to dry out the filter for at least 24 hours after washing.



### 3. Maintenance/3.3 Main Brush, Edge Brush and Mapping Sensor

**Note:** A Multi-Function Cleaning Tool is provided for easy maintenance. Handle with care, this cleaning tool has sharp edges.

#### Main Brush

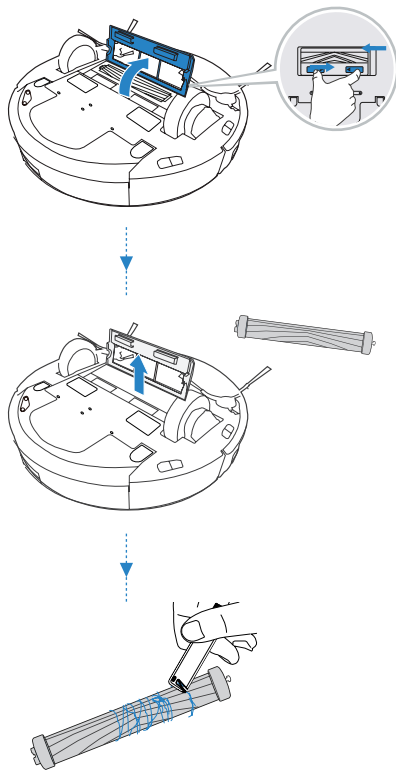

#### Edge Brush

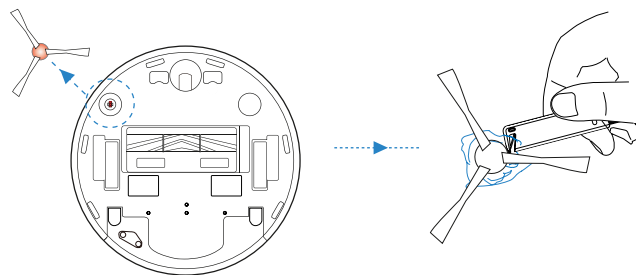

#### Mapping Sensor

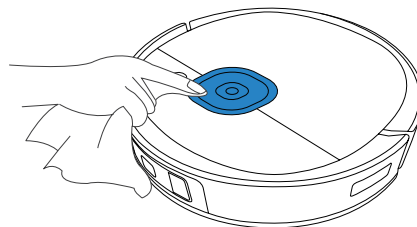

### 3. Maintenance/3.4 Other Components

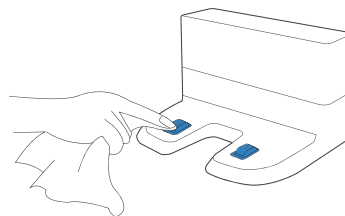
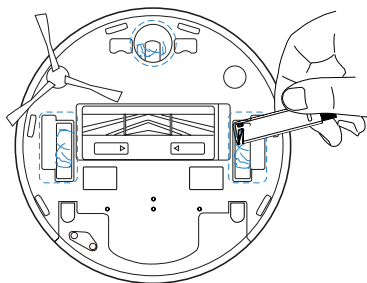
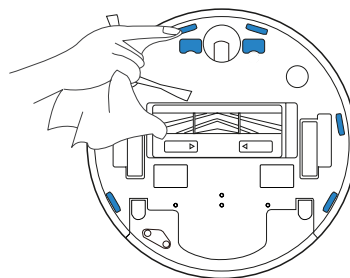
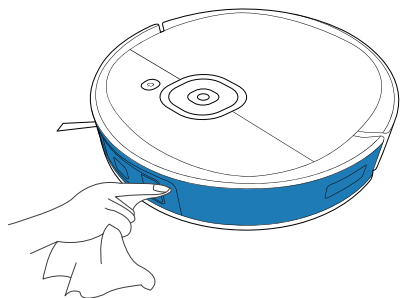

**Note:** Before cleaning the robot's Charging Contacts and Docking Station Pins, turn the robot OFF and unplug the Docking Station.

### 3. Maintenance/3.5 Regular Maintenance

To keep Robot running at peak performance, perform maintenance tasks and replace parts with the following frequencies:

Robot Part	Maintenance Frequency	Replacement Frequency
Washable Mopping Pad	After each use	Every 50 washings
Reservoir/Mopping Pad Plate	After each use	/
Edge Brush	Once every 2 weeks	Every 3-6 months
Main Brush	Once per week	Every 6-12 months
Sponge Filter/High Efficiency Filter	Once per week	Every 3-6 months
3D-Detect Sensor Universal Wheel Anti-Drop Sensors Bumper Mapping Sensor Charging Contacts Docking Station Pins	Once per week	/

**A multi-function Cleaning Tool is provided for easy maintenance. Handle with care, this cleaning tool has sharp edges.**

**Note:** yeedi manufactures various replacement parts and fittings. Please contact Customer Service for more information on replacement parts.

# 4. Indicator Light

## Robot

Robot will tell you something is wrong with an indicator light and voice report. More detailed support is available through the yeedi app and online website.

Indicator Light	Scenario
AUTO Mode Button glows a solid WHITE.	The robot is cleaning.
	The robot is paused while cleaning.
AUTO Mode Button flashes WHITE.	The robot is charging.
	The robot is starting.
	The robot is relocating.
AUTO Mode Button glows a solid RED.	The robot has low battery.
AUTO Mode Button flashes RED.	The robot has a problem.

## 5. Troubleshooting/5.1 Troubleshooting

No.	Malfunction	Possible Causes	Solutions
1	Robot is not able to connect to the home Wi-Fi network.	Incorrect home Wi-Fi username or password entered.	Enter the correct home Wi-Fi username and password.
		Robot is not within range of your home Wi-Fi signal.	Make sure Robot is within range of your home Wi-Fi signal.
		Network setup started before Robot was ready.	Turn ON Power Switch. Press the RESET Button for 3 seconds. Robot is ready for network setup when it plays a musical tune and its Wi-Fi Indicator light flashes slowly.
2	Robot is not charging.	Robot is not switched ON.	Switch ON Robot.
		Robot has not connected to the Docking Station.	Be sure that the robot's Charging Contacts have connected to the Docking Station Pins.
		The Power Cord is not connected to the Docking Station.	Make sure the Power Cord is firmly connected to the Docking Station.
		The battery is completely discharged.	Re-activate the battery. Switch ON. Place Robot on the Docking Station by hand, remove after charging for 3 minutes, repeat 3 times; then charge normally.
		Make sure the Docking Station is connected to the power supply.	The Docking Station is not connected to the power supply.

No.	Malfunction	Possible Causes	Solutions
3	Robot cannot return to the Docking Station.	The Docking Station is not correctly placed.	Refer to section 2.2 to correctly place the Docking Station.
		The Docking Station is disconnected or moved.	Please check if the Docking Station is connected to power. Do not move the Docking Station manually.
		Robot is working in a dark environment.	Make sure to use Robot in a well illuminated environment.
		Robot is paused for more than 60 minutes.	Avoid pausing Robot for over 60 minutes.
		Robot did not start cleaning from the Docking Station.	Make sure Robot starts cleaning from the Docking Station.
4	Robot returns to the Docking Station before it has finished cleaning.	Robot is working in a dark environment.	Make sure to use Robot in a well illuminated environment.
		When the battery gets low, Robot automatically switches to Return to Charger Mode and returns to the Docking Station to recharge itself.	This is normal. No solution necessary.
		Working time varies according to floor surface, room complexity and the Cleaning Mode selected.	This is normal. No solution necessary.
		The cleaning area is not tidy.	Remove small objects from the floor and tidy up the cleaning area before Robot starts cleaning.
5	Robot gets stuck while working and stops.	Robot is tangled with something on the floor (electrical wires, curtains, Carpet fringing, etc.).	Robot will try various ways to free itself. If it is unsuccessful, manually remove the obstacles and restart.
6	Robot makes much noise when cleaning.	The brushes are tangled, or the dust bin is stuck.	Clear the debris stuck regularly.

No.	Malfunction	Possible Causes	Solutions
7	The water is not coming out of the Reservoir when Robot is mopping.	The water inlet filter on the bottom of Reservoir is clogged.	Unscrew the water inlet on the bottom of Reservoir and clean the filter.
		The Reservoir runs out of water.	Add water into the Reservoir.
		The water outlets on the bottom of Robot are clogged.	Check the water outlets on the bottom and clean.
8	The reservoir drops out of place during cleaning.	The reservoir is not properly installed.	The reservoir is properly installed when it clicks into place.

## 5. Troubleshooting/5.2 Wi-Fi Connection

Before Wi-Fi setup, make sure Robot, mobile phone, and Wi-Fi network meet the following requirements.

### Robot and Mobile Phone Requirements

- Robot is fully charged and the power switch of Robot is turned on.
- Wi-Fi status light slowly flashes.
- Turn off mobile phone's cellular data (you can turn it back on after setup).

### Wi-Fi Network Requirements

- You are using a 2.4GHz or 2.4/5 GHz mixed network.
- Your router supports 802.11b/g/n and IPv4 protocol.
- Do not use a VPN (Virtual Private Network) or Proxy Server.
- Do not use a hidden network.
- WPA and WPA2 using TKIP, PSK, AES/CCMP encryption.
- WEP EAP (Enterprise Authentication Protocol) is not supported.
- Use Wi-Fi channels 1-11 in North America and channels 1-13 outside North America (refer to local regulatory agency).
- If you are using a network extender/repeater, the network name (SSID) and password are the same as your primary network.



## 6. Product Specifications

<b>Model</b>	<b>YDVN21</b>				
Rated Input	20V === 1A				
<b>Docking Station Model</b>	<b>CH1822</b>		<b>CH1918*</b>		
Rated Input	100-240V ~ 50-60Hz 0.5A	Rated Input (Charging)	For European Union Only	220-240V ~ 50-60Hz 0.3A	
			For Russia Only	220V ~ 50-60Hz 0.3A	
	Rated Output	20V === 1A	Rated Output	20V === 1A	
	/	Power (Auto-Emptying)	1000W		
Frequency bands	2400-2483.5MHz				
Off Mode Power	Less than 0.50W				
Networked Standby Power	Less than 2.00W				

Output power of the Wi-Fi module is less than 100mW.

**Note:** Technical and design specifications may be changed for continuous product improvement.

\* CH1918 is an Self-empty Station sold separately that automatically empties your Robot's dustbin.

Explore more accessories at <https://www.yeedi.com>.