



EASY FRY & GRILL XXL

www.tefal.com
www.moulinex.com
www.arno.com.br
www.imusa.com.co



Instructions of Use text / Notice d'utilisation texte / Gebrauchsanweisung Text / Gebruiksaanwijzing tekst / Texto de instrucciones de uso / Testo delle istruzioni d'uso / Texto de instruções de uso / Οδηγίες χρήσης κειμένου / Használati utasítás szövege / Tekst for bruksanvisning / Text för bruksanvisning / Instrukciuni de utilizare text / Текст унутства за употребу / Text návodu na použitie / Text návodu k použití / Besedilo z navodili za uporabo / Tekst uputa za uporabu / Tekst uputstva za upotrebu / Tekst instrukcji użytkowania / Инструкција по испoльзованию текст / Текст інструкції з використання / Текст с инструкции за употреба / Kasutusjuhendi tekst / Lietošanas instrukcijas teksts / Naudojimo instrukcijų tekstas / Мәтінді қолдану бойынша нұсқаулар / Kullanim metni metni

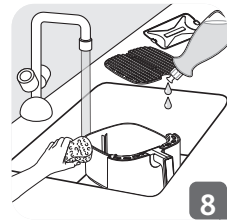
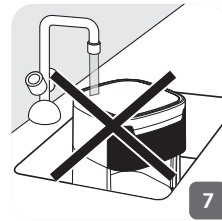
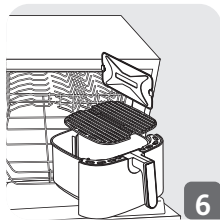
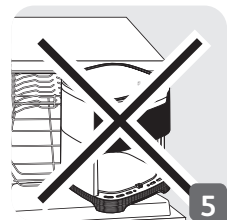
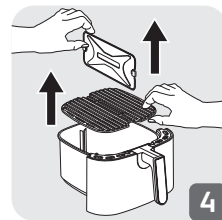
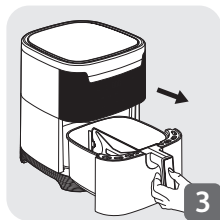
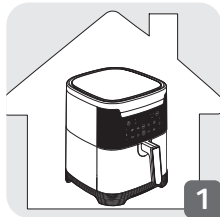
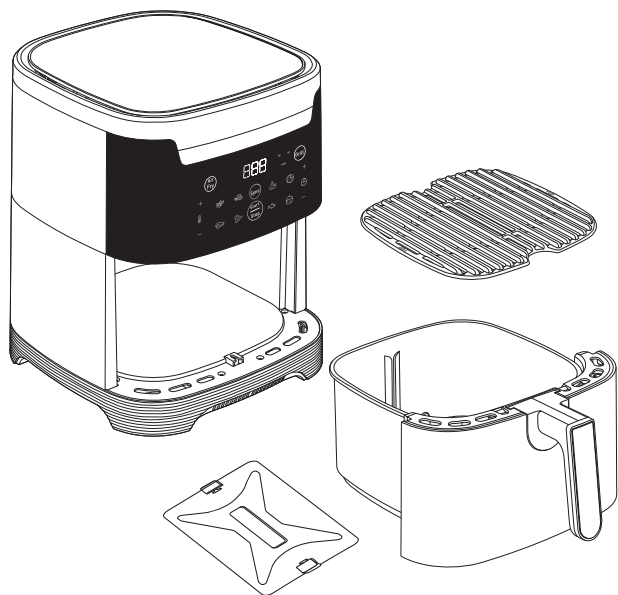

3



MAX 1200 g

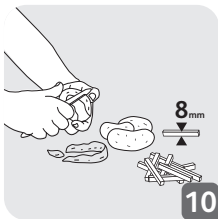

10



11



12

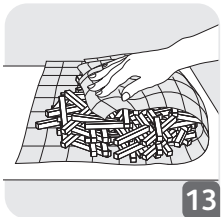

13



14



15



16



17



MAX 1200 g

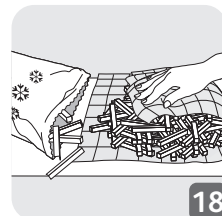

18

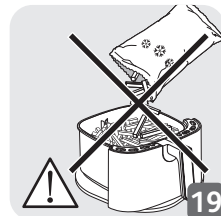

19

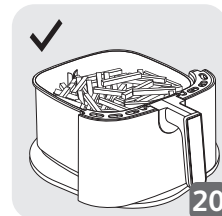

20

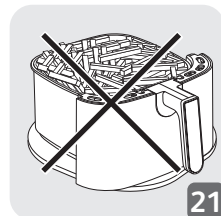

21

4

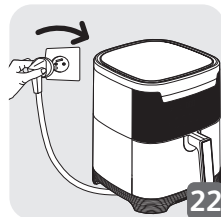

22

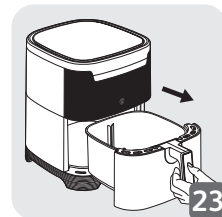

23

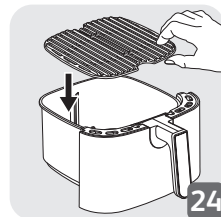

24

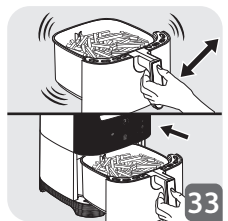
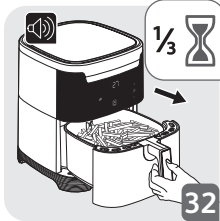
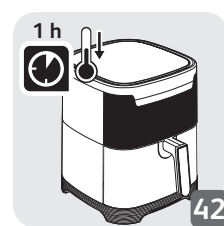
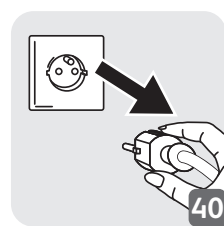
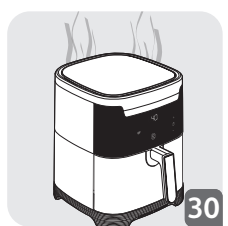
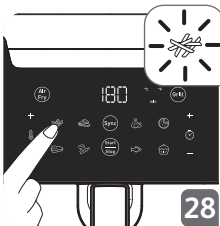
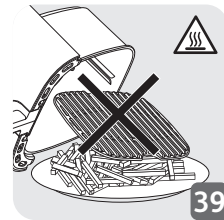
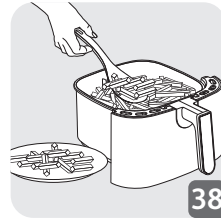
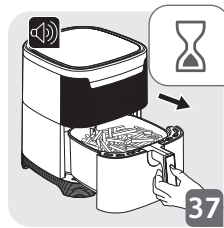
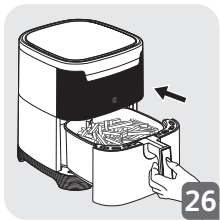
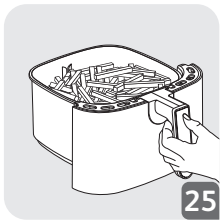

5

Sync

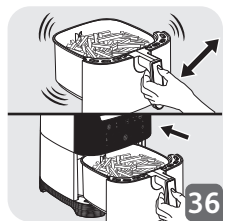
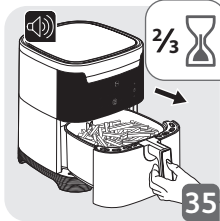
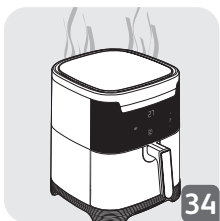
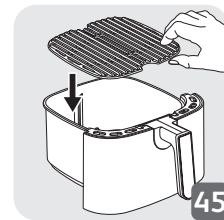
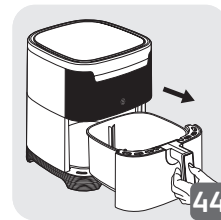
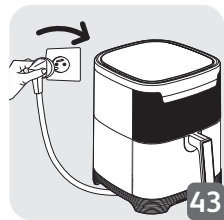

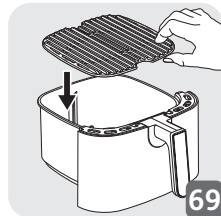
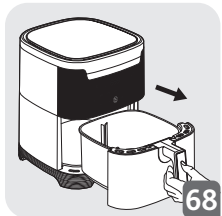
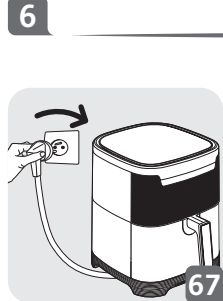
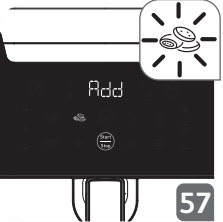
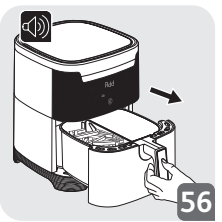
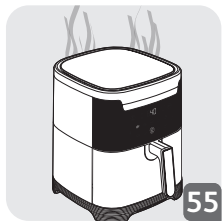
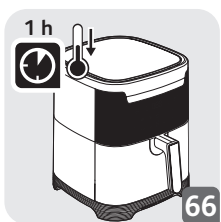
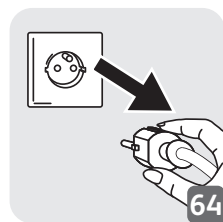
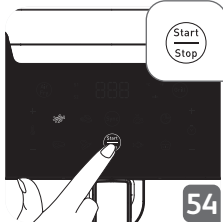
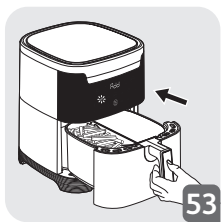
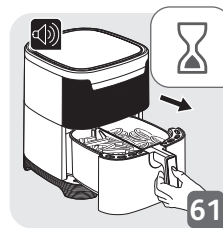
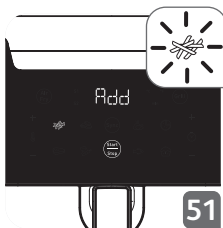
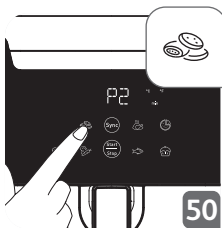
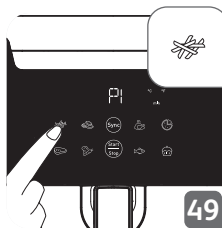
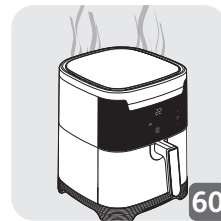
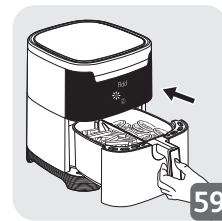
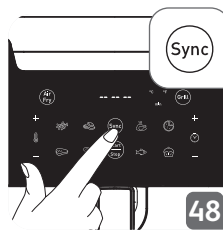
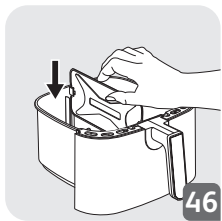

6 Grill

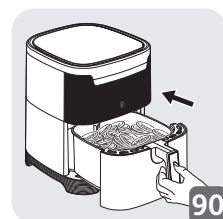
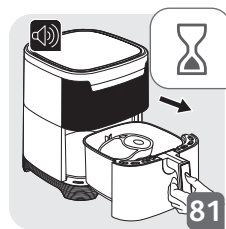
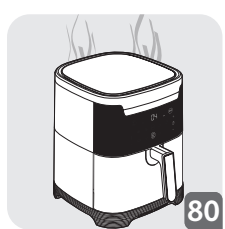
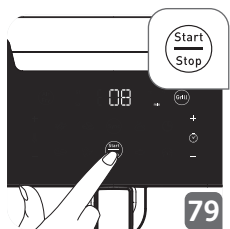
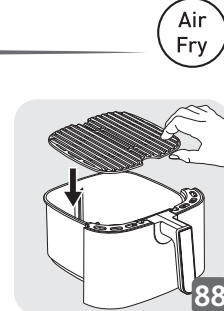
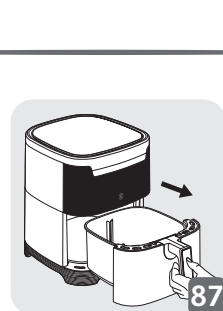
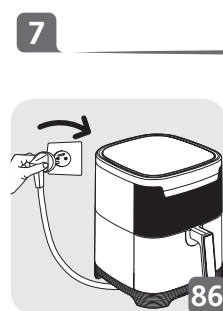
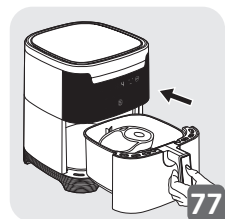
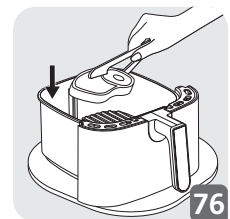
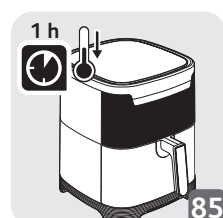
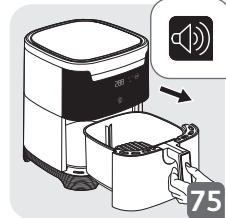
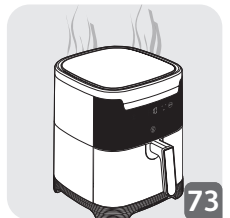
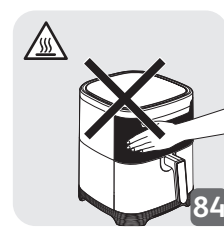
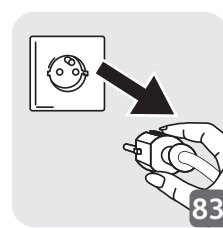
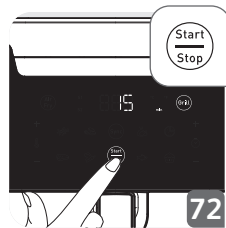
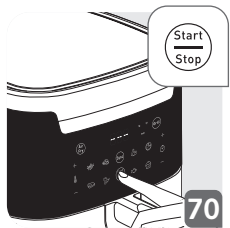

7 Air Fry

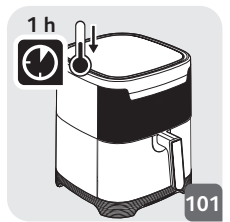
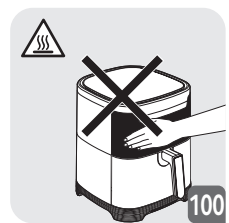
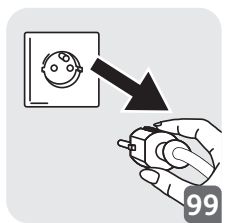
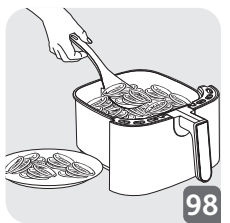
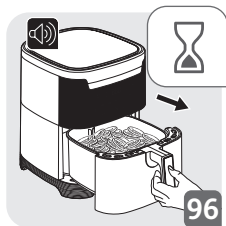
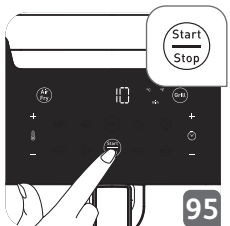
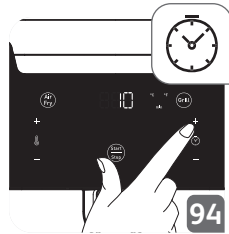
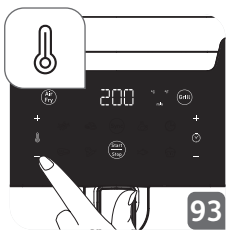

8

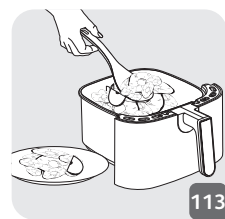
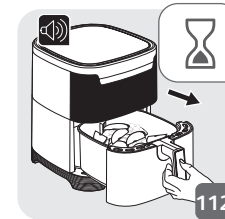
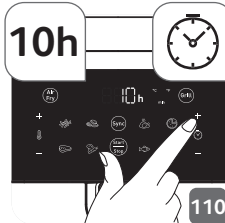
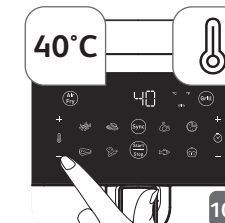
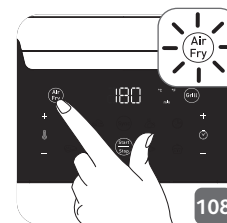
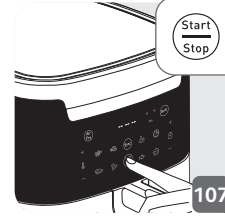
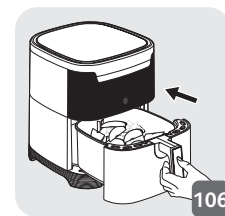
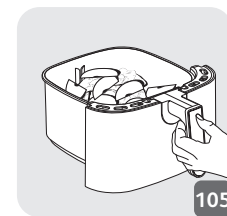
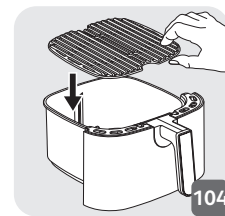
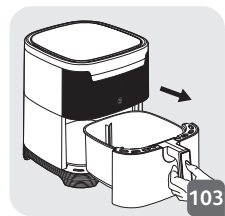
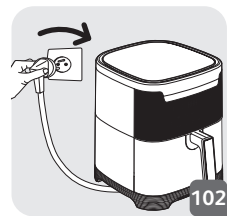

	1000 - 1200 g	35 - 45 min	180°C	✓ x2	✓		
	1000 - 1200 g	30 - 40 min	180°C	✓ x2	✓		
	1000 - 1200 g	35 - 45 min	180°C	✓ x2	✓		
	300 g - 700 g	16 - 20 min	200°C	✓	✓		
	100 g - 500 g	12 - 19 min	180°C		✓		
	1600 g	60 min	200°C				
	2000 g	45 min	200°C	✓	✓		
	5 pieces	12 min	180°C	✓	✓		
	500 g	9 - 11 min	200°C	✓	✓		
	400 g	7 - 10 min	190°C		✓		
	4 pieces	14 - 17 min	140°C		✓		
	20 pieces	5 min	170°C		✓		
	8 pieces	15 - 18 min	180°C		✓		
	4 pieces	10 h	40°C		✓		

Grill

STEP						
		250 g	6 - 8 min	220°C	✓	
		300 g	10 min	220°C	✓	
		400 g	10 - 12 min	220°C	✓	
15 min 220°C		200 g	3 - 5 min	170°C	✓	

Sync



	600 g			600 g	
	600 g			1 piece	
	600 g			1 piece	
	1 slice			500 g	
	600 g			600 g	
	1 slice			4 pcs	

10

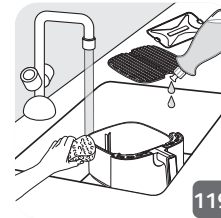
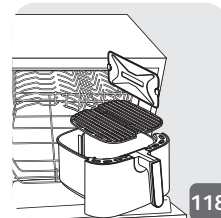
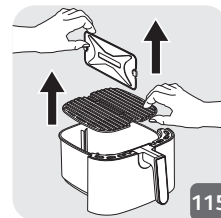
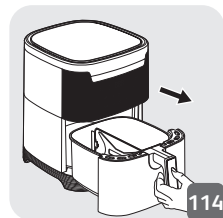

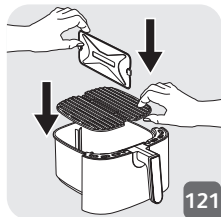
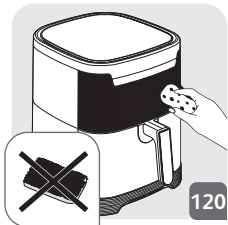

12



