



RAZER BASILISK V3 X HYPERSPEED

MASTER GUIDE

With the **Razer Basilisk V3 X HyperSpeed**, there are no limits on how you choose to play. Armed with 9 programmable controls, dual-mode wireless connectivity, and customizable Razer Chroma™ RGB, it is made to answer to only one master—you.

CONTENTS

1. WHAT'S INSIDE	3
2. WHAT'S NEEDED	4
3. LET'S GET YOU COVERED	4
4. TECHNICAL SPECIFICATIONS.....	5
5. SETTING UP YOUR RAZER BASILISK V3 X HYPERSPEED.....	6
6. USING YOUR RAZER BASILISK V3 X HYPERSPEED.....	11
7. CONFIGURING YOUR RAZER BASILISK V3 X HYPERSPEED VIA RAZER SYNAPSE.....	12
8. SAFETY AND MAINTENANCE	29
9. LEGALESE	31

1. WHAT'S INSIDE

- Razer Basilisk V3 X HyperSpeed

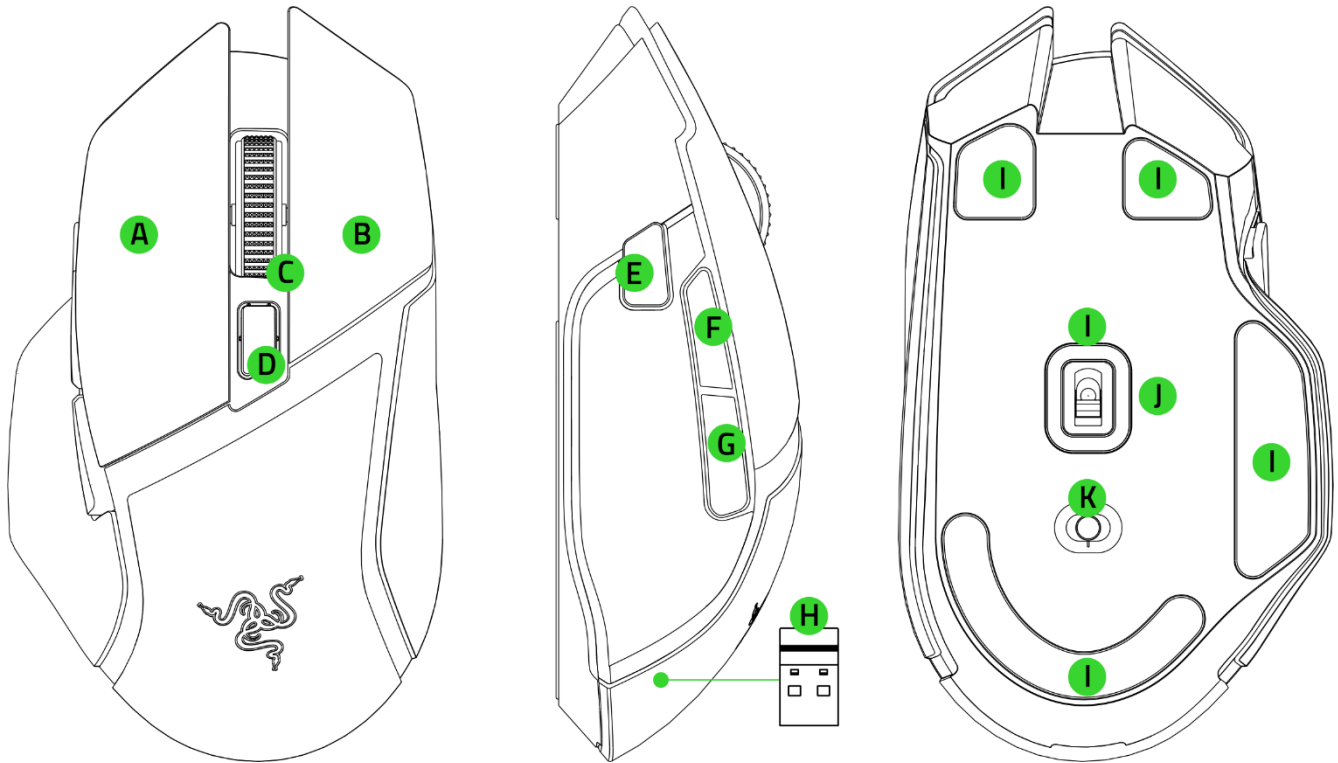

- A. Left mouse button
- B. Right mouse button
- C. Scroll wheel
- D. DPI cycle button*
- E. Multi-function trigger
- F. Mouse button 5
- G. Mouse button 4
- H. Wireless USB dongle

- I. PTFE mouse feet
- J. Razer™ 5G Advanced 18K Optical Sensor
- K. Slider switch
 - Razer™ HyperSpeed Wireless (2.4 GHz) mode
 - Power off mode
 - Bluetooth mode

**The DPI stages are 400, 800, 1600 (default), 3200, and 6400, and they can be customized using Razer Synapse.*

- 1 x AA battery
- Important Product Information Guide

2. WHAT'S NEEDED

PRODUCT REQUIREMENTS

- USB Type A port or Bluetooth connectivity
- 1 x AA battery

RAZER SYNAPSE REQUIREMENTS

- Windows® 10 64-bit (or higher)
- Internet connection for software installation

3. LET'S GET YOU COVERED



Register your product and score exclusive benefits

razerid.razer.com/warranty

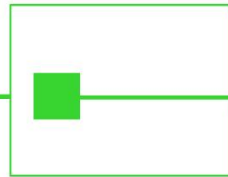
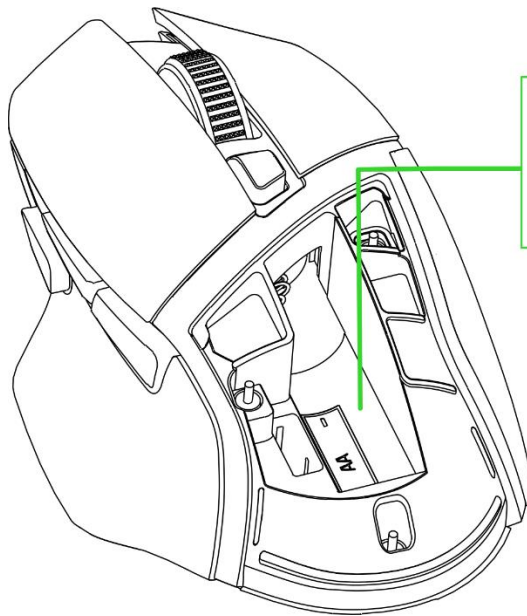

*Your product's
serial number can
be found here.*

4. TECHNICAL SPECIFICATIONS

- Form factor: Right-handed Symmetrical
- Connectivity:
 - Razer HyperSpeed Wireless (2.4GHz) with dual device support
 - Bluetooth
- Battery life:
 - Up to 285 hours on Razer HyperSpeed Wireless (constant motion at 1000 Hz)
 - Up to 535 hours on Bluetooth
- RGB lighting: Razer Chroma RGB (Scroll Wheel)
- Sensor: Razer™ 5G Advanced 18K DPI Optical Sensor
- Max sensitivity (DPI): 18000
- Max speed (IPS): 450
- Max acceleration (G): 40
- Programmable buttons: 7
- Switch type: Razer™ Mechanical Mouse Switches Gen-2
- Switch lifecycle: 60-Million Clicks
- On-board memory profiles: 1
- Mouse feet: 100% PTFE
- Tilt scroll wheel: No
- Polling rate: 1000 Hz

5. SETTING UP YOUR RAZER BASILISK V3 X HYPERSPEED

INSERTING A BATTERY

1. Remove the top cover of the mouse and insert the AA battery as indicated in the battery compartment.

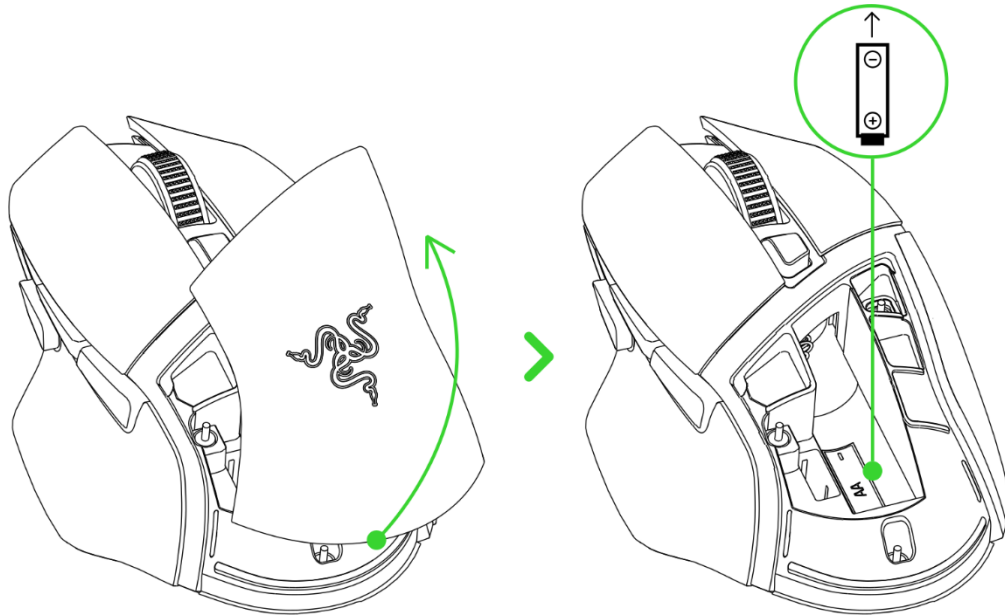

Caution: The included AA battery is non-rechargeable. Dispose of batteries in accordance with your local environmental laws. For your safety, use only lithium or alkaline batteries.

2. Reattach the top cover onto the mouse and make sure that it is tightly secured.

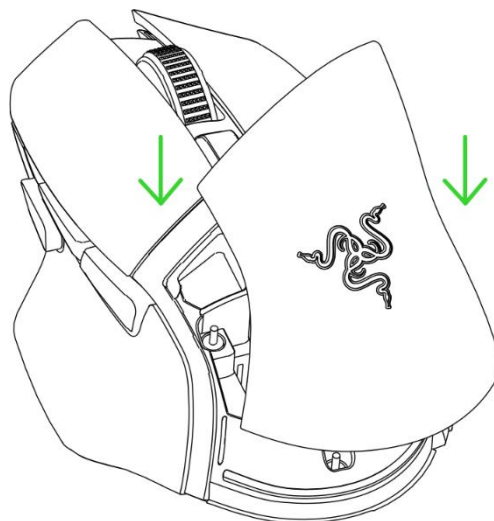

CONNECTING YOUR MOUSE

A. Via Razer™ Hyperspeed Wireless (2.4 GHz) mode

1. Remove the top cover of the mouse and take out the wireless USB dongle.

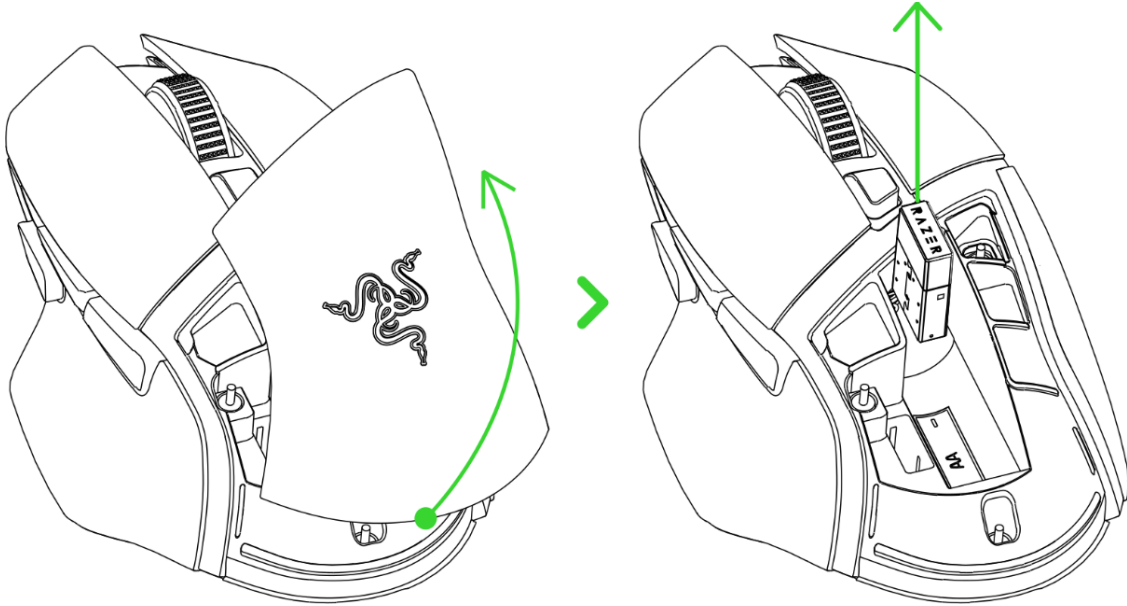

2. Reattach the top cover and plug the wireless USB dongle into your PC.

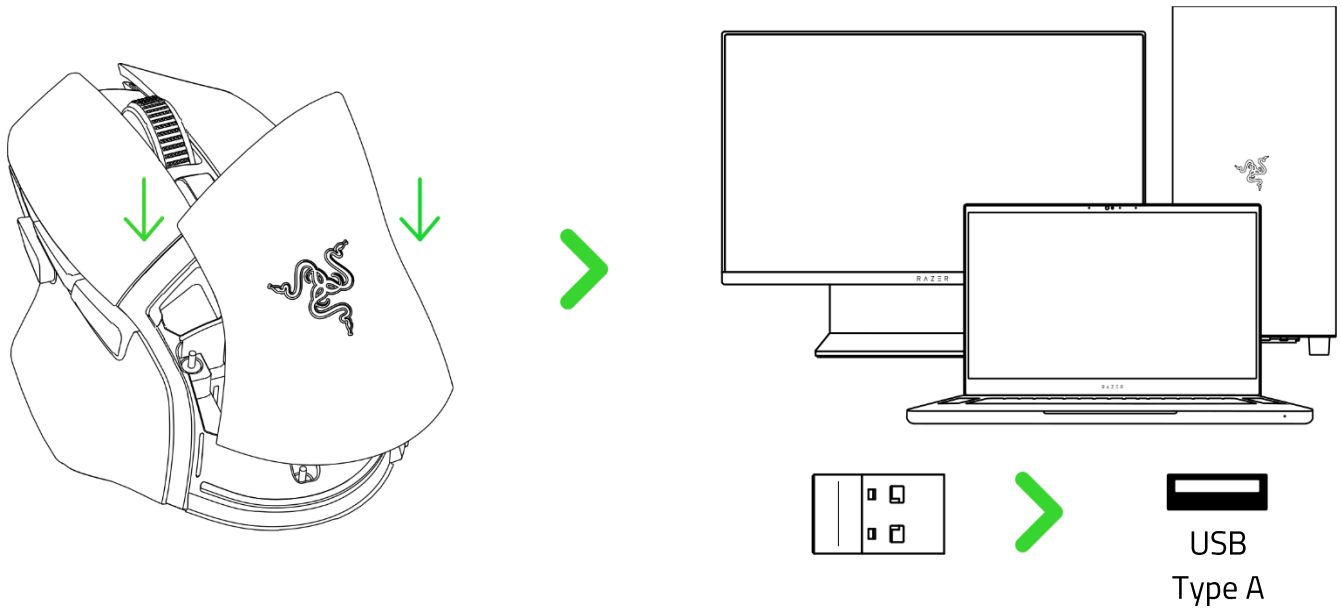

3. Push the slider switch to Razer™ HyperSpeed Wireless (2.4 GHz) mode. When connected, the scroll wheel will briefly turn static green.

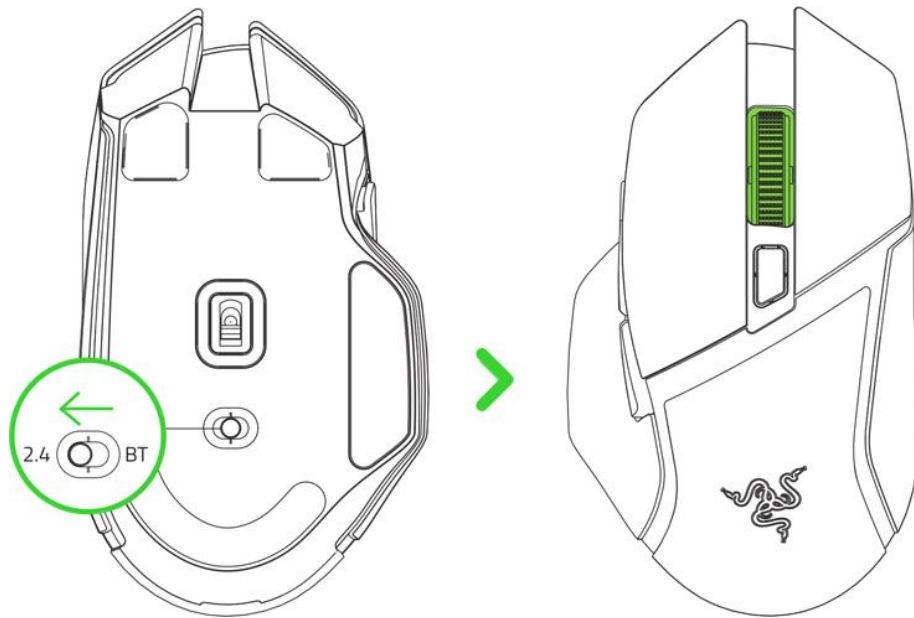

i Install Razer Synapse when prompted, or download the installer from [razer.com/synapse](https://www.razer.com/synapse)

Your Razer Basilisk V3 X HyperSpeed is now ready for use in Razer HyperSpeed Wireless (2.4 GHz) mode.

B. Via Bluetooth mode

1. Push the slider switch to Bluetooth mode (*).

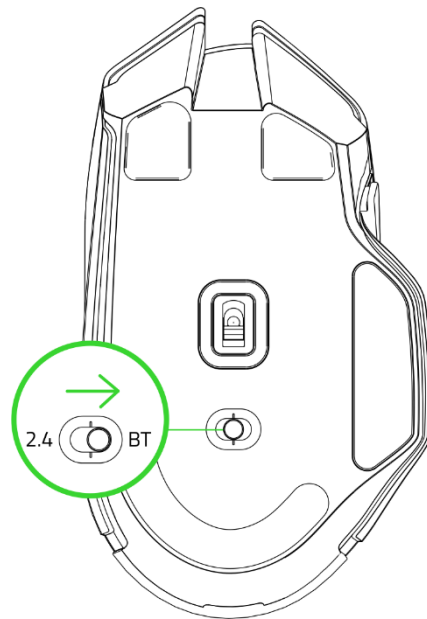

2. Press and hold the two side buttons and the DPI cycle button simultaneously for three seconds to activate pairing mode. The scroll wheel will blink twice in repeated intervals to show that the mouse is in pairing mode.

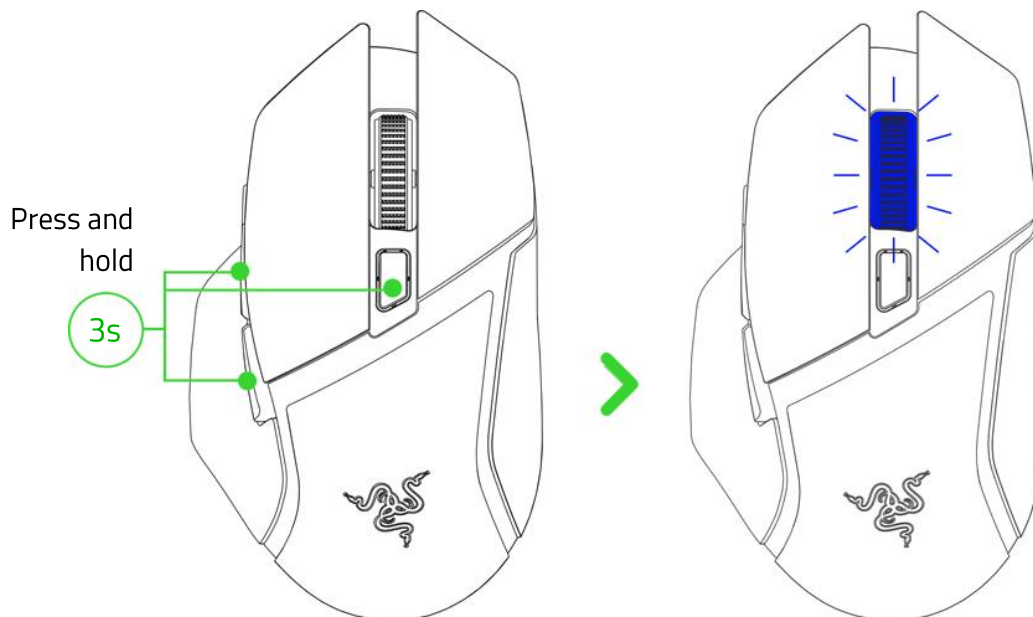

3. Activate Bluetooth on your device and select " **BSK V3 X HS**" from the list of devices found.

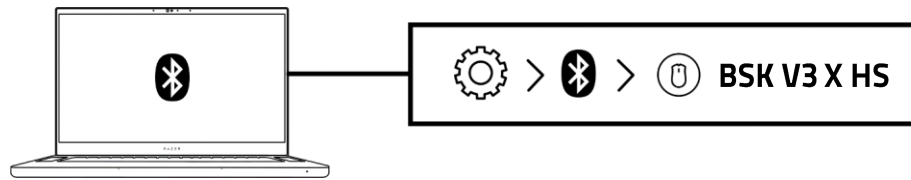

4. Wait until the mouse pairs with your device. When paired, the scroll wheel will briefly turn static blue.

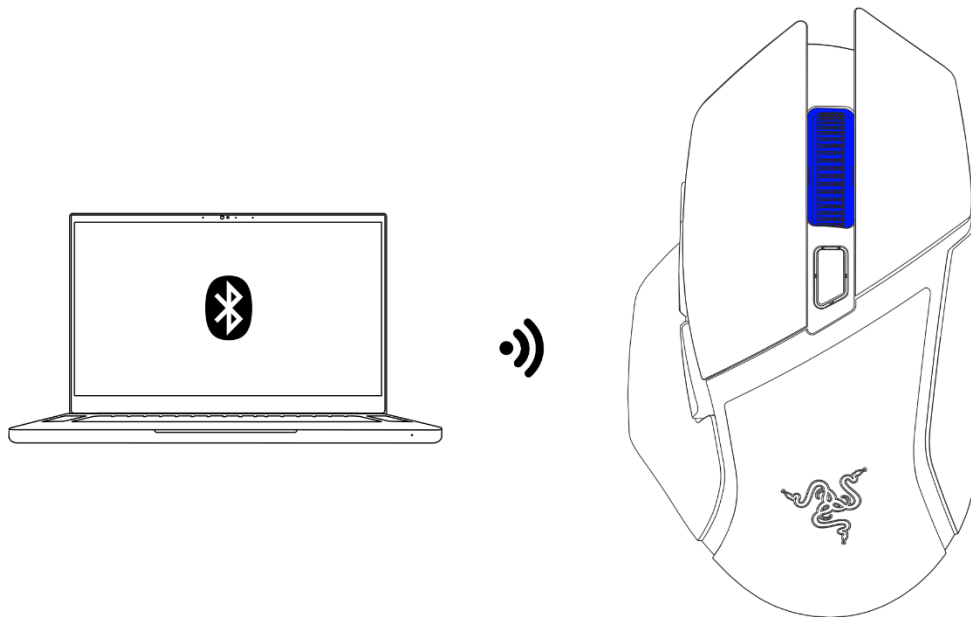

i *Once paired, your Razer Basilisk V3 X HyperSpeed will automatically reconnect to your device whenever in Bluetooth mode and within range. Keep your devices close to each other for a faster and more stable connection.*

Your Razer Basilisk V3 X HyperSpeed is now ready for use in Bluetooth mode.

6. USING YOUR RAZER BASILISK V3 X HYPERSPEED

CHANGING THE DPI

Change the mouse's DPI to match your playstyle with a press of the DPI cycle button, or fine-tune your own sensitivity setting using the Razer Synapse app. The scroll wheel will briefly change color to show which DPI stage is active.

DPI	Scroll wheel color
400	Red
800	Green
1600 (Default)	Blue
3200	Cyan
6400	Yellow

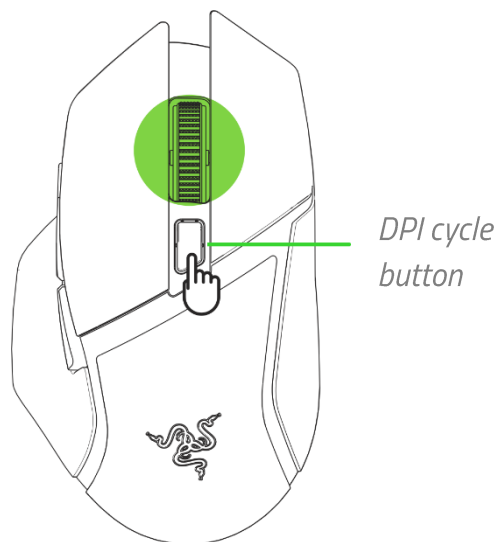

You can change your mouse's DPI to match your playstyle or re-configure the buttons and functions of your mouse using Razer Synapse

MULTI-FUNCTION TRIGGER

By default, the Multi-function trigger acts as a Hypershift modifier, allowing you to activate any of the mouse functions below when held down. [Learn more about HyperShift](#)

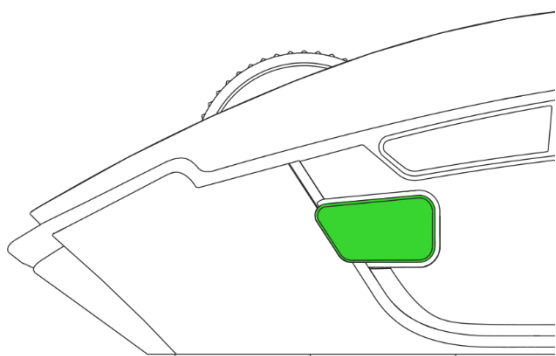

Primary functions	Razer Hypershift functions
Scroll click	Print screen
Scroll up	Scroll left
Scroll down	Scroll right
DPI cycle button	Mute or unmute audio
Mouse button 4	Minimize all windows
Mouse button 5	

7. CONFIGURING YOUR RAZER BASILISK V3 X HYPERSPEED VIA RAZER SYNAPSE

i *Internet connection is required for installation, updates, and cloud-based features. Registering for a Razer ID account is recommended but optional. All listed features are subject to change based on the current software version, the connected device(s), and supported apps and software.*

SYNAPSE TAB

The Synapse tab is your default tab when you first launch Razer Synapse. This tab allows you to navigate the Dashboard subtab.

Dashboard

The Dashboard subtab is an overview of your Razer Synapse, where you can access all your Razer devices, modules, and online services.

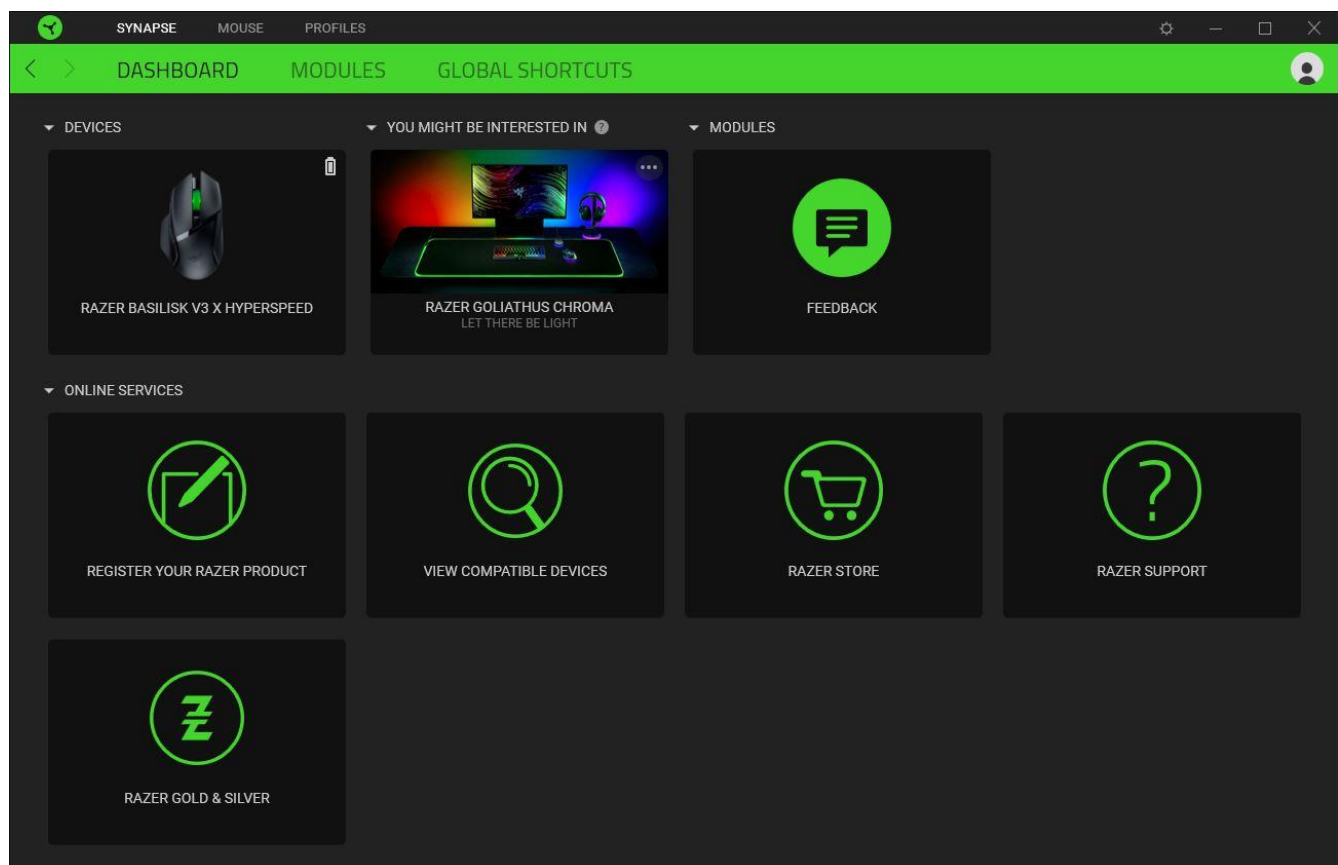

Modules

The Modules subtab displays all installed and available modules for installation.

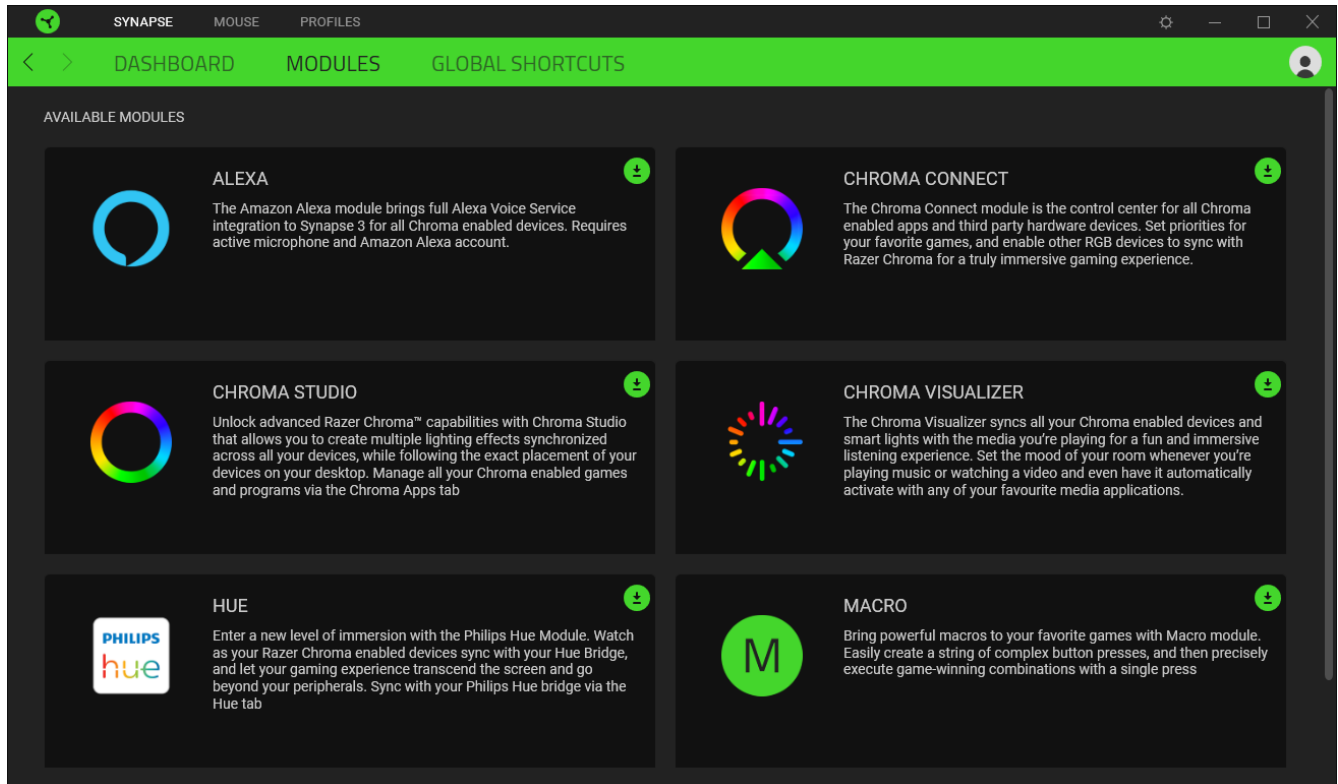

Global Shortcuts

Bind operations or Razer Synapse functions to custom key-combinations from any Razer Synapse-enabled device inputs, which apply across all device profiles. [Learn more about Profiles](#)

! *Only Razer Synapse-enabled device inputs will be recognized.*

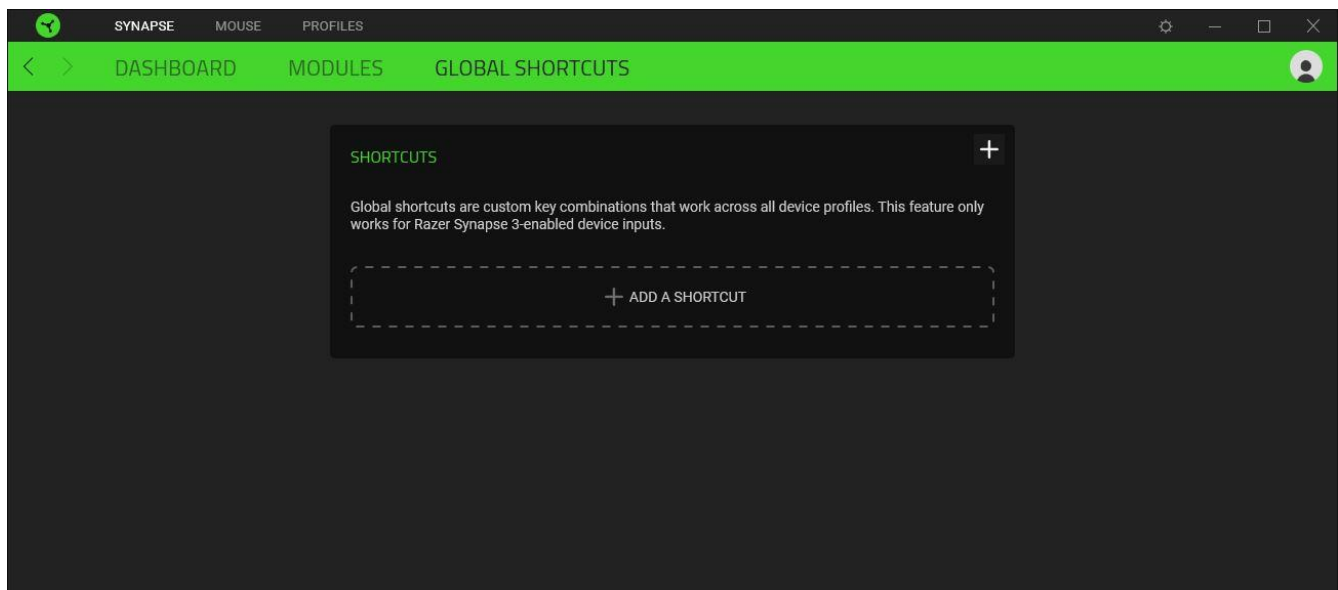

MOUSE TAB

The Mouse tab is the main tab for your Razer Basilisk V3 X HyperSpeed. From here, you can change your device's settings, such as button assignment, DPI sensitivity, and lighting. Changes under this tab are automatically saved to your system and cloud storage.

Customize

The Customize subtab is for modifying your mouse's button assignments.

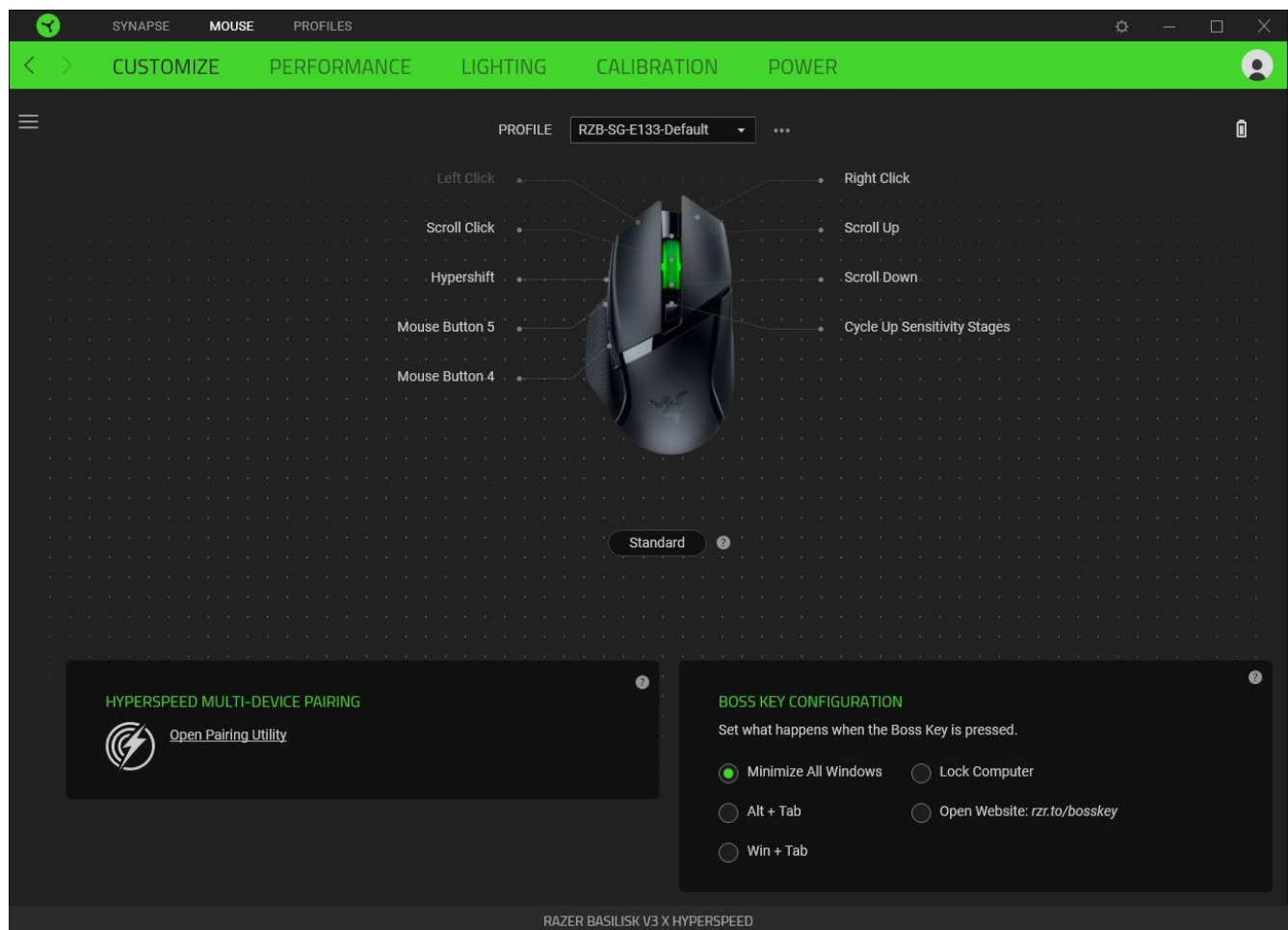

Profile

A Profile is a data storage for keeping all your Razer peripherals' settings. By default, the profile name is based on your system's name. To add, import, rename, duplicate, export, delete, or reset a profile, simply press the Miscellaneous button (●●●).

Standard / Hypershift

Hypershift mode is a secondary set of button assignments activated when the assigned Hypershift button is held down. By default, Hypershift is assigned to the Multi-function trigger of your Razer Basilisk V3 X HyperSpeed. However, you can also set any mouse button to activate Hypershift mode.

HyperSpeed Multi-Device Pairing

Use this feature to pair an additional HyperSpeed-compatible device with the wireless USB dongle of your Razer Basilisk V3 X HyperSpeed. As its wireless USB dongle can support a keyboard and mouse simultaneously, you can remove the usage of separate dongles for each peripheral.

- ! *To use this feature, your Razer Basilisk V3 X HyperSpeed must be connected via Razer HyperSpeed Wireless (2.4 GHz) mode. Each peripheral can only connect to one dongle at a time.*

Boss Key Configuration

Set your preferred function for the Boss Key shortcut when Razer Synapse is running.

- ! *Razer Synapse is required for this feature. The Boss Key configuration will revert to its default function (Minimize All Windows) when Razer Synapse is not running. By default, the Boss Key is mapped to mouse buttons 4 and 5 in HyperShift mode; however, you can also assign the Boss Key function to other mouse buttons.*

Sidebar

Clicking the Sidebar button (☰) will reveal all current button assignments for your Razer Basilisk V3 X HyperSpeed.

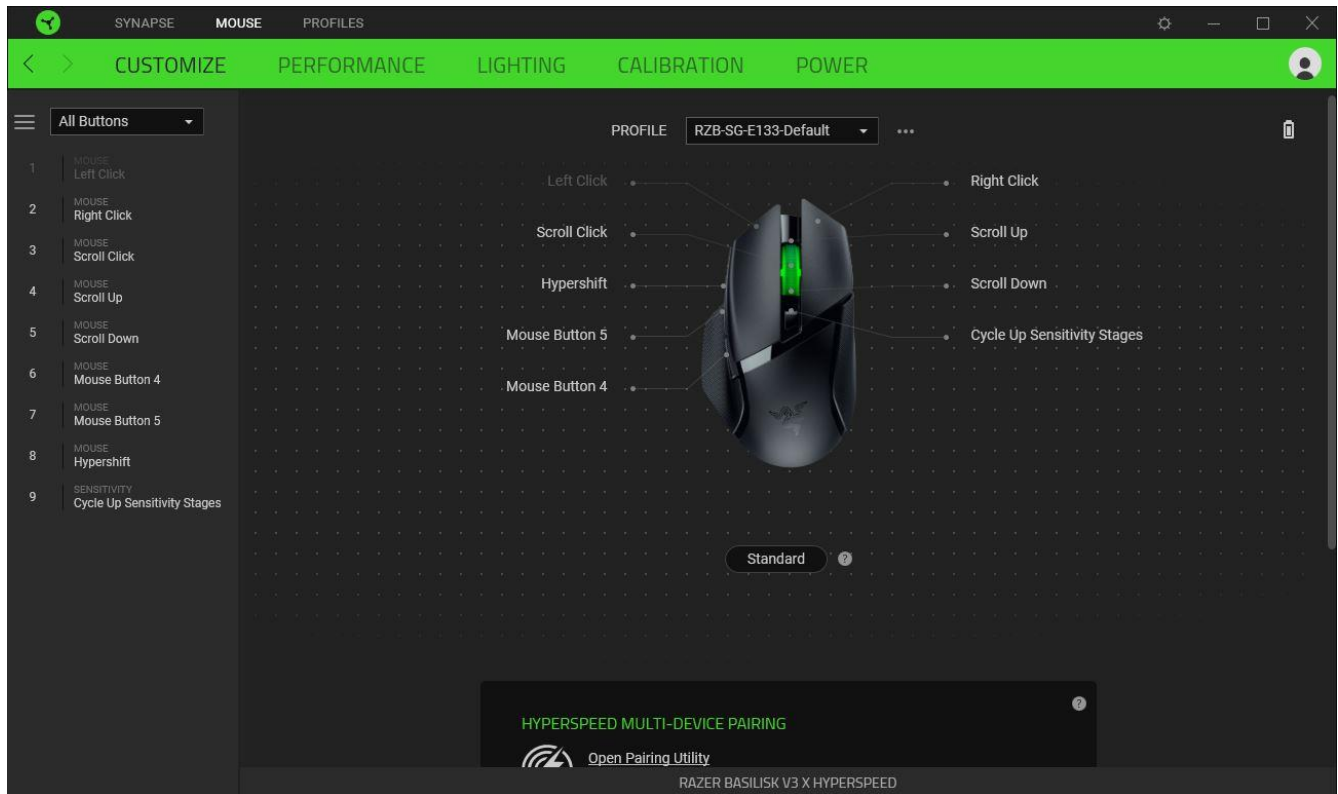

Alternatively, you can skip to a specific button assignment by selecting it on the Customize tab.

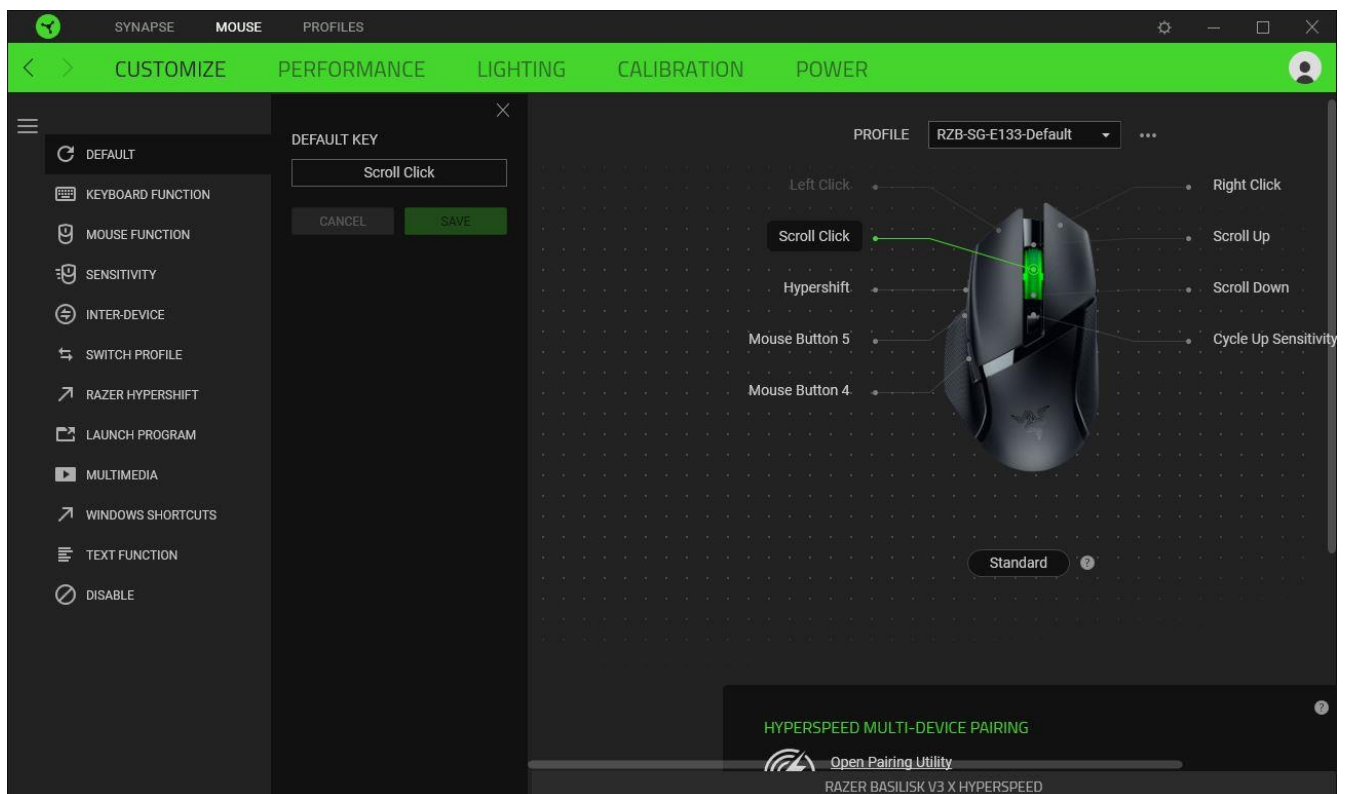

Upon selecting a button assignment, you may then change it to one of the following functions:

Default

This option enables you to return the mouse button to its original setting.

Keyboard Function

This option changes the button assignment into a keyboard function. You can also enable Turbo mode, which allows you to emulate a repeated keyboard function while the button is held down.

Mouse Function

This option substitutes the current button assignment for another mouse function. Listed below are the functions which you can choose from:

- Left Click - Performs a left mouse click using the assigned button.
- Right Click - Performs a right mouse click using the assigned button.
- Scroll Click - Activates the universal scrolling function.
- Double Click - Performs a double left click using the assigned button.
- Mouse Button 4 - Performs a "Backward" command for most internet browsers.
- Mouse Button 5 - Performs a "Forward" command for most internet browsers.
- Scroll Up - Performs a "Scroll Up" command using the assigned button.
- Scroll Down - Performs a "Scroll Down" command using the assigned button.
- Scroll Left - Performs a "Scroll Left" command using the assigned button.
- Scroll Right - Performs a "Scroll Right" command using the assigned button.
- Boss Key – Performs a "Boss Key" shortcut using the assigned button. [Learn how to configure the Boss Key](#)

You can also choose to enable Turbo mode in some of the mouse functions, which allows you to emulate repeatedly pressing and releasing said function while the button is held down.

Sensitivity

This function allows you to manipulate the DPI setting of your Razer Basilisk V3 X HyperSpeed with a touch of a button. Listed below are the Sensitivity options and their description:

- Sensitivity Clutch - Changes the sensitivity to a predefined DPI while the designated button is held down. Releasing the button will return it to the previous sensitivity.
- Sensitivity Stage Up - Increases the current sensitivity by one stage.

- Sensitivity Stage Down - Decreases the current sensitivity by one stage.
- On-The-Fly Sensitivity - Pressing the designated button and moving the scroll wheel either up or down will increase or decrease the current DPI.
- Cycle Up Sensitivity Stages - Increases the current sensitivity stage by one. Once it reaches the highest sensitivity stage, it will return to stage 1 when the button is pressed again.
- Cycle Down Sensitivity Stages - Decreases the current sensitivity stage by one. Once it reaches stage 1, it will return to the highest sensitivity stage when the button is pressed again. [Learn more about Sensitivity Stages](#)

M Macro

A Macro is a prerecorded sequence of keystrokes and button presses that is executed with precise timing. You can conveniently execute a chain of commands by setting the button function to Macro. This function will only be visible when the Macro module is installed.

↻ Inter-device

Inter-device allows you to change the functionality of other Razer Synapse-enabled devices. Some of these functionalities are device-specific such as using your Razer gaming keyboard to change the Sensitivity Stage of your Razer gaming mouse.

↔ Switch Profile

Switch Profile lets you quickly change profiles and load a new set of button assignments. An on-screen notification will appear whenever you switch profiles.

⚙️ Switch Lighting

Switch Lighting allows you to switch between all advanced lighting effects easily. This function will only be visible when the Chroma Studio module is installed.

↗️ Razer Hypershift

Setting the button to Razer Hypershift will allow you to activate Hypershift mode as long as the button is held down.

🔗 Launch Program

Launch Program lets you open an app or a website using the assigned button. When you select Launch Program, two choices will appear, which require you to search for a specific app you want to open or write the website address you want to visit.

Multimedia

This option allows you to assign multimedia controls to your Razer device. Listed below are the multimedia controls you can choose from:

- Volume Down - Decreases the audio output.
- Volume Up - Increases the audio output.
- Mute Volume - Mutes the audio.
- Mic Volume Up - Increases the microphone volume.
- Mic Volume Down - Decreases the microphone volume.
- Mute Mic - Mutes the microphone.
- Mute All - Mutes both microphone and audio output.
- Play / Pause - Play, pause, or resume playback of the current media.
- Previous Track - Play the previous media track.
- Next Track - Play the next media track.

Windows Shortcuts

This option allows you to assign your preferred button to a Windows Operating System shortcut command. For more information, please visit: support.microsoft.com/kb/126449

Text Function

Text Function enables you to type a prewritten text with a touch of a button. Simply write your desired text on the given field, and your text will be typed whenever the assigned button is pressed. This function has full Unicode support, and you can also insert special symbols from character maps.

Disable

This option renders the assigned button unusable. Use Disable if you do not want to use the selected button or if it interferes with your gaming.

Performance

The Performance subtab allows you to modify the sensitivity, acceleration, and polling rate.

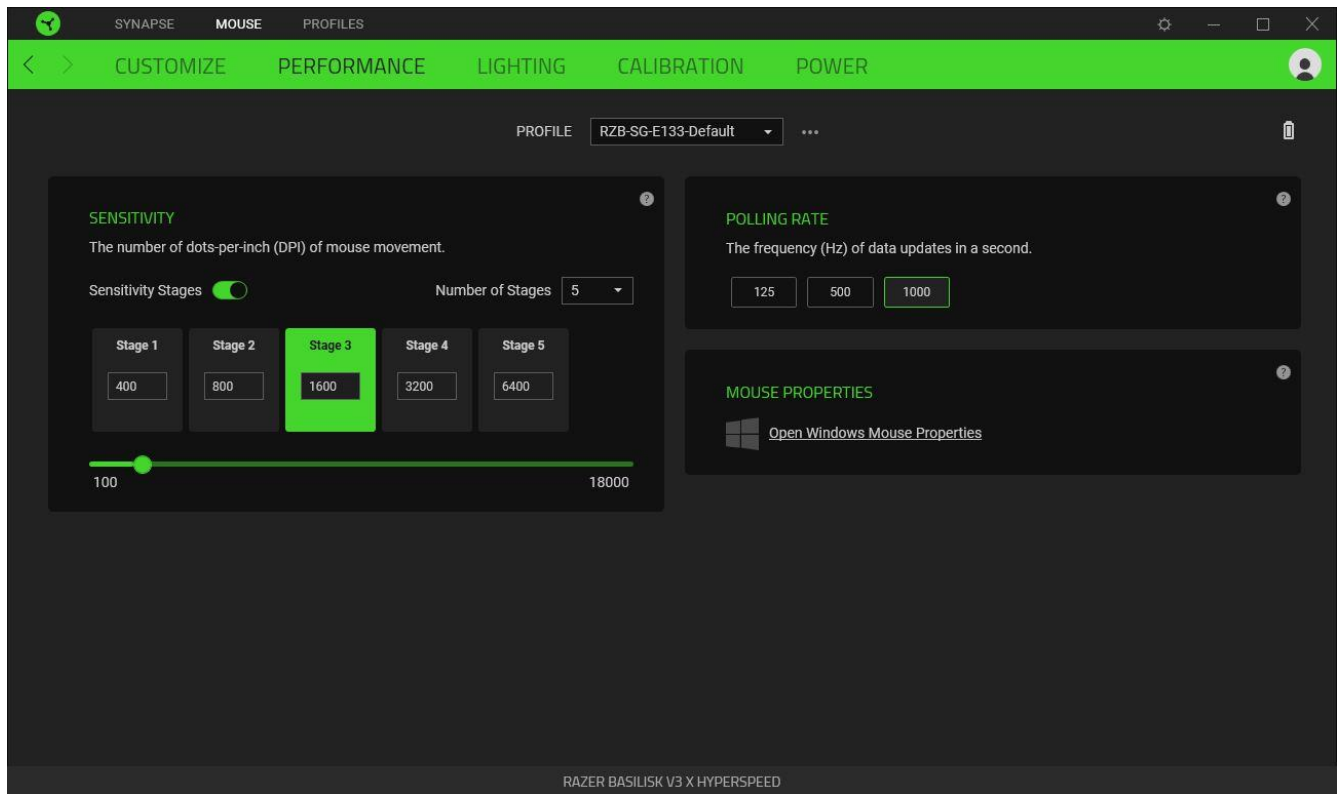

Sensitivity

Sensitivity refers to the distance the cursor will travel based on how far the mouse moves. The higher the DPI, the farther the cursor will travel, given the same mouse movement distance.

Sensitivity Stages

A sensitivity stage is a preset sensitivity value. You can create up to 5 different sensitivity stages, which you can cycle through using the DPI cycle button.

Polling Rate

The higher the polling rate, the more often the computer receives information about the status of your mouse, effectively reducing input latency and improving your mouse pointer's reaction time. You can switch between 125Hz, 500Hz, and 1000Hz by selecting your desired polling rate from the options provided.

Mouse Properties

Access the Windows Mouse Properties, where you can modify operating system settings that directly affect your mouse.

Lighting

The Lighting subtab enables you to modify your Razer device's light settings.

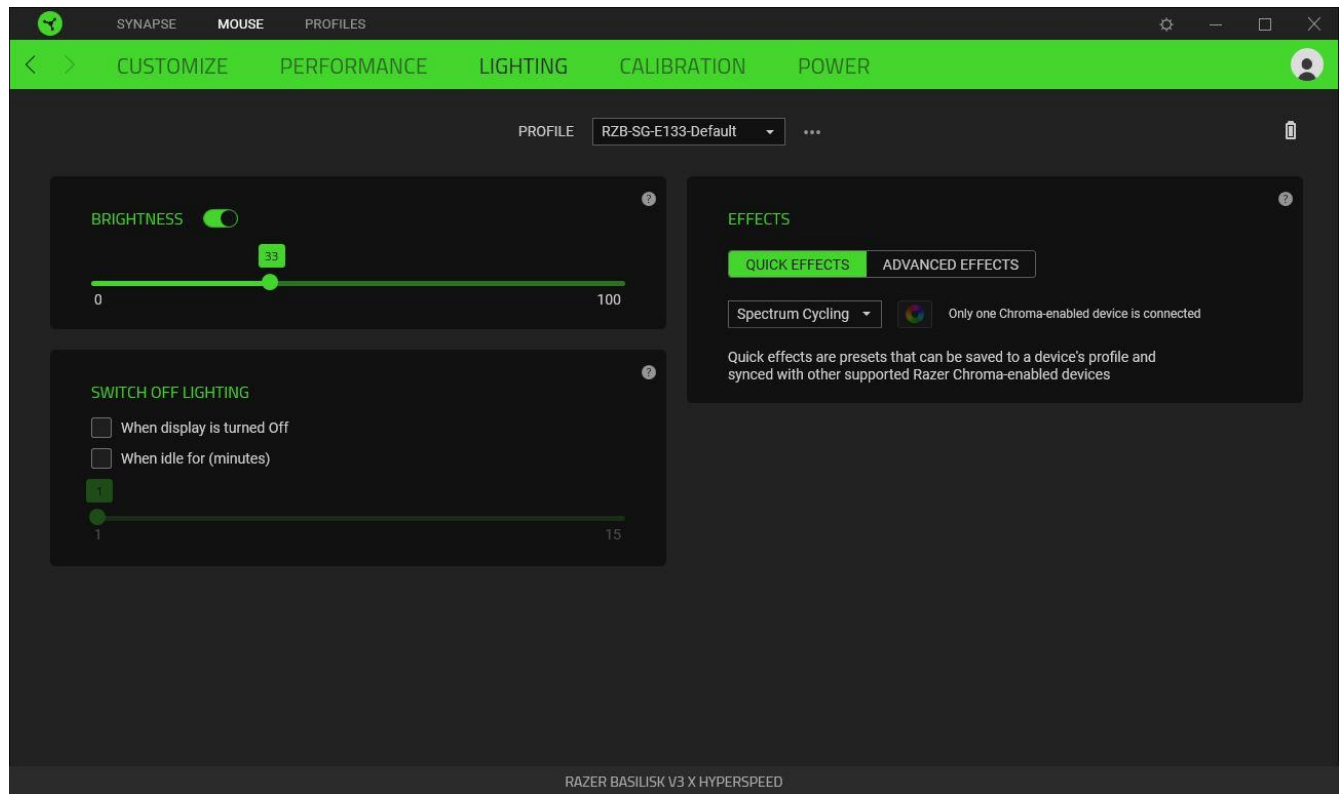

Brightness

You can turn off your Razer device's lighting by toggling the Brightness option or increase/decrease the luminance using the slider.





Switch Off Lighting

This power-saving tool allows you to disable your device's lighting in response to your system's display turning off and/or automatically power down when your Razer Basilisk V3 X HyperSpeed has been idle for a set time.

Quick effects

Several quick effects can be selected and applied to your mouse's lighting, as listed here:

	Name	Description	How to set up
	Audio meter	The scroll wheel will light up according to the audio level with a default spectrum of colors	Select a Color Boost level

	Breathing	The lighting will fade in and out of the selected color(s)	Select up to 2 colors or randomize colors
	Reactive	The scroll wheel will light up when you click any of the mouse buttons	Select a color and a duration
	Spectrum cycling	The lighting will cycle between 16.8 million colors indefinitely	No further customization required
	Static	The scroll wheel will remain lit in the selected color	Select a color

If you have other supported Razer Chroma-enabled devices, you can synchronize their quick effects with your Razer device by clicking the Chroma Sync button ().

 *Only devices that support the selected lighting effect will synchronize.*

Advanced Effects

The Advanced Effects option allows you to choose a Chroma Effect you want to use on your Razer Chroma-enabled peripheral. To start making your own Chroma Effect, simply press the Chroma Studio button ().

Calibration

The Calibration subtab allows you to optimize the sensor of your Razer mouse to any surface for better tracking.

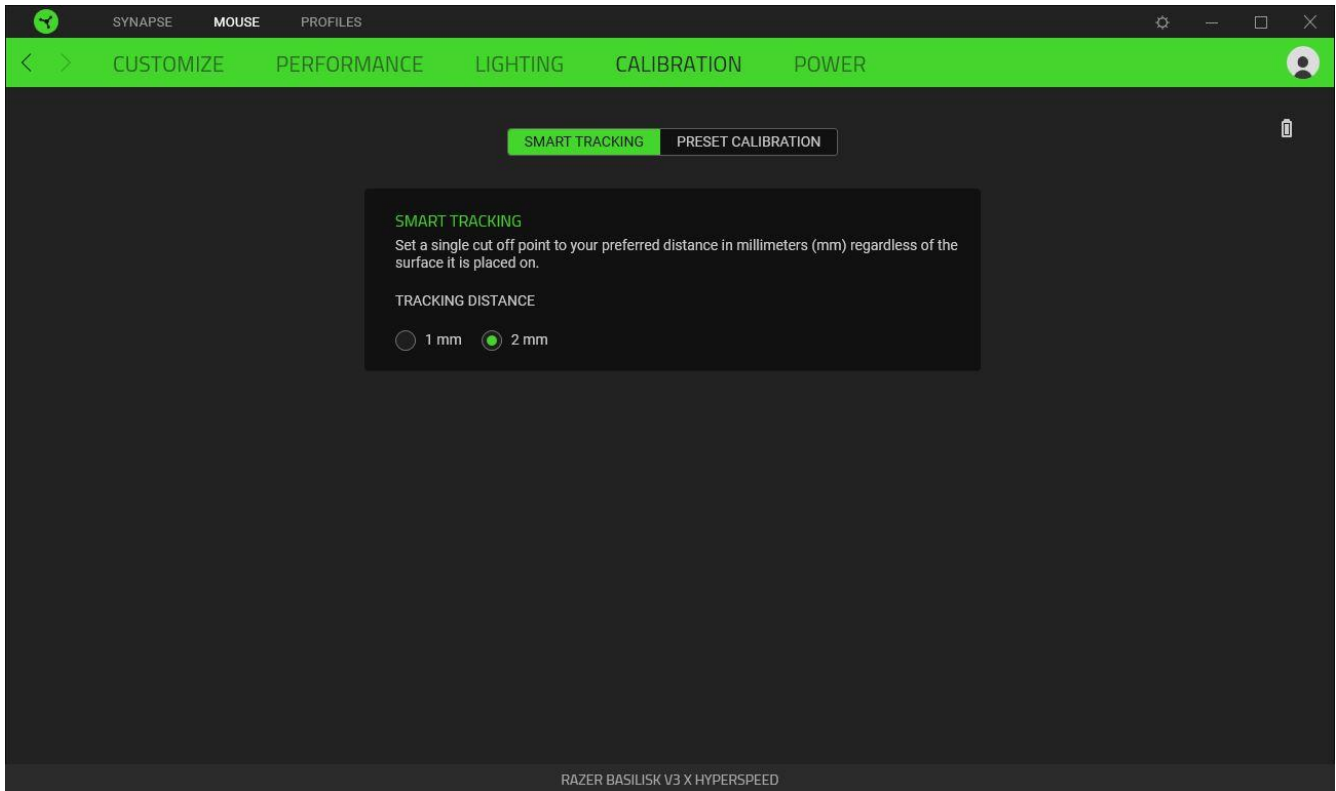

Smart Tracking

Set the distance the sensor stops tracking when it is lifted from its surface to avoid unwanted cursor movement.

Preset Calibration

Calibrate the Razer mouse to optimize its sensor on supported Razer mouse mats. To use this feature, you must click the **Add A Surface** option, where you can select from a comprehensive list of Razer mouse mats.

Power

The Power subtab allows you to set your mouse to enter sleep mode when it has been idle for a certain amount of time.

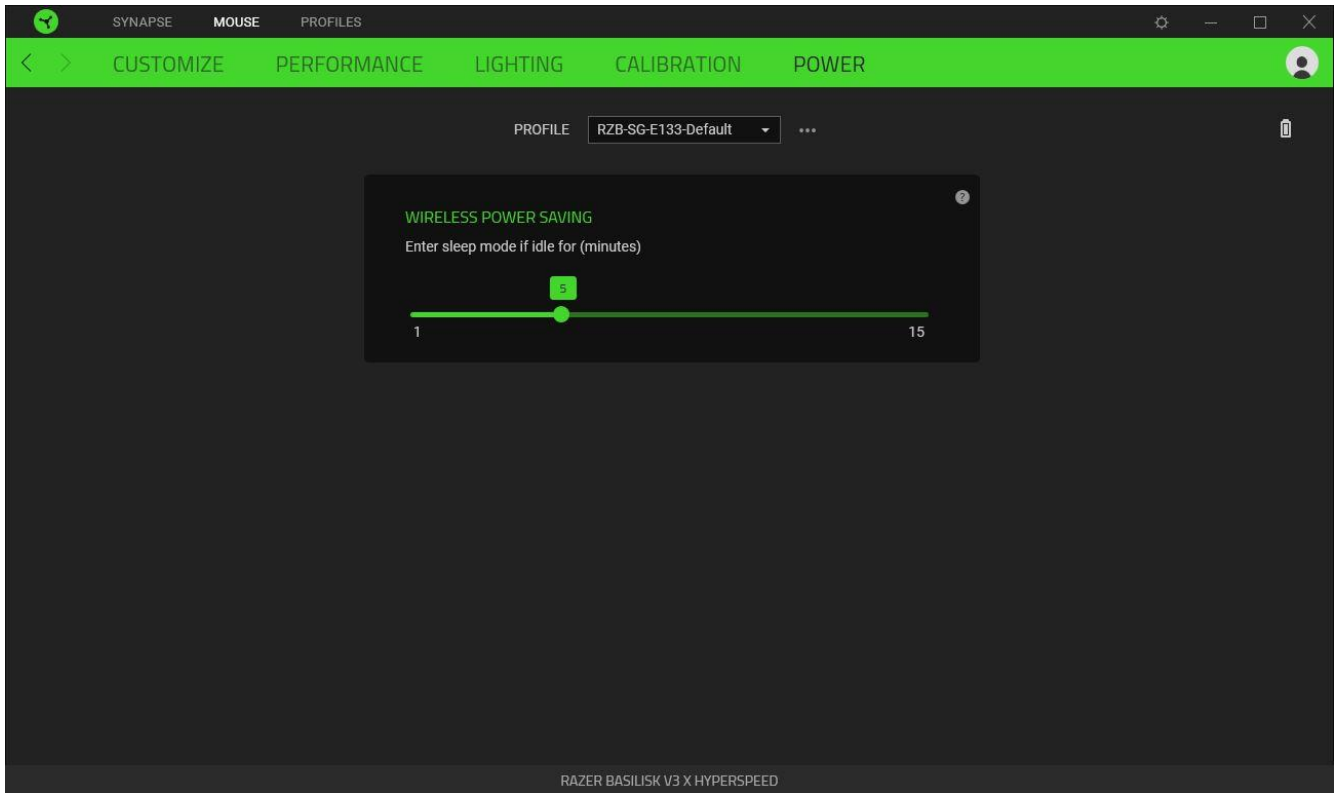



PROFILES TAB

The Profiles tab is a convenient way to manage all your profiles and link them to your games and applications.

Devices

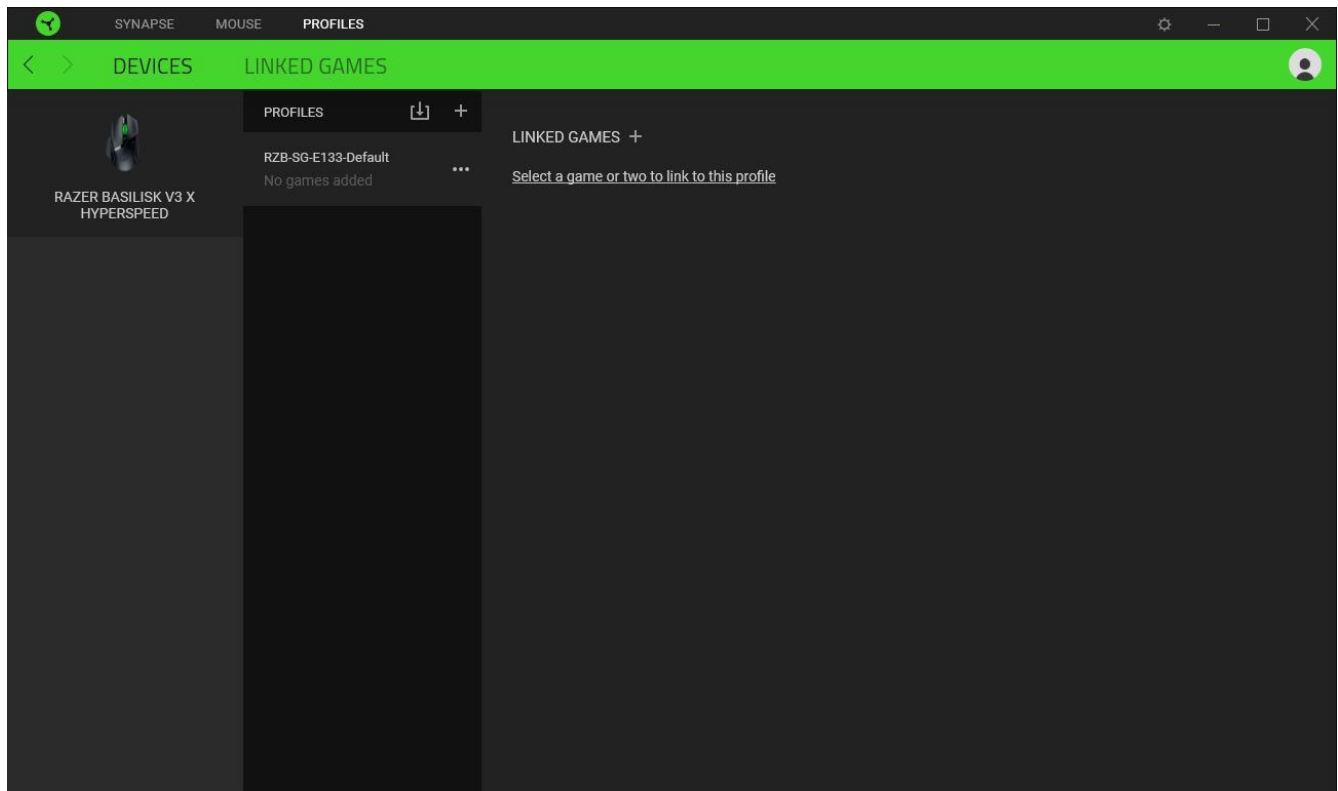
View which games are linked to each device's profiles or which Chroma Effect is linked to specific games using the Devices subtab.

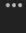

You can import Profiles from your computer or the cloud through the import button () or create new profiles within the selected device using the add button (). To rename, duplicate, export, or delete a profile, simply press the Miscellaneous button (). Each profile can be set to activate when you run an application using the Linked Games option.

Linked Games

The Linked Games subtab allows you to add games, view devices linked to games, or search for added games. You can also sort games based on alphabetical order, last played, or most played. Added games will still be listed here, even if they are not linked to a Razer device.

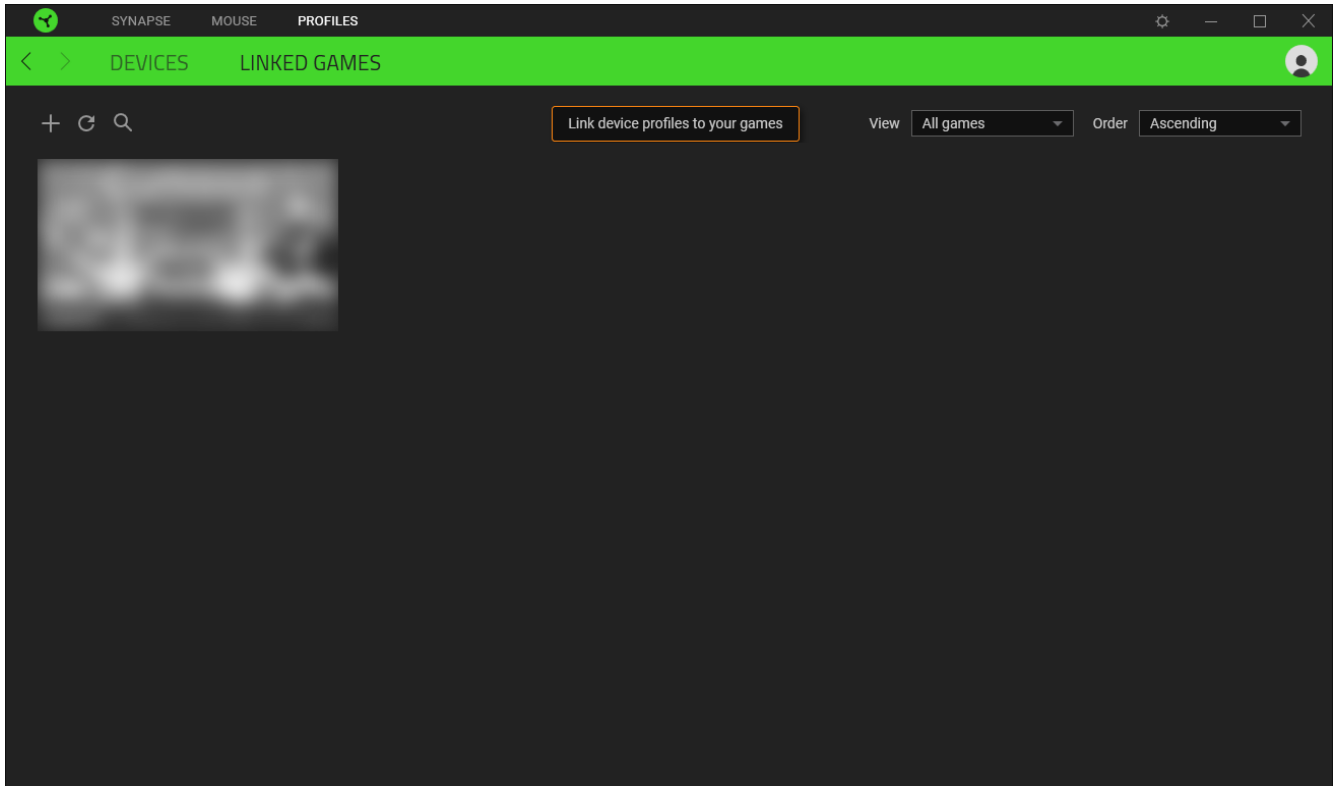

To link games to connected Razer devices or Chroma Effects, simply click on any game from the list, and then click **Select a device and its profile to launch automatically during gameplay** to select the Razer device or Chroma Effect it will link with. Once connected, you may click the Miscellaneous button (●●●) of the corresponding Chroma Effect or device to select a specific Chroma Effect or profile.

SETTINGS WINDOW

The Settings window, accessible by clicking the (⚙️) button on Razer Synapse, enables you to configure the startup behavior and display language of Razer Synapse, view the master guides of each connected Razer device or perform a factory reset on any connected Razer device.

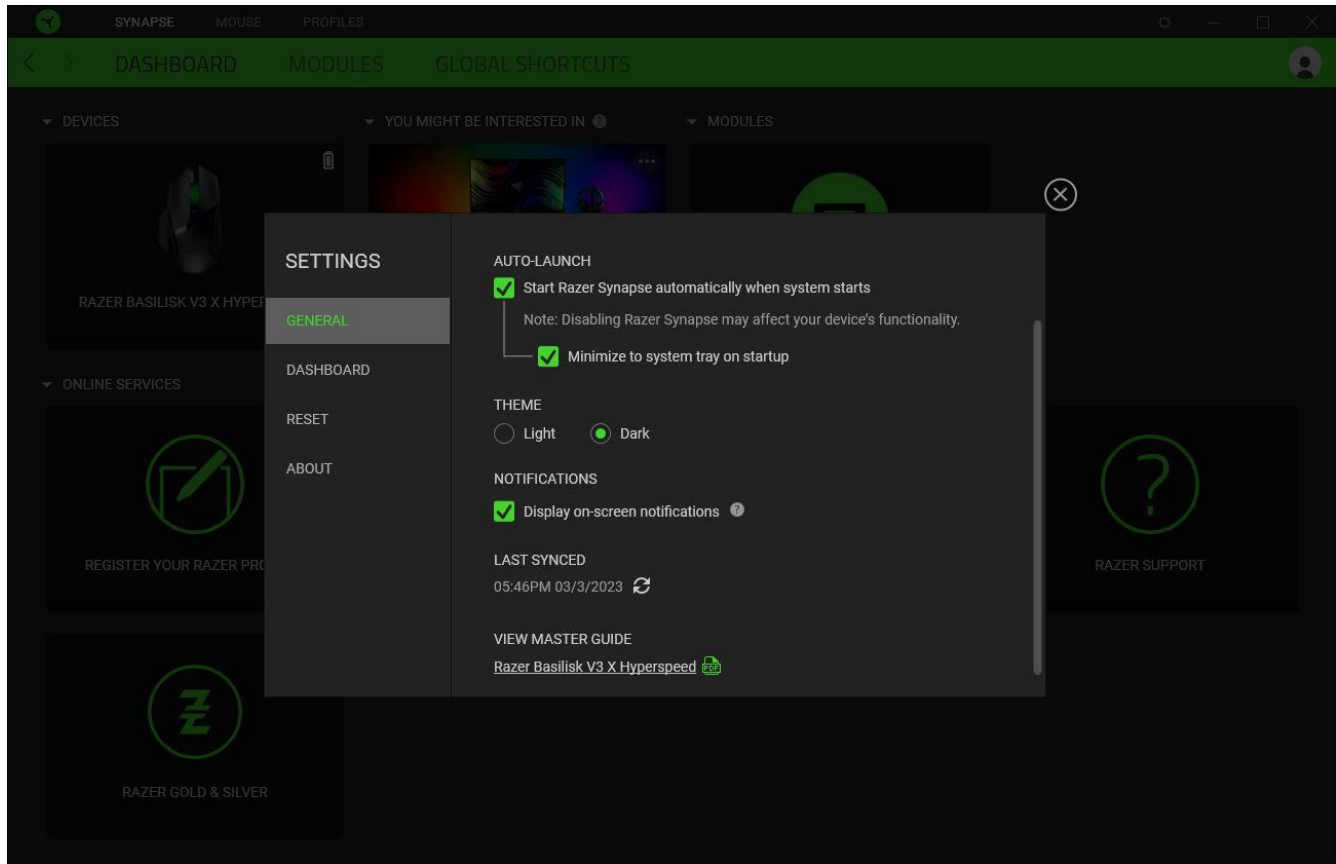

General tab

The General tab lets you change the software's display language, startup behavior, theme, and on-screen notifications display. You may also manually sync your profiles to the cloud (↻) or view the master guide of all connected Razer devices and installed modules.

Dashboard tab

Use the Dashboard tab to customize which Razer device recommendations based on your setup, and the games you play will appear on the Dashboard.

Reset tab

The Reset tab allows you to perform a factory reset on all connected Razer devices with on-board memory and/or reset Razer Synapse tutorials to acquaint yourself again with Razer Synapse's new features on its next launch.

 *All profiles stored on the selected device's on-board memory will be erased when you reset a Razer device.*

About tab

The About tab displays brief software information and copyright statement, and provides relevant links for its terms of use. You may also use this tab to check for software updates, or as quick access to Razer's social communities.

8. SAFETY AND MAINTENANCE

SAFETY GUIDELINES

To achieve maximum safety while using your Razer Basilisk V3 X HyperSpeed, we suggest that you adopt the following guidelines:

Should you have trouble operating the device properly and troubleshooting does not work, unplug the device and contact the Razer hotline or go to support.razer.com for support.

Do not take apart the device, and do not attempt to operate it under abnormal current loads. Doing so will void your warranty.

Keep the mouse's accessories out of the reach of small children to avoid accidents and/or injuries.

Keep the device away from liquid, humidity, or moisture. Operate the device only within the specific temperature range of 0°C (32°F) to 40°C (104°F). Should the temperature exceed this range, unplug and/or switch off the device to stabilize the temperature to an optimal level.

COMFORT

Research has shown that long periods of repetitive motion, improper positioning of your computer peripherals, incorrect body position, and poor habits may be associated with physical discomfort and injury to nerves, tendons, and muscles. Below are some guidelines to avoid injury and ensure optimum comfort while using your Razer Basilisk V3 X HyperSpeed.

- Position your keyboard and monitor directly in front of you with your mouse next to it. Place your elbows next to your side, not too far away, and your keyboard within easy reach.
- Adjust the height of your chair and table so that the keyboard and mouse are at or below elbow-height.
- Keep your feet well supported, posture straight and your shoulders relaxed.
- During gameplay, relax your wrist and keep it straight. If you do the same tasks with your hands repeatedly, try not to bend, extend or twist your hands for long periods.
- Do not rest your wrists on hard surfaces for long periods. Use a wrist rest to support your wrist while gaming.
- Do not sit in the same position all day. Get up, step away from your desk and do exercises to stretch your arms, shoulders, neck, and legs.

If you experience any physical discomfort while using your mouse, such as pain, numbness, or tingling in your hands, wrists, elbows, shoulders, neck, or back, please consult a qualified medical doctor immediately.

MAINTENANCE AND USE

The Razer Basilisk V3 X HyperSpeed requires minimum maintenance to keep it in optimum condition. Once a month, we recommend you clean the device using a soft cloth or cotton swab to prevent dirt buildup. Do not use soap or harsh cleaning agents.

To get the ultimate experience in movement and control, we highly recommend a premium mouse mat from Razer. Some surfaces will cause undue wear on the feet requiring constant care and eventual replacement.

Do note that the sensor of the Razer Basilisk V3 X HyperSpeed is 'tuned' or optimized, especially for the Razer mouse mats. This means that the sensor has been tested extensively to confirm that the Razer Basilisk V3 X HyperSpeed reads and tracks best on Razer mouse mats.

9. LEGALESE

COPYRIGHT AND INTELLECTUAL PROPERTY INFORMATION

©2023 Razer Inc. All rights reserved. Razer, the triple-headed snake logo, Razer logo, "For Gamers. By Gamers.", and "Razer Chroma" logo are trademarks or registered trademarks of Razer Inc. or affiliated companies in the United States and other countries. All other trademarks are the property of their respective owners.

The Bluetooth® word mark and logos are registered trademarks owned by Bluetooth SIG, Inc., and any use of such marks by Razer is under license.

Windows and the Windows logo are trademarks of the Microsoft group of companies.

Razer Inc. ("Razer") may have copyright, trademarks, trade secrets, patents, patent applications, or other intellectual property rights (whether registered or unregistered) concerning the product in this guide. Furnishing of this guide does not give you a license to any such copyright, trademark, patent or other intellectual property right. The Razer Basilisk V3 X HyperSpeed (the "Product") may differ from pictures, whether on packaging or otherwise. Razer assumes no responsibility for such differences or for any errors that may appear. Information contained herein is subject to change without notice.

LIMITED PRODUCT WARRANTY

For the latest and current terms of the Limited Product Warranty, please visit [razer.com/warranty](https://www.razer.com/warranty).

LIMITATION OF LIABILITY

Razer shall in no event be liable for any lost profits, loss of information or data, special, incidental, indirect, punitive or consequential or incidental damages, arising in any way out of distribution of, sale of, resale of, use of, or inability to use the Product. In no event shall Razer's liability exceed the retail purchase price of the Product.

GENERAL

These terms shall be governed by and construed under the laws of the jurisdiction in which the Product was purchased. If any term herein is held to be invalid or unenforceable, then such term (in so far as it is invalid or unenforceable) shall be given no effect and deemed to be excluded without invalidating any of the remaining terms. Razer reserves the right to amend any term at any time without notice.