

# NV7

## USER MANUAL



THANK YOU FOR CHOOSING

---

***PHANTEKS***

■ 1. INTRODUCTION

Introduction	5
D-RGB Lighting Effects	6
Exploded View	7
Accessories	8
Specifications	9

Move Front I/O To Secondary Position	23
D-RGB Cables	24
Installing Storage	25
Internal Cable Management	27
Installing LED Covers	28
Installing GPU Support Bracket	30
External Cable Management	31

■ 2. BUILD YOUR SETUP

Remove External Panels	10
Remove Covers	12
Motherboard Installation	13
Power Supply Installation	14
Fan & Radiator Positions	15
Fan & Radiator Installation	16
Airflow Configurations	20
Power Button & LED	21
Front I/O	22

■ 3. SUPPORT

Contact Us	32
Warranty	33

INTRODUCING THE PHANTEKS NV7

The Phanteks NV7 is a showcase full-tower chassis with a clean look from every side. It is the first installment of the new NV series, which is focused on showcasing your hardware in a premium build-quality chassis. Performance is uncompromised with Ultra-Fine Mesh panels while providing a clean and stylish look with the nearly seamless tempered glass front and left side panels.

THE PHANTEKS TEAM

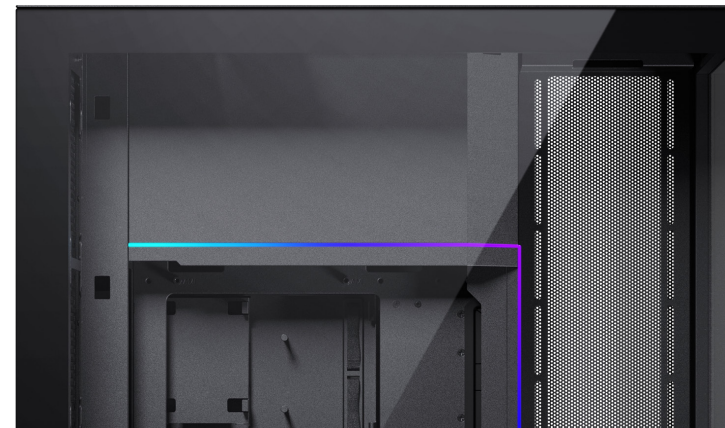

## LIGHTING EFFECTS

The Digital-RGB lighting can be easily controlled with the 4 buttons on top of the chassis:

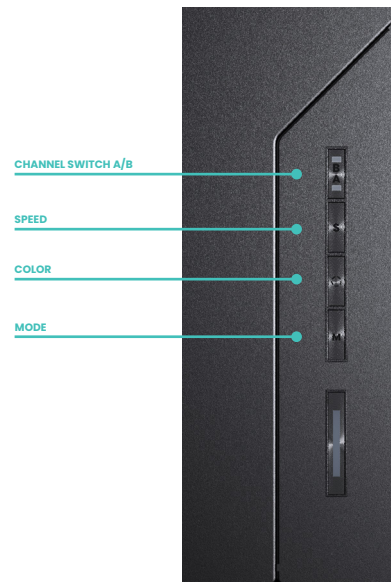

### MODES

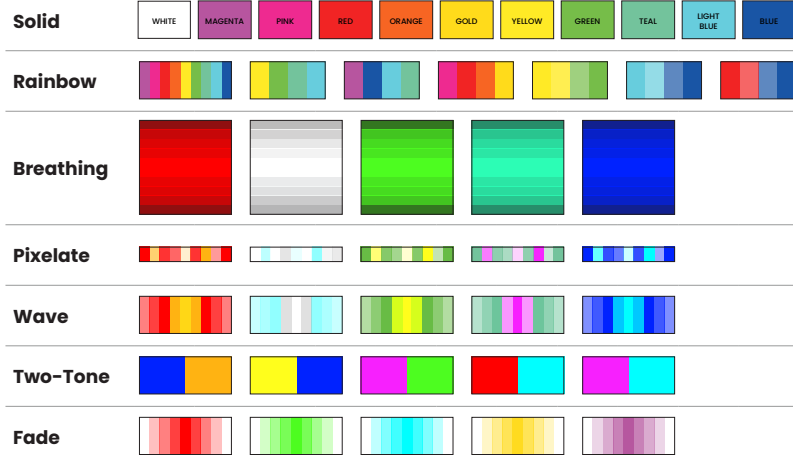

TURN OFF LEDs

**(M)** Press and hold the MODE button for two seconds to turn off LEDs, press again to turn it ON

NV7

## EXPLODED VIEW

### PARTS

- 1 Chassis
- 2 Front glass panel
- 3 Right side mesh panel
- 4 Left glass panel
- 5 Top panel
- 6 Bottom fan bracket
- 7 Side fan bracket
- 8 Rear door
- 9 Bottom dust filter
- 10 Front I/O
- 11 GPU Support Bracket
- 12 Motherboard Cover
- 13 D-RGB Cover
- 14 Top I/O
- 15 Rear Mesh Cover
- 16 Airflow Cover

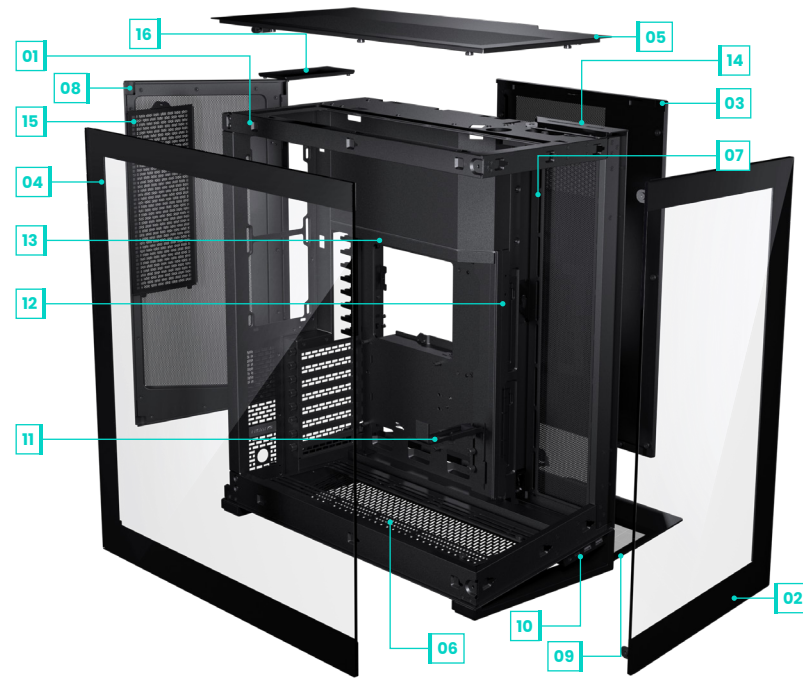

NV7

## GPU SUPPORT BRACKET

Included in accessory box



## AIRFLOW COVER

2x Included in accessory box

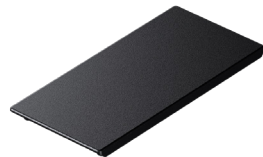

## SCREWS

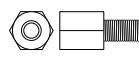
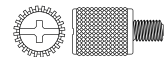
SSD + MOTHERBOARD  
SCREW  
34XMOTHERBOARD  
STAND-OFF  
1XANTI-SAG BRACKET  
THUMB SCREW  
4XEXTRA RIGHT SIDE  
PANEL SCREW  
1XPSU SCREW  
34XHDD LOCKING SCREW  
9XSTAND-OFF REMOVAL  
TOOL  
1X

## OTHER ACCESSORIES

- 1x D-RGB Motherboard adapter cable
- 1x Microfiber Cloth
- 6x Zipties
- 1x Manual

## CASE SPECIFICATIONS

<b>Dimension (DxWxH)</b>	532 x 253 x 586 mm / 20.9 x 10.0 x 23.1 in
<b>Form Factor</b>	Full Tower
<b>Materials</b>	Steel, Tempered Glass front and side panels
<b>Motherboard Support</b>	ATX, micro-ATX, mini-ITX, E-ATX (up to 277 mm wide), SSI-CEB (up to 290 mm w/o cover)
<b>Front I/O</b>	Power switch, 1x USB 3.2 Gen2 Type-C, 2x USB 3.0, D-RGB Mode, D-RGB Color, D-RGB Speed, D-RGB Channel, Microphone/Headphone

## PCI SLOTS &amp; DRIVE BAYS

<b>PCI Slots</b>	8x
<b>Internal 2.5"</b>	6x
<b>Internal 3.5"</b>	2x
<b>FAN</b>	<b>120mm</b> <b>140mm</b>
<b>Side</b>	4x                                      -
<b>Top</b>	3x                                      -
<b>Bottom</b>	3x                                      3x
<b>Rear</b>	2x                                      -
<b>RADIATOR</b>	<b>120mm</b> <b>140mm</b>
<b>Side</b>	up to 360                              -
<b>Top</b>	up to 360                              -
<b>Bottom</b>	up to 360                              up to 280
<b>Rear</b>	up to 240                              -

## INCLUDED ACCESSORIES

<b>GPU Support Bracket</b>	1x
<b>Airflow Cover</b>	2x
<b>Toolbox</b>	1x
<b>CLEARANCE</b>	
<b>GPU Length</b>	450 mm / 17.7 in
<b>CPU Cooler Height</b>	185 mm / 7.3 in
<b>PSU Length</b>	255 mm / 10.0 in
<b>Side 360 Radiator</b>	Maximum size: 132 x 440 mm
<b>Side 360 Radiator Thickness</b>	65 mm (to GPU)
<b>Top 360 Radiator</b>	Maximum size: 132 x 440 mm
<b>Rear 240 Radiator</b>	Maximum size: 132 x 320 mm

## REMOVE EXTERNAL PANELS

NV7

### 01 OPEN REAR PANEL



Open the rear door by pulling it from the bottom right corner.

### 02 REMOVE GLASS SIDE PANEL

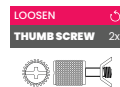

Loosen the 2 thumb screws in the rear, slide the glass side panel to the rear and tilt it sideways to remove it.

### 03 REMOVE GLASS FRONT PANEL



Unscrew the 2 screws from the left side and slide the panel to the left to remove it. Optionally, this panel can be left on during installation.

## REMOVE EXTERNAL PANELS

NV7

### 04 REMOVE TOP PANEL

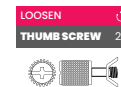

Loosen the 2 thumb screws of the top panel in the rear. Slide the top panel to the rear to remove it.

### 05 REMOVE RIGHT SIDE PANEL



Remove the screw on the top and slide the right panel upwards to remove it.

### 06 REMOVE REAR DOOR



Optionally, remove the back door by sliding it upwards when it is in open position.

## 01 REMOVE D-RGB COVER

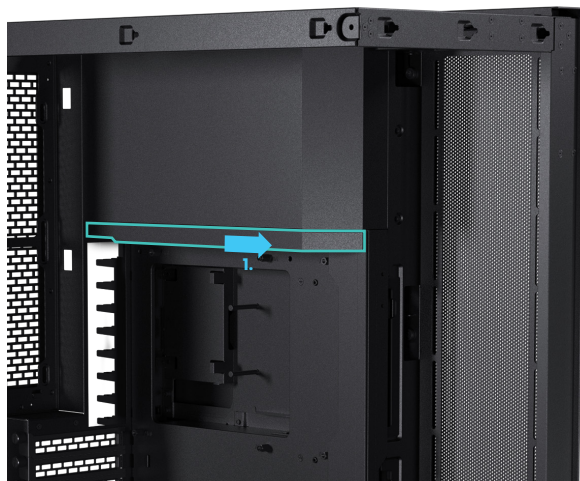

Slide the D-RGB cover to the front of the chassis to remove it.

## 02 REMOVE MOTHERBOARD COVER

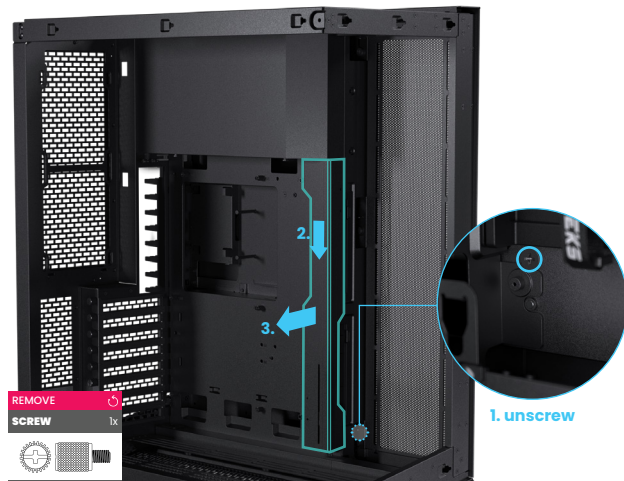

Remove the screw located on the right side of the chassis. Push the motherboard cover down to remove it.



INSTALL  
MB SCREWS 9x

## 01 ALIGN MOTHERBOARD

Align the motherboard with the screwholes on the chassis' motherboard tray.

## 02 SECURE MOTHERBOARD

Secure the motherboard with 9x motherboard screws.

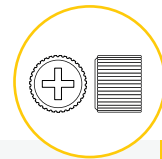

### PRO TIP

Use the included stand-off tool to easily remove and re-install the motherboard stand-offs for other motherboard form-factors



### ATTENTION

For Micro-ATX and SSI-CEB check the motherboard instructions for stand-off locations.

## POWER SUPPLY INSTALLATION

### 01 INSERT PSU

Insert the PSU from the right side of the chassis.

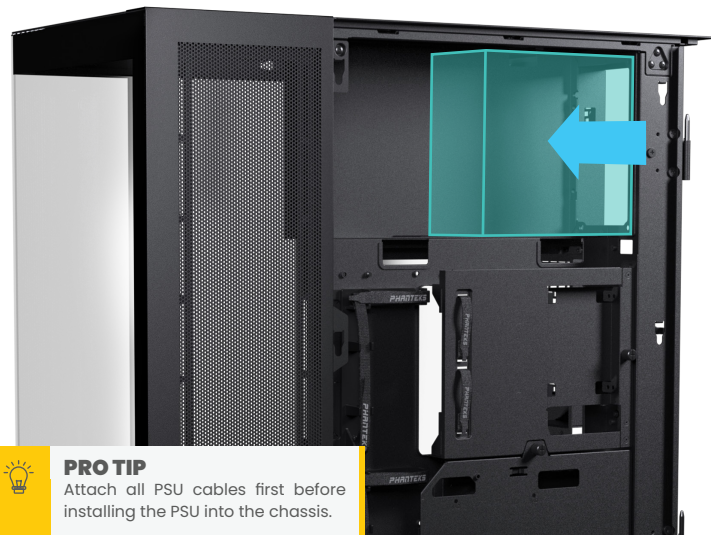

## NV7

### 02 SECURE PSU

Secure the PSU from the rear with 4x PSU screws.



## RADIATOR & FAN POSITIONS

### RADIATOR POSITIONS

Side: up to 360

Top: up to 360

Bottom: up to 360/280

Rear: up to 240

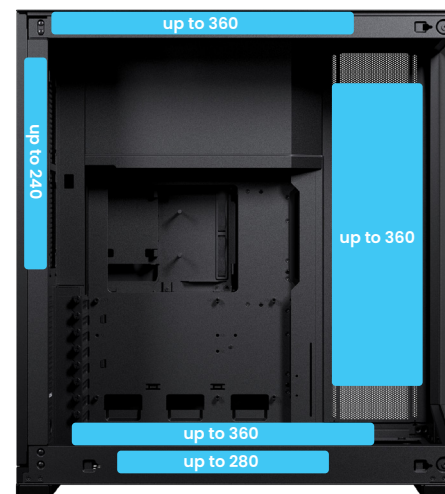

### FAN POSITIONS

Side: 4x 120 mm

Top: 3x 120 mm

Bottom: 3x 120/140 mm

Rear: 2x 120 mm

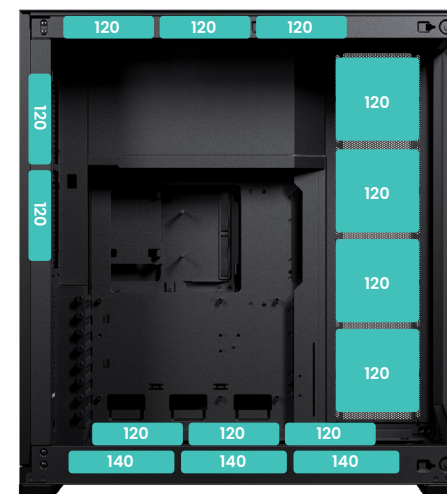

## NV7



## AIR-COOLED CONFIGURATION

Side: Intake      Top: Exhaust  
 Bottom: Intake      Rear: Exhaust

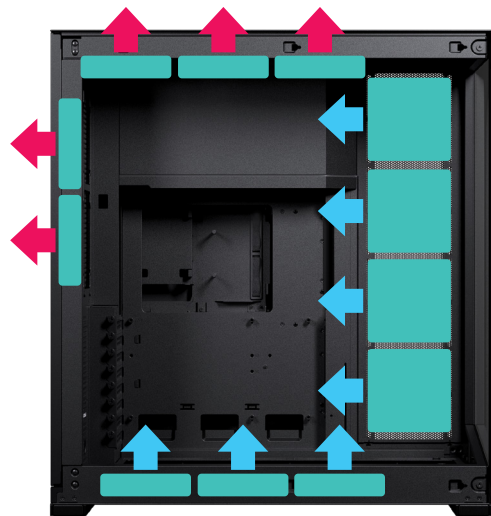

## WATER COOLED CONFIGURATION

Side: Exhaust      Top: Exhaust  
 Bottom: Intake      Rear: Exhaust

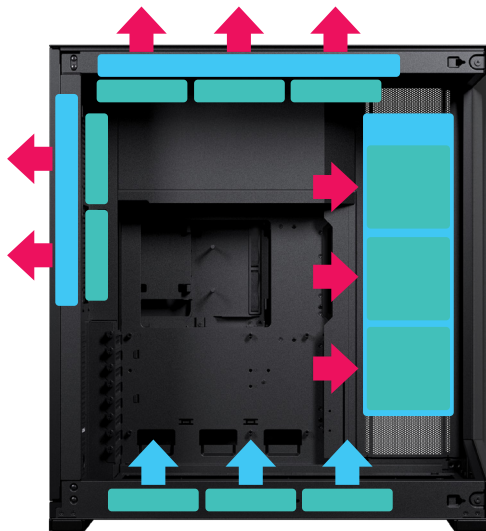

## SIDE FAN/RADIATOR BRACKET

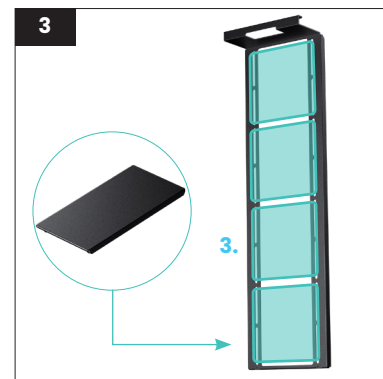

### 01 REMOVE SCREW

Remove the screw located on the top.

### 02 PULL & TAKE OUT BRACKET

Remove the bracket by pulling the handle at the top of the bracket and take it out.

### 03 INSTALL FANS/RADIATOR

Install up to 4x 120 fans/360 radiator on the bracket.

### 04 INSTALL SIDE BRACKET

Re-install the bracket and secure it with the screw located on the top.

Use the 3 cut-outs to route all fan cables.



### PRO TIP

Use the provided airflow cover for optimal airflow. When used, the airflow will be closed off.

## BOTTOM FAN/RADIATOR BRACKET

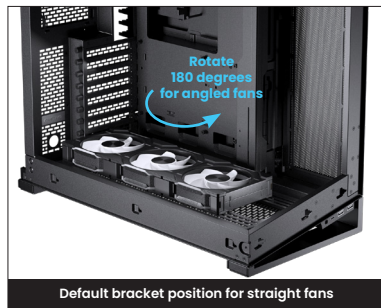
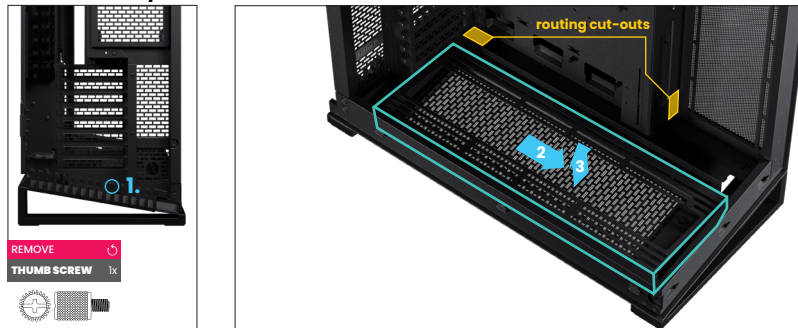

Default bracket position for straight fans

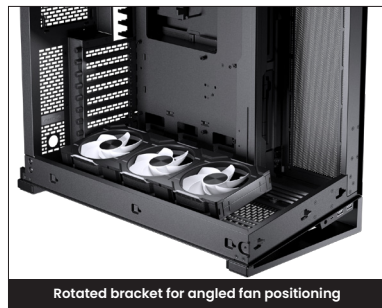

Rotated bracket for angled fan positioning

### 01 REMOVE BOTTOM BRACKET

Release the bracket by removing the rear thumb screw. Slide the bracket to the front to remove it.

### 02 INSTALL FANS/RADIATOR

Install up to 3x 120mm / 3x 140 mm fans and/or 280/360 radiator on to the bracket.

### 03 RE-INSTALL BOTTOM BRACKET

Re-install the bracket by sliding it towards the rear and secure it with the thumb screw.

It is possible to install the bracket the other way around for angled fans.

Fan cables can be routed through the cut-outs on the rear and side.

## REAR FAN/RADIATOR POSITION

The rear has space for up to 240 radiator and 2x 120 fans. The fans can be installed in front of the rear panel while the radiator can be installed behind the rear panel.

### 01 REMOVE REAR MESH PANEL

Remove the screw on the rear and remove the mesh panel.

### 02 INSTALL FANS/RADIATOR

Install up to 2x 120 fans on the inside of the rear chassis. A 240 radiator can be installed on the outside of the rear chassis.

### 03 RE-INSTALL REAR MESH PANEL

If no radiator is installed, re-install the rear mesh panel.

Fan cables can be routed through the cut-outs on the rear.



### TOP FAN/RADIATOR POSITION

#### 01 INSTALL FANS/RADIATOR

Up to 3x 120 fans/360 radiator can be directly installed into the top of the chassis.

Fan cables can be routed through the cut-outs on the top.



#### 01 CONNECT POWER BUTTON

Connect the power switch module to the motherboard.



power switch/power LED module

power LED      power switch

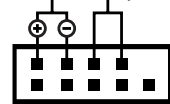

motherboard header diagram



## I/O INTERFACE

- USB 3.1 GEN 2 TYPE-C (1x)
- USB 3.0 TYPE-A (2x)
- Headphone/microphone (1x)

## CONNECT I/O CABLES TO MOTHERBOARD

**01** CONNECT USB 3.1 GEN 2 TYPE-C



**02** CONNECT USB 3.0 TYPE-A



**03** CONNECT HD AUDIO

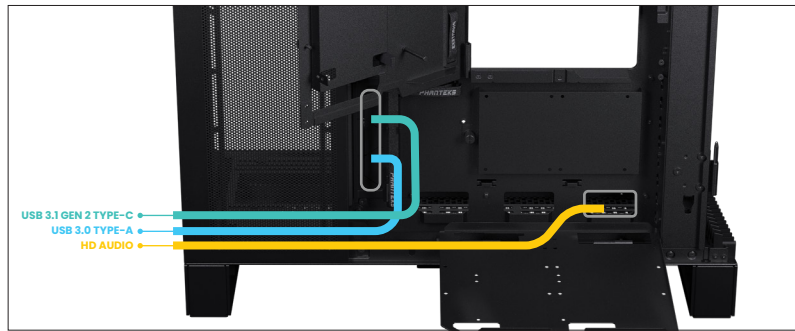

## STEPS TO MOVE I/O TO THE REAR

**01 REMOVE BOTTOM FAN BRACKET**

Remove the bottom fan bracket.

**02 REMOVE SCREWS**

Unscrew 2x screws located inside the chassis.

**03 SLIDE I/O UNIT OUT**

Slide the I/O unit forward and remove it.

**04 PUSH OUT COVER**

Push the cover, located on the rear bottom, up to remove it.

**05 SLIDE I/O UNIT IN**

Pull the cables through the cutout and slide the I/O unit into the rear position.

**06 SECURE I/O UNIT**

Secure the I/O unit in its new position with 2x screws.

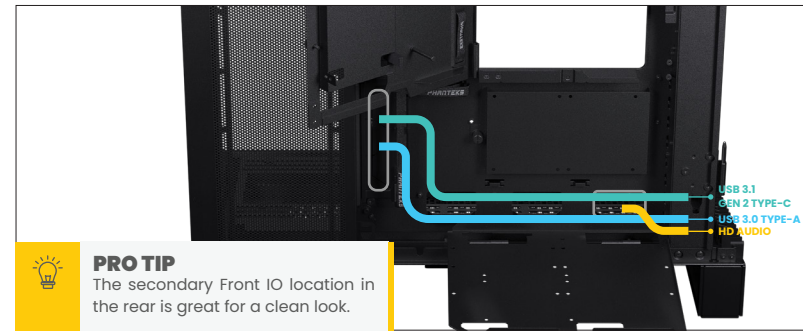
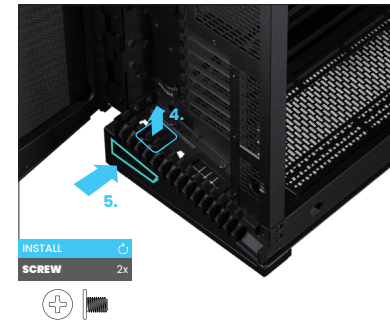
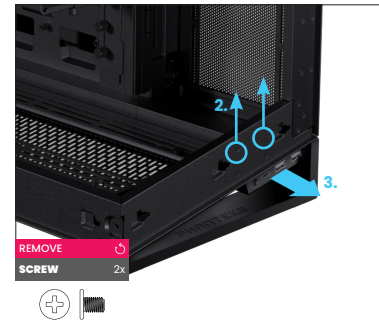
**PRO TIP**

The secondary Front IO location in the rear is great for a clean look.

## D-RGB CONTROLLER

The built-in D-RGB controller has 2 channels (A & B). Both channels, each with 2 available D-RGB ports, can be controlled separately with the control buttons on the front I/O.

*max 7A per channel, max 4A per port*

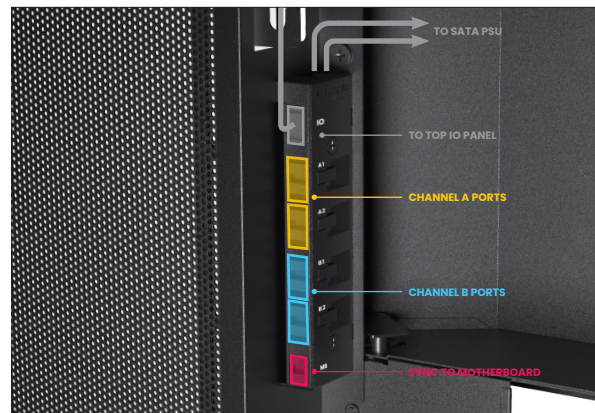

## LIGHTING EFFECTS & CONTROLS

D-RGB Lighting effects and control instructions are described on page 6.

### 01 CONNECT THE SATA CABLES

Connect the 2x SATA cables to the power supply.



### 02 EXPAND WITH OTHER D-RGB PRODUCTS

To Phanteks Digital-RGB products (JST connector)

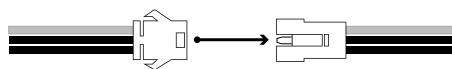

### 03 SYNC LIGHTING TO MOTHERBOARD (OPTIONAL)

The D-RGB to motherboard cable is included in the accessory box.

*sync lighting to the motherboard*

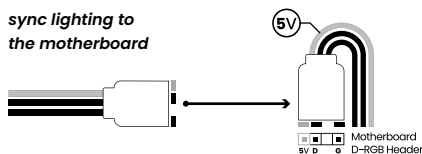

## TOP DOOR STORAGE

### 01 OPEN TOP DOOR

Loosen the thumb screw to open the top door.

### 02 INSTALL 2.5" DRIVES

Install up to 2x 2.5" drives with 2x SSD screws per SSD.



LOOSEN  
THUMB SCREW 1x



INSTALL  
SSD SCREW 4x



## BOTTOM DOOR STORAGE

### 01 OPEN BOTTOM DOOR

Loosen the thumb screw to open the door.

### 02 INSTALL DRIVES

The bottom door can be used for one of the following storage options:  
1x 3.5" + 4x 2.5" | 4x 2.5" | 2x 3.5"

#### OPTION A - 1X 3.5" + 4X 2.5"

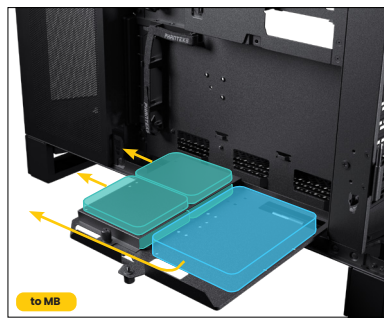

#### OPTION B - 4X 2.5"

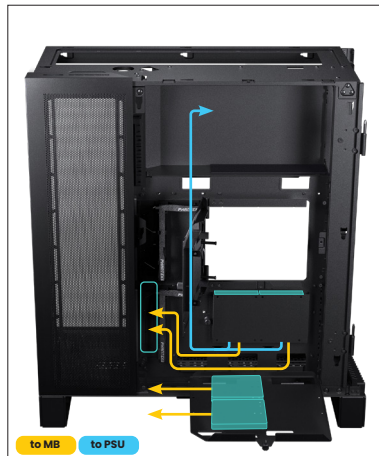

01. Reposition the 2.5" drive bracket to the rear of the motherboard.
02. Install 2x 2.5" drives on the door and 2x 2.5" drives on the bracket

#### OPTION C - 2X 3.5"

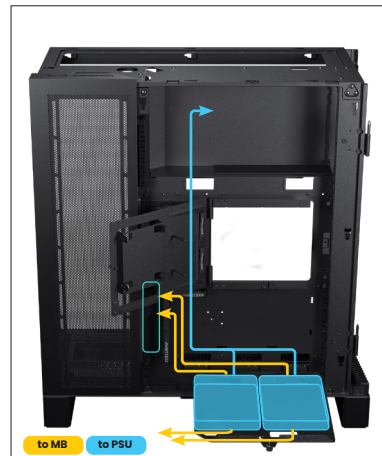

01. Remove the 2.5" drive bracket completely.
02. Install 2x 3.5" drives with cables routed to the top

## PSU CABLE MANAGEMENT

The PSU cables can be routed like the image below for clean cable management. Open the top cover door to loop the CPU & MB cables to get rid of excessive cable length.



Loop excessive cable length on the inside of the top cover door.



### 01 INSTALL MOTHERBOARD COVER

The motherboard cover can be installed in two ways:

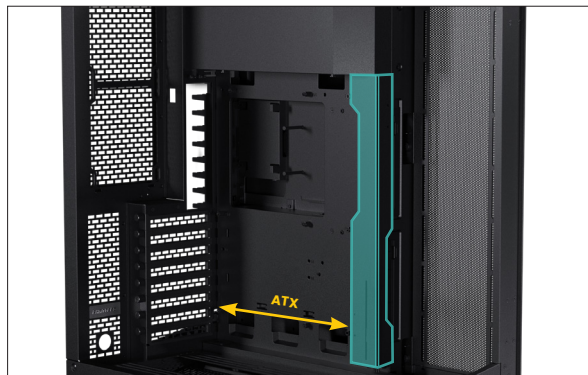

#### Option 1: Default

The first option covers a bit more of the cables attached to the motherboard, and is a great fit for standard sized ATX motherboards.

#### Option 3: Remove Cover

For even larger motherboards and maximum clearance, it is recommended to remove this cover completely.

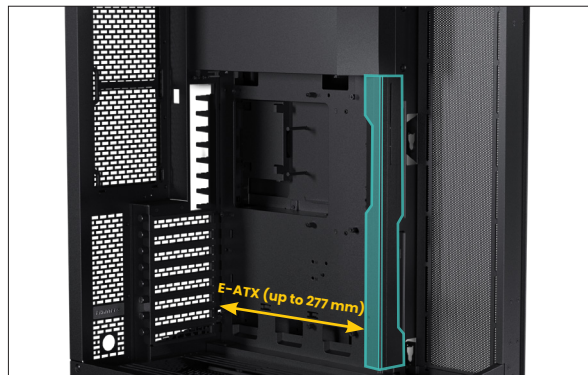

#### Option 2: Reversed

For the second option, the cover is installed in reversed position. This covers less of the motherboard and allows more clearance for E-ATX motherboards (up to 277 mm).

### 02 INSTALL D-RGB COVER

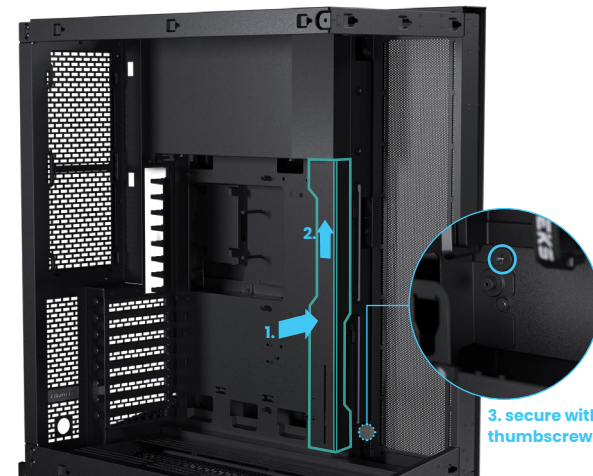

After choosing the preferred position, align the motherboard cover (1) and slide upwards (2). Secure it with the thumb screw through the right side of the chassis (3).

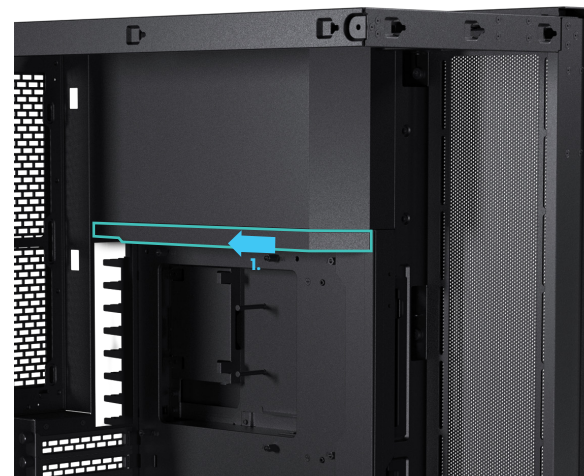

Slide the D-RGB cover to the rear of the chassis to install it.

## INSTALLING GPU SUPPORT BRACKET (OPTIONAL)

NV7

### 01 INSTALL BRACKET

Install the GPU support bracket on the motherboard cover with 1x thumb screw.



### 02 ADJUST HEIGHT

Adjust to the correct height for your GPU and use the thumb screw to secure it.

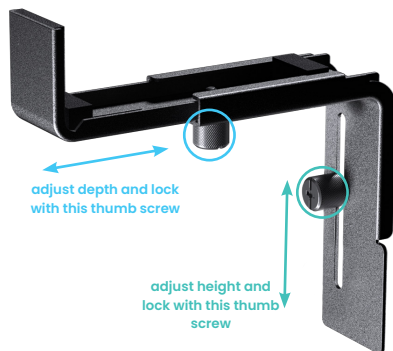

### 03 ADJUST DEPTH

Adjust the depth of the bracket to hold the GPU tightly and lock with 1x thumb screw underneath the bracket.

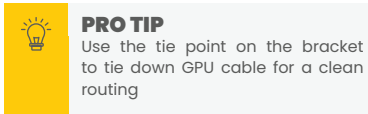

## EXTERNAL CABLE MANAGEMENT

NV7

### CABLE LANES

External cables can be managed with the cable lanes behind the rear door. The left lane is larger and can be used for thick cables. The other three lanes are smaller and made for thin cables.

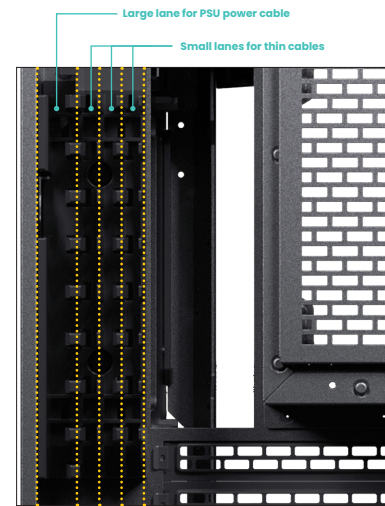

### VELCRO TIE

Use the velcro tie on the bottom to tie all cables down to the chassis.

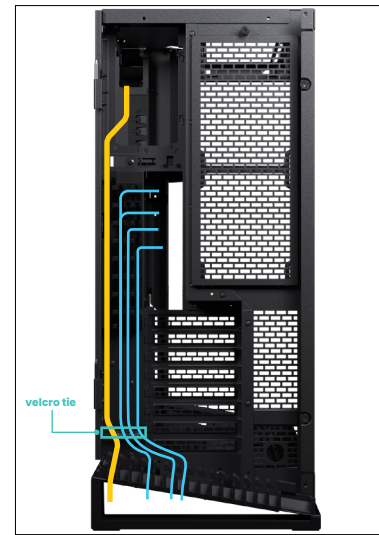

### COMB OR GROMMET

There are two options for the cables to leave the case:

#### Option 1: Rear comb

The rear comb can be used to separate each cable to leave the case neatly.

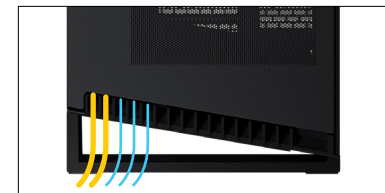

#### Option 2: Bottom grommet

Alternatively, the grommet on the bottom of the chassis can be used to lead the cables out.





As a Phanteks customer, you are priority number one. We have a dedicated team of employees across the globe working hard every day to make sure we deliver the superior experience you deserve. We are here for you. If you have a question or a concern about our products, we have numerous ways you can reach us. Please choose one most convenient for you to connect with our team.

### INTERNATIONAL

#### CUSTOMER SUPPORT

**Facebook**  
@phanteks

**Instagram**  
@phanteks

#### RMA & TECHNICAL SUPPORT

**E-mail**  
support@phanteks.com

### AMERICAS

#### RMA & TECHNICAL SUPPORT

Hours	Phone Number	E-mail
Monday - Friday 09:00 - 05:00 PST	+1 (909) 598 2115	support@phanteksusa.com

For up-to-date information please check [www.phanteks.com](http://www.phanteks.com)

Phanteks warrants its products to be free from defects in material and workmanship during the warranty period; when given normal, proper and intended usage. If a product proves to be defective in material or workmanship during the warranty period, Phanteks will, at its sole option, repair or replace the product with same product or similar product. The replacement product assumes the remaining warranty of the original product or 30 days, whichever provides longer coverage for the customer.

### WARRANTY

**1. I/O Ports**  
2 Years

**2. LED Lighting**  
2 Years

**3. Buttons**  
2 Years

**4. Chassis**  
5 Years

**5. External Panels**  
5 Years

Please check [www.phanteks.com/Warranty](http://www.phanteks.com/Warranty) for more information.

FOLLOW US

**SOCIAL MEDIA**



**Instagram**

Phanteks



**Facebook**

Phanteks



**YouTube**

Phanteks



**Twitter**

@phanteks

**PHANTEKS**