



128336341 (10.2020)

Kornmarksvej 1|DK-2605 Broendby|Denmark|Tel.: (+45) 4323 8100

Quick Start Guide High Pressure Washer Core 125

Caution: Read the instructions before using the machine

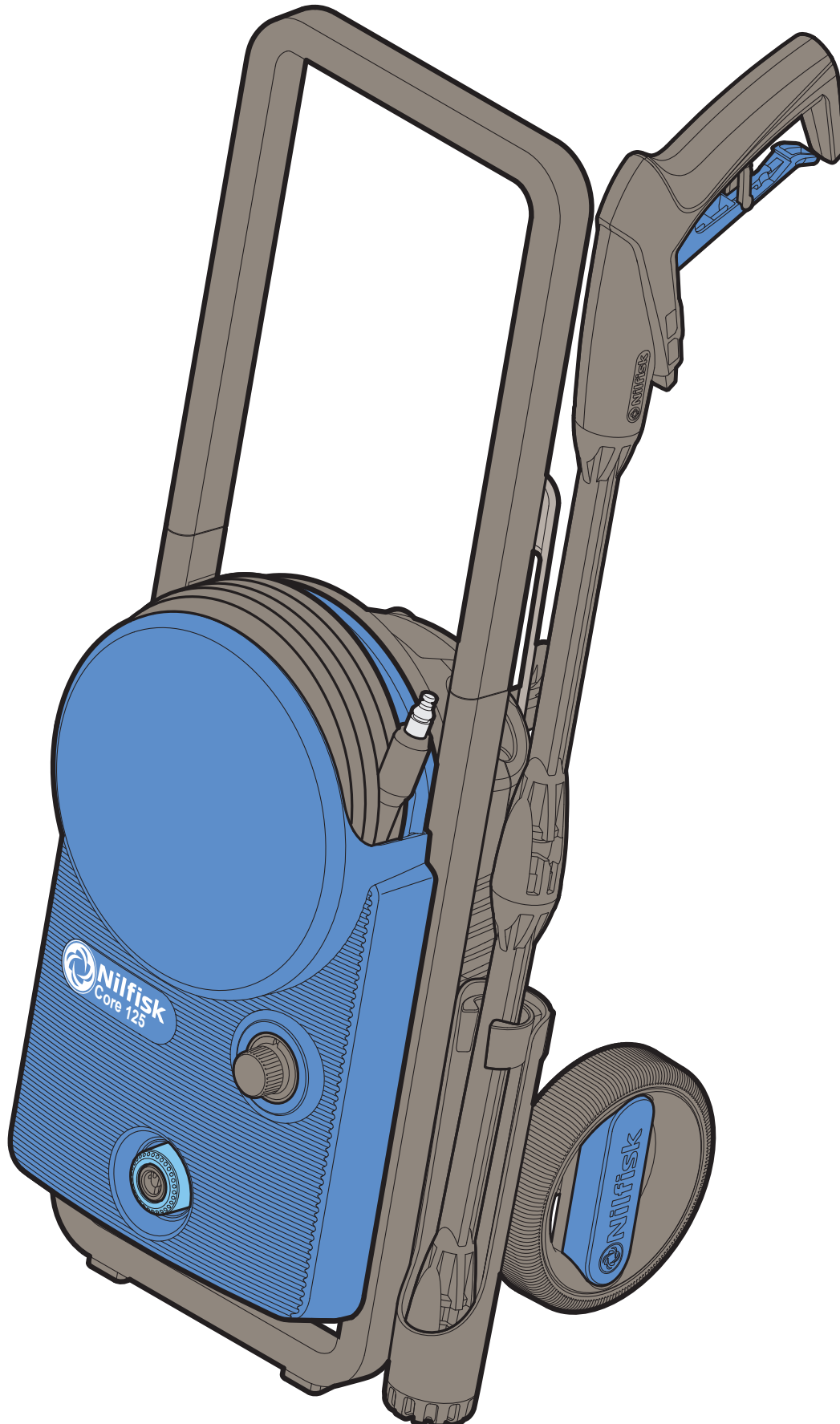

Core 125

A

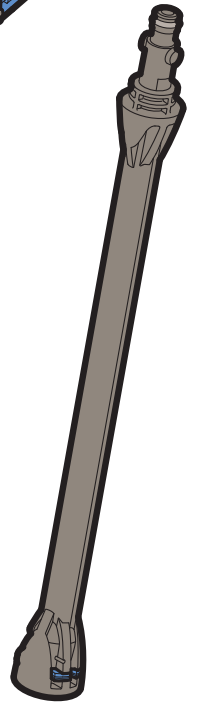
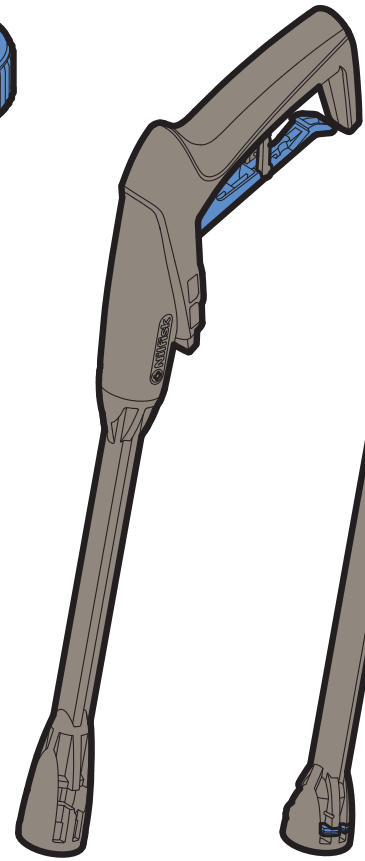
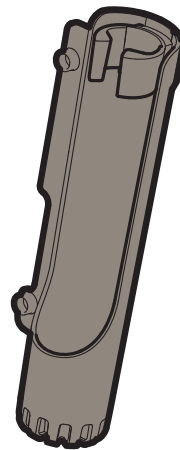
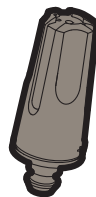
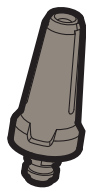
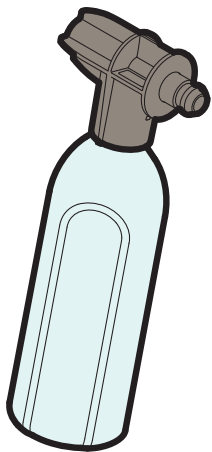
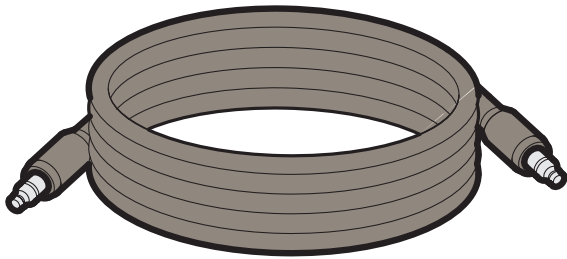
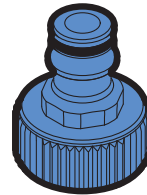
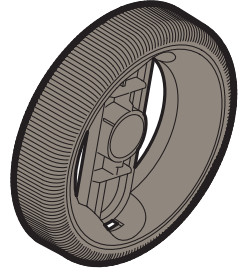
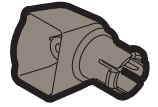
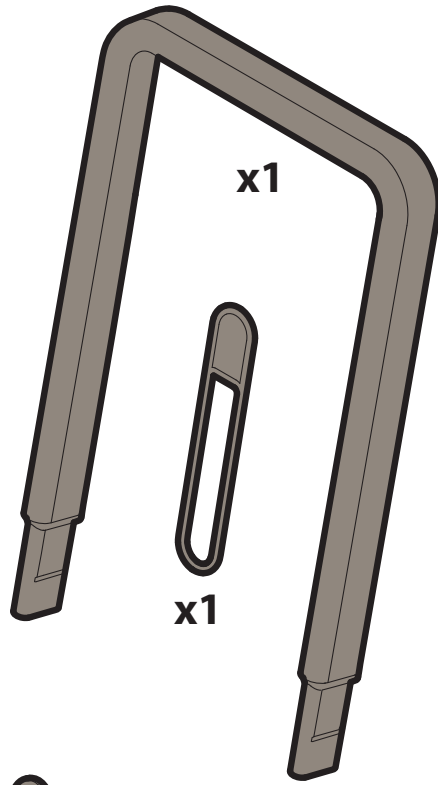
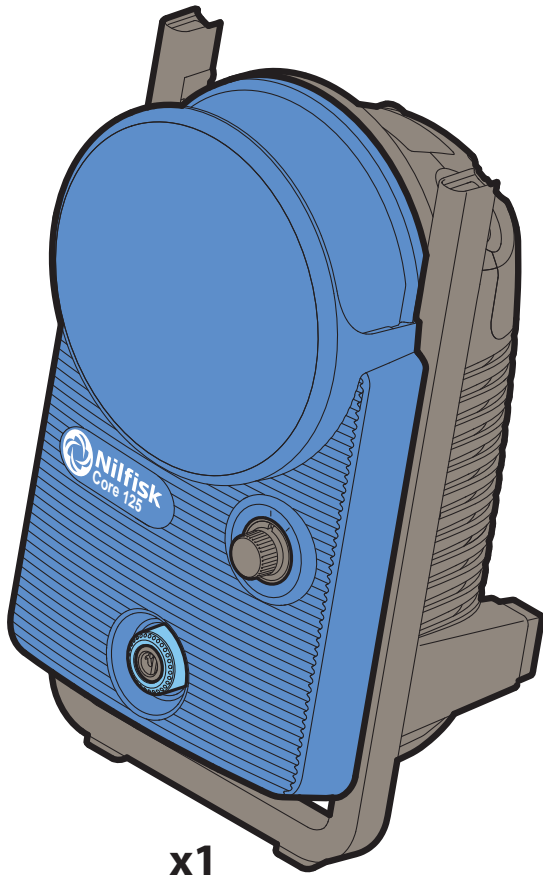

Core 125

A



1

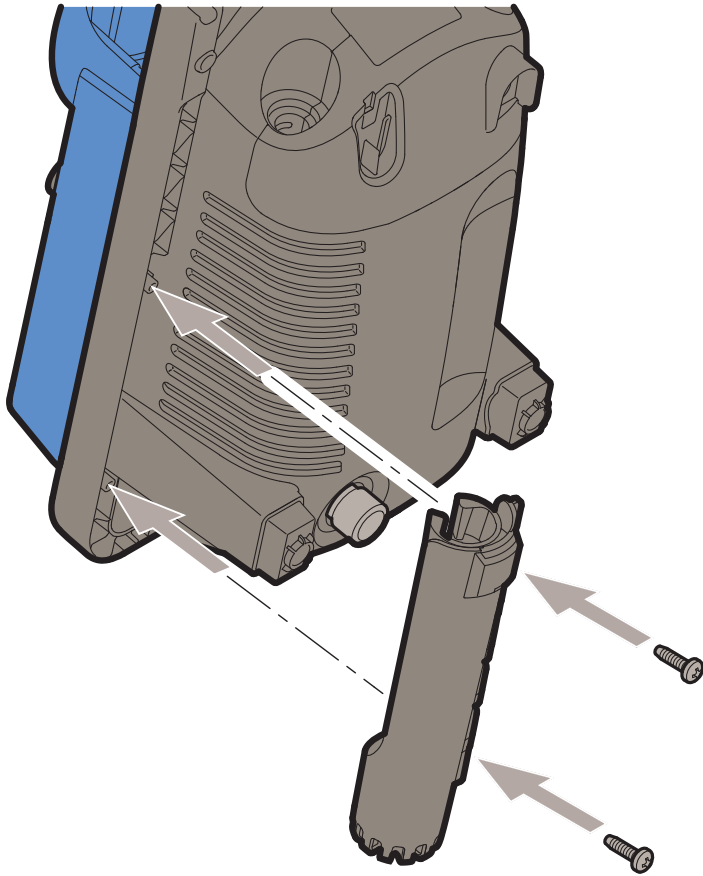

2

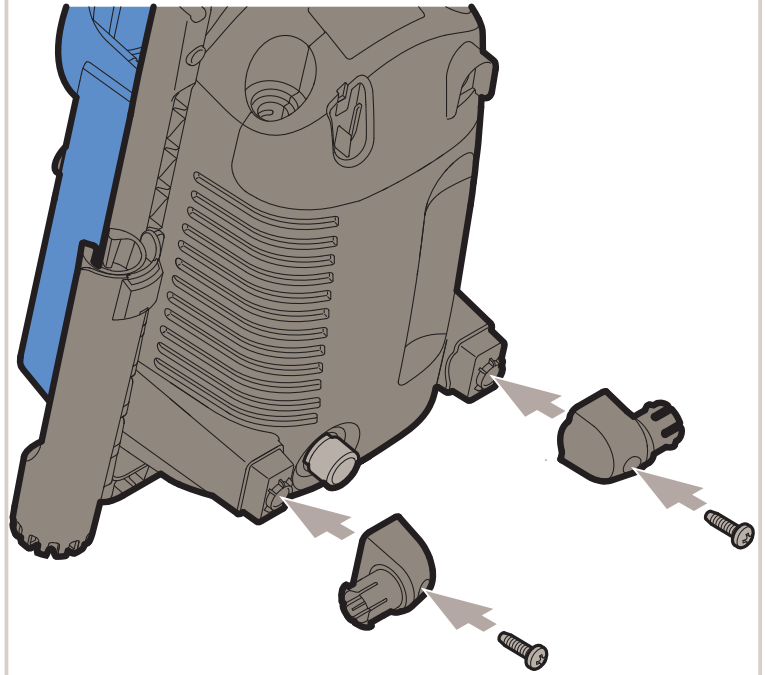

3

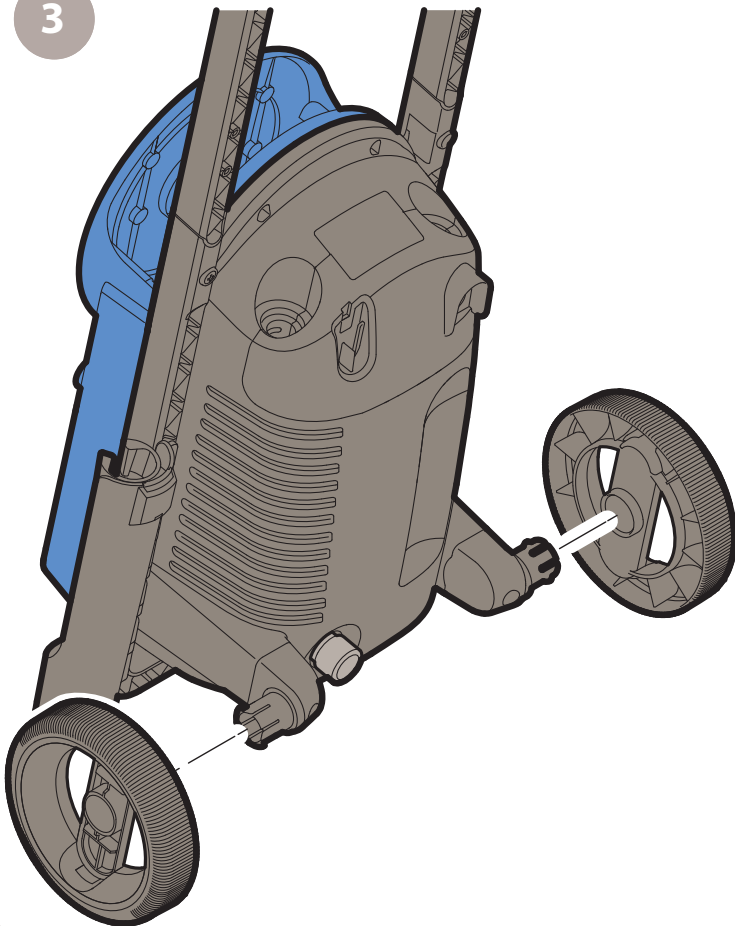

4

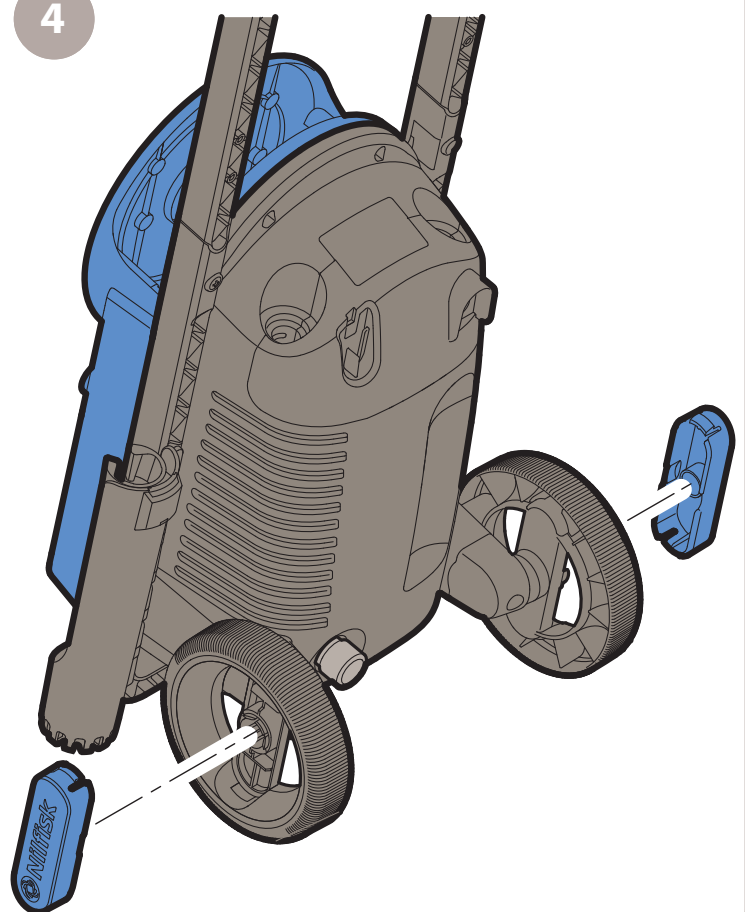

A



5

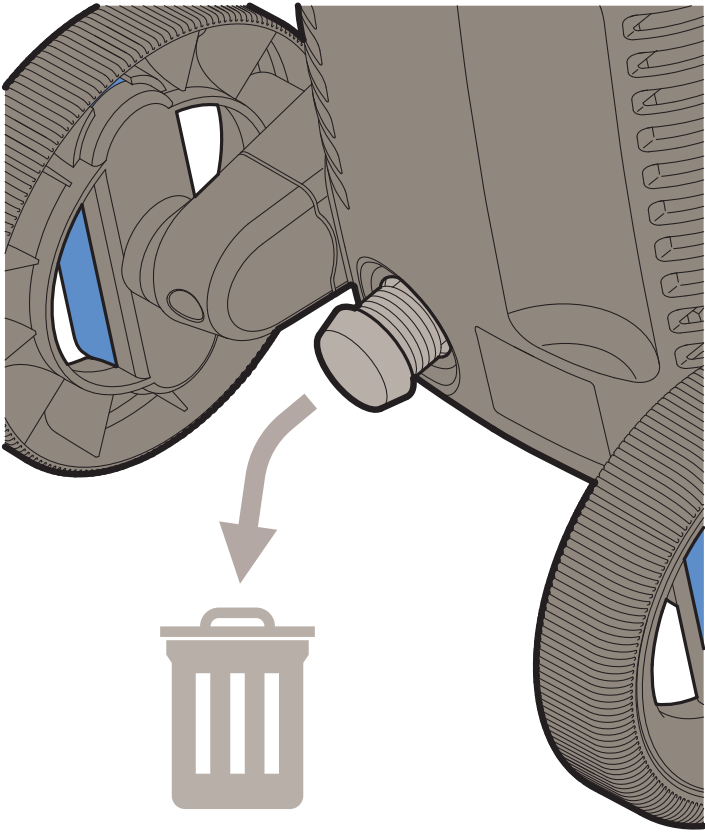

6

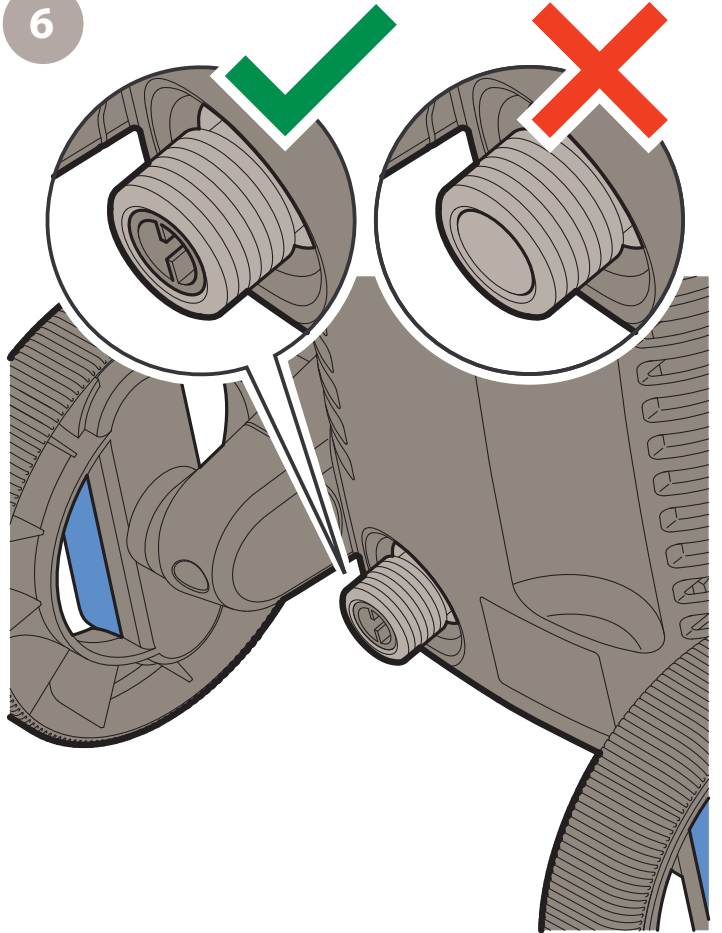

7

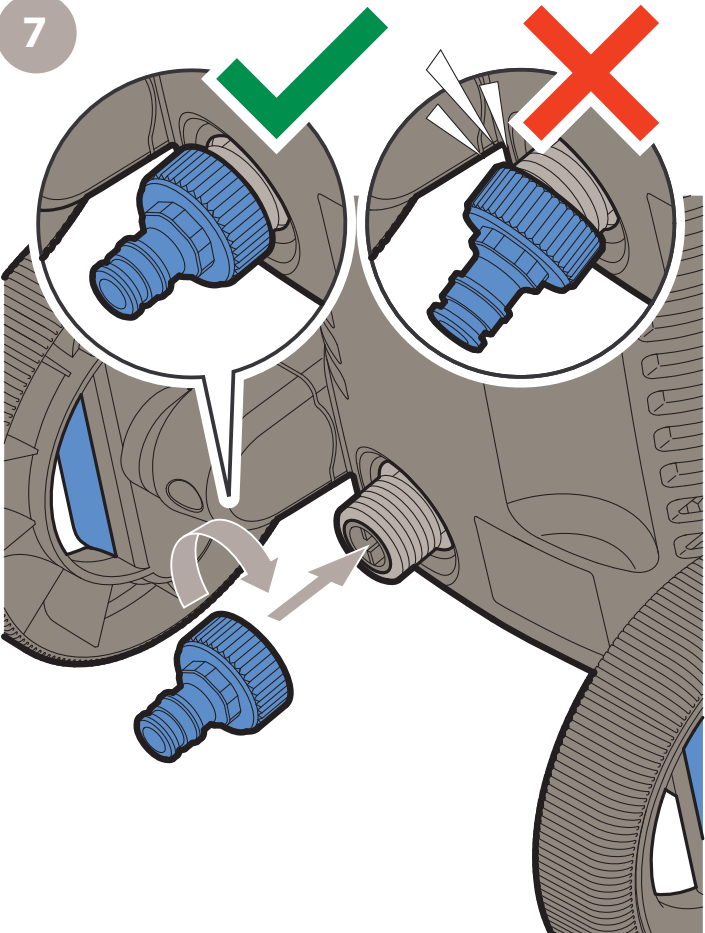

8

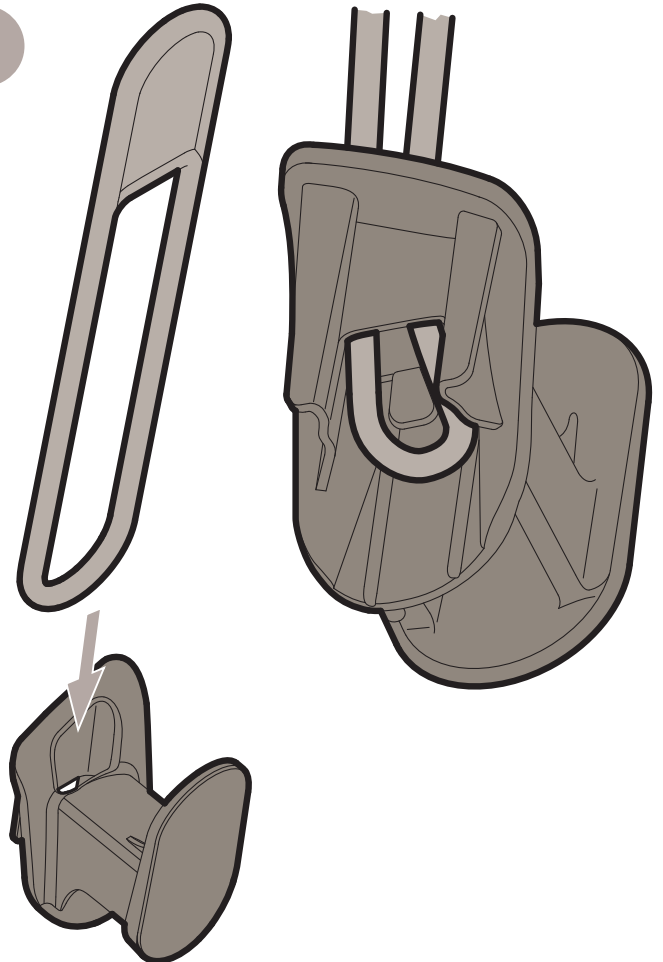

A



9

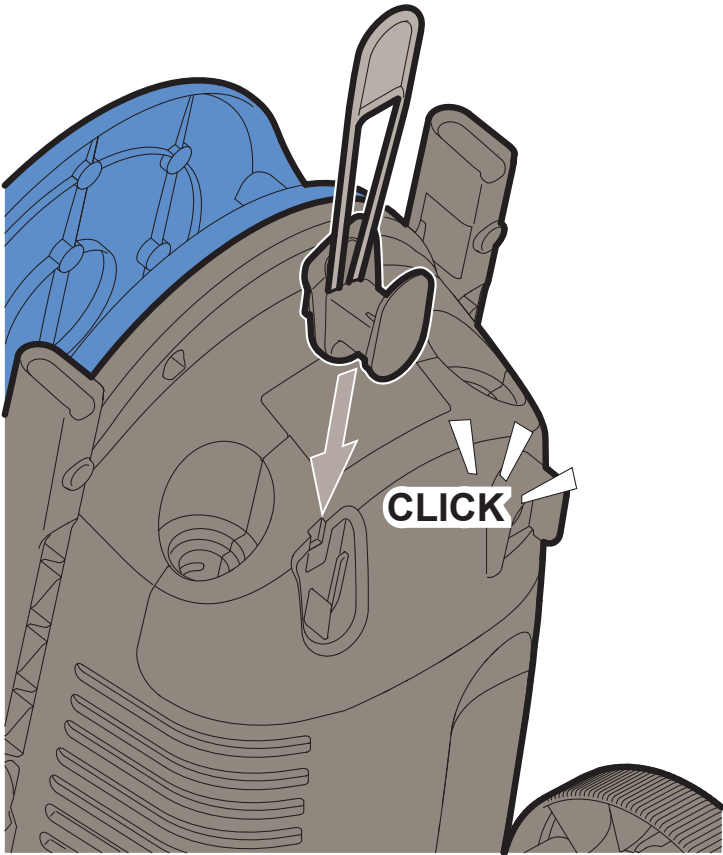

10

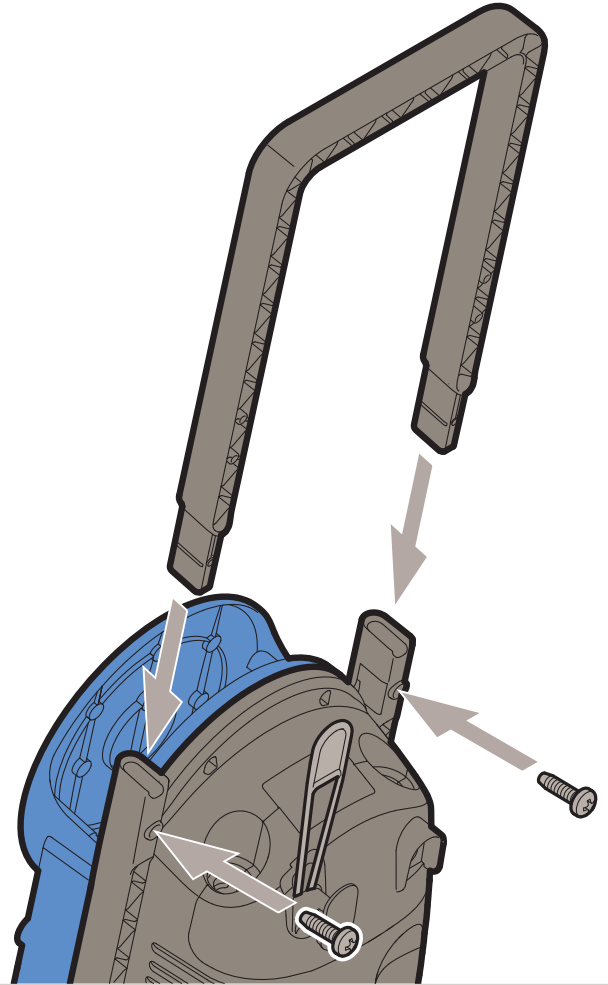

11

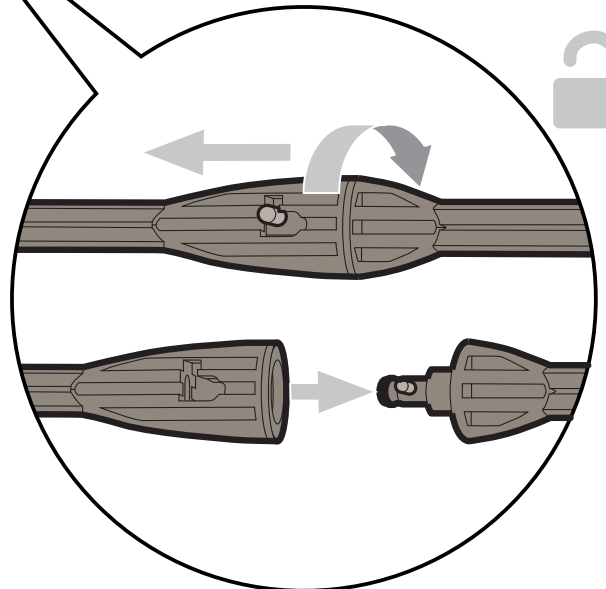
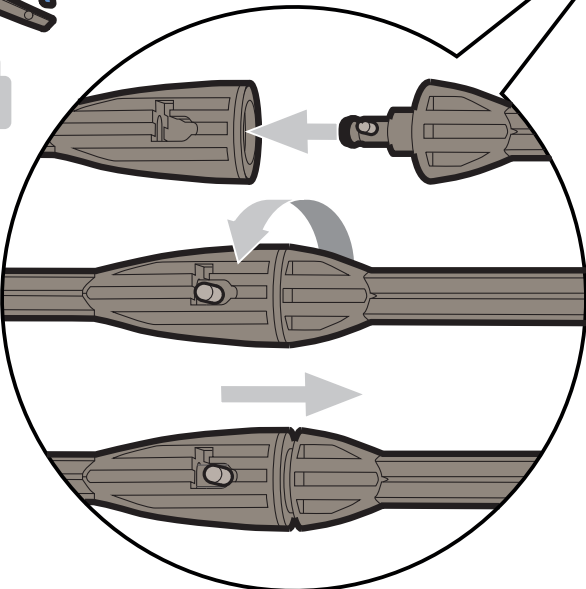
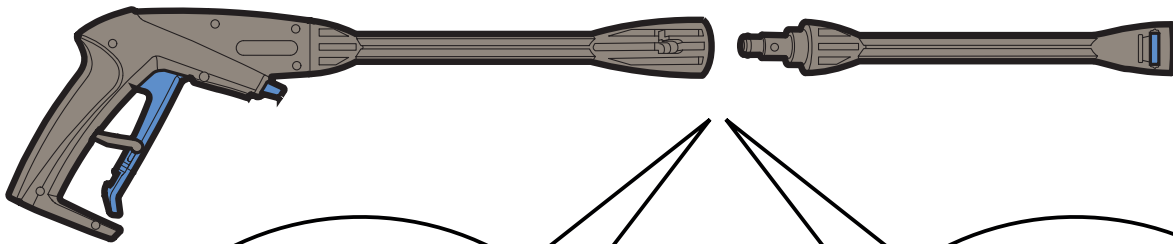

A



12

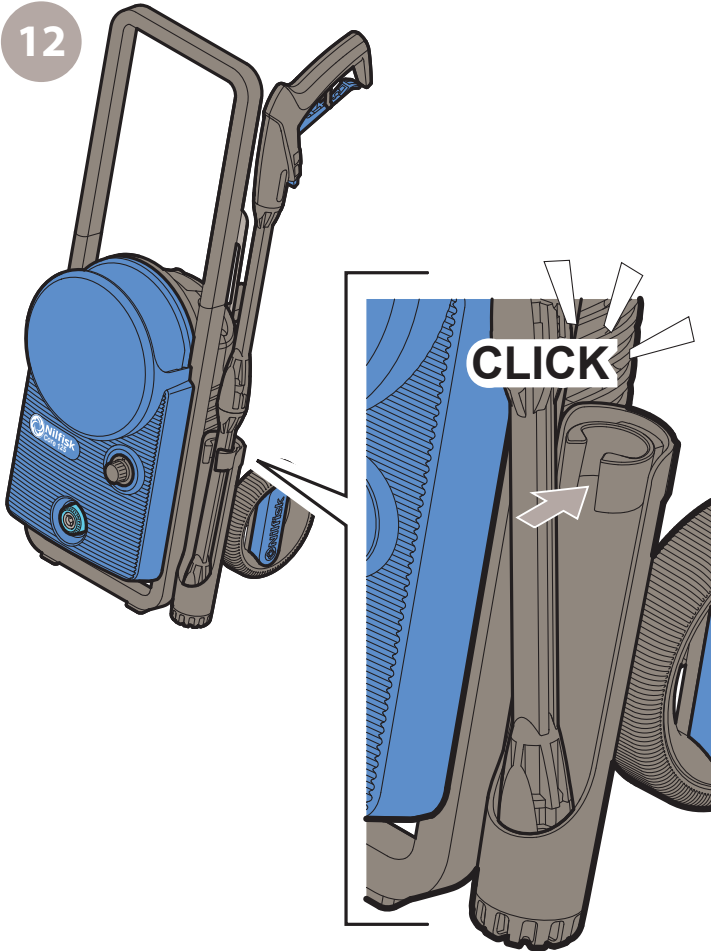

13

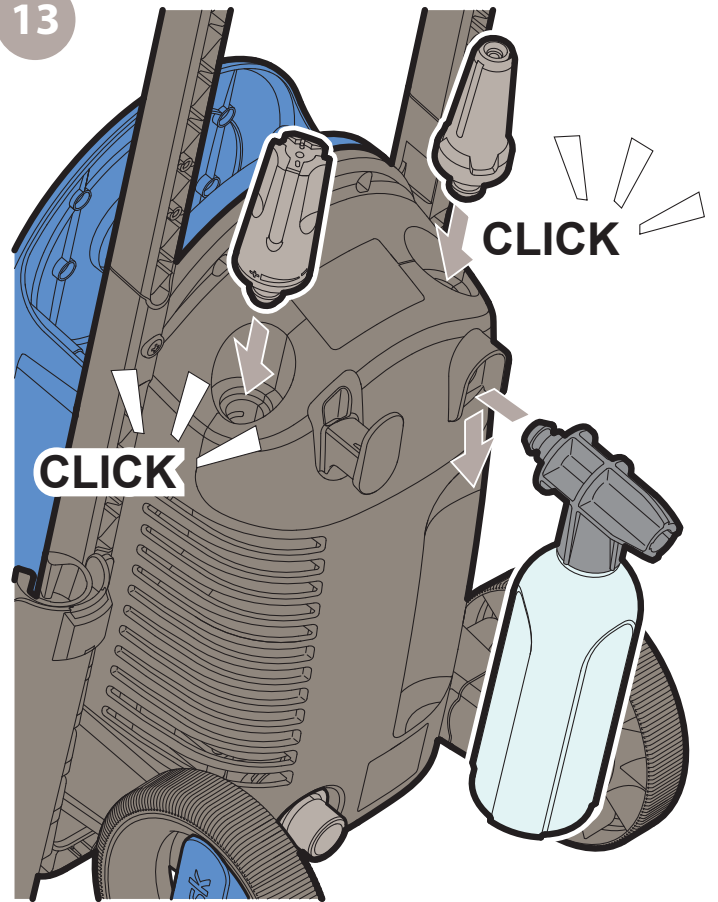

14

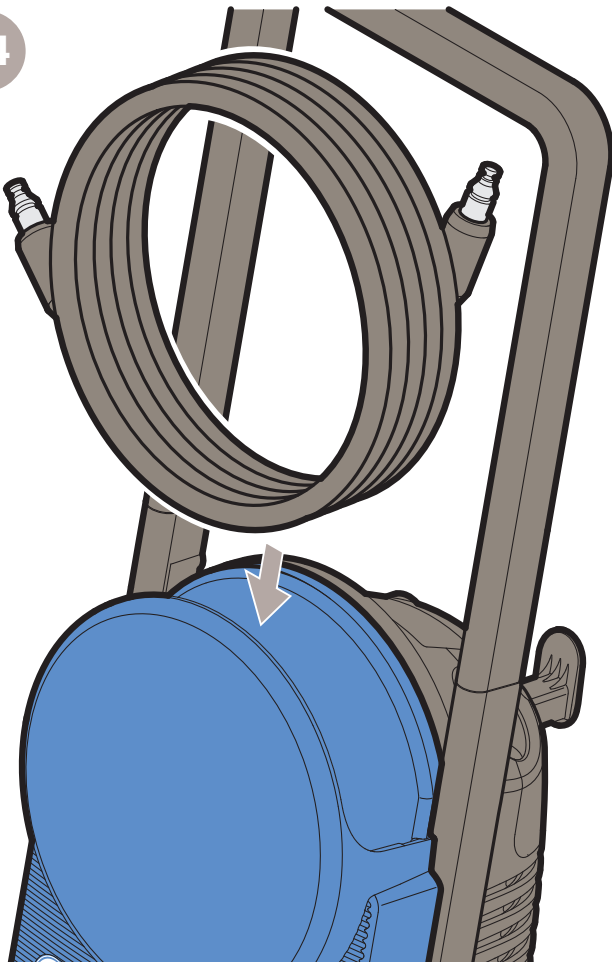

15

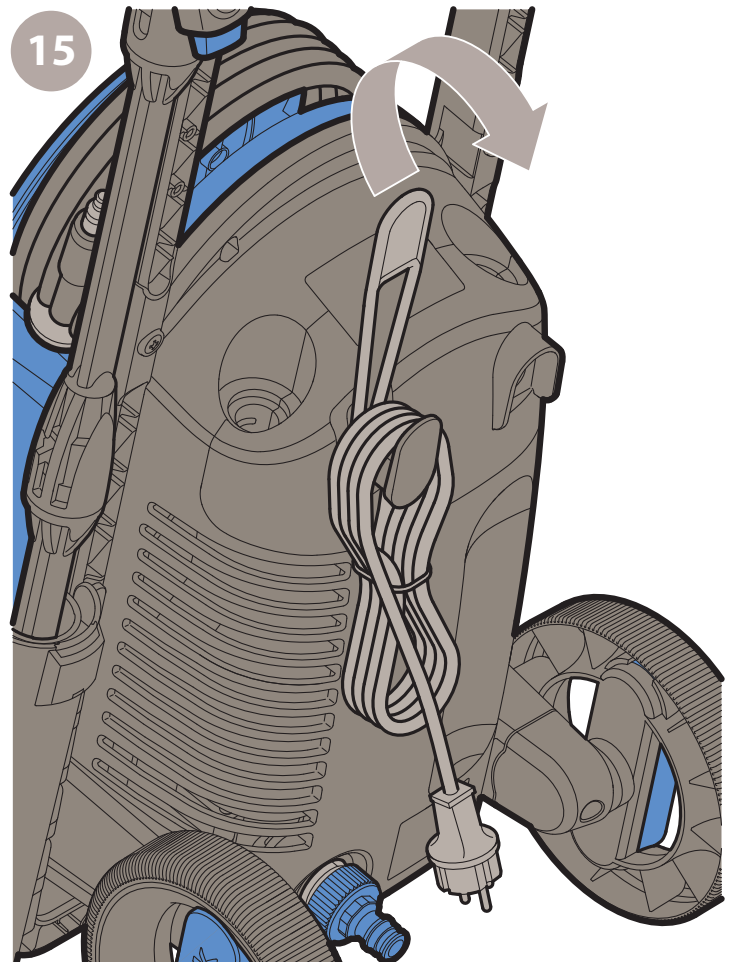

B



1

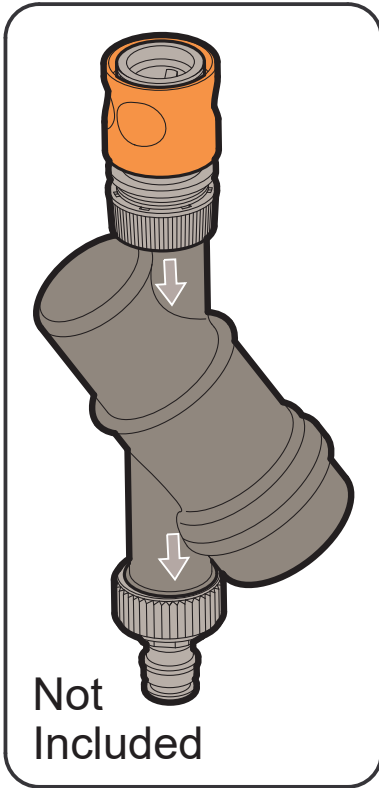

Not Included

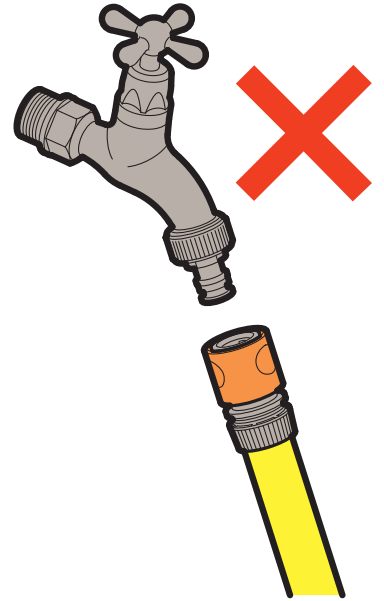
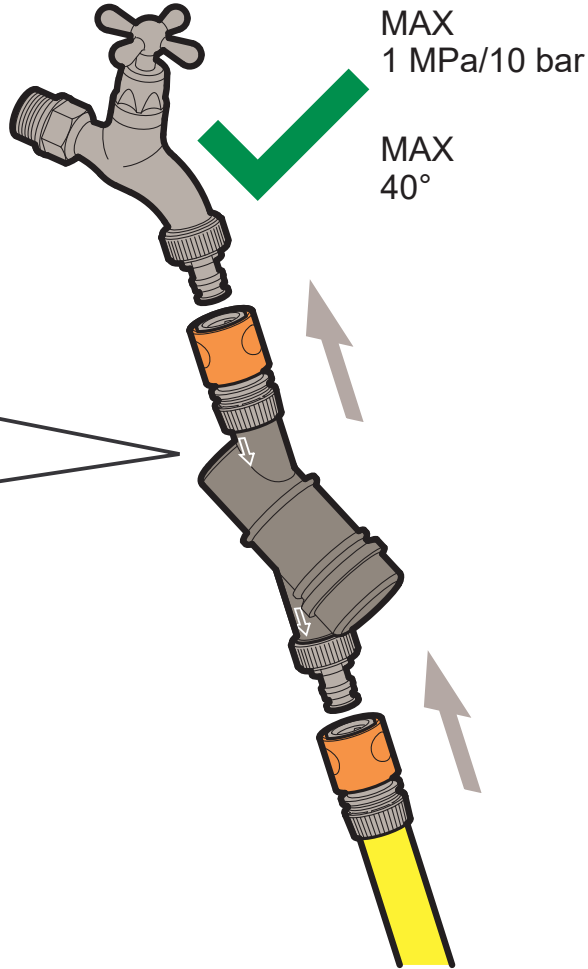

2

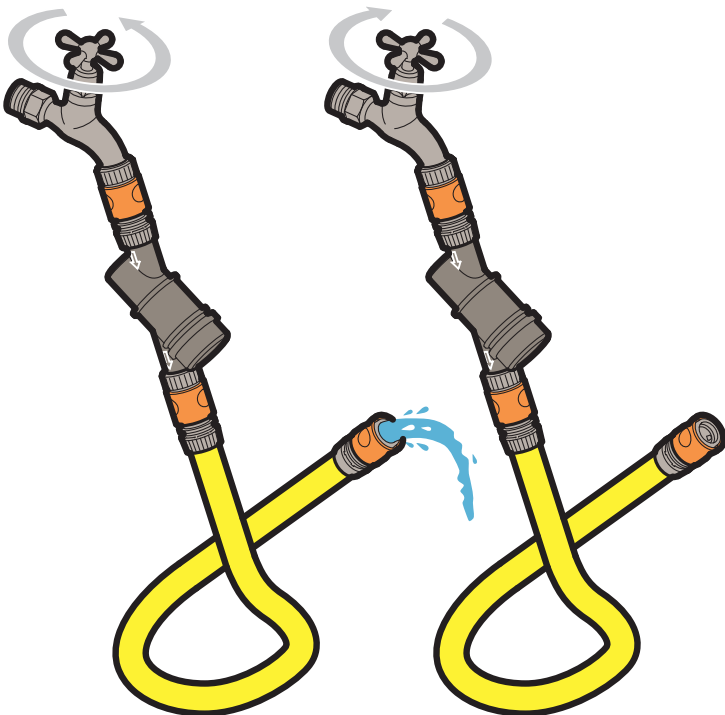

3

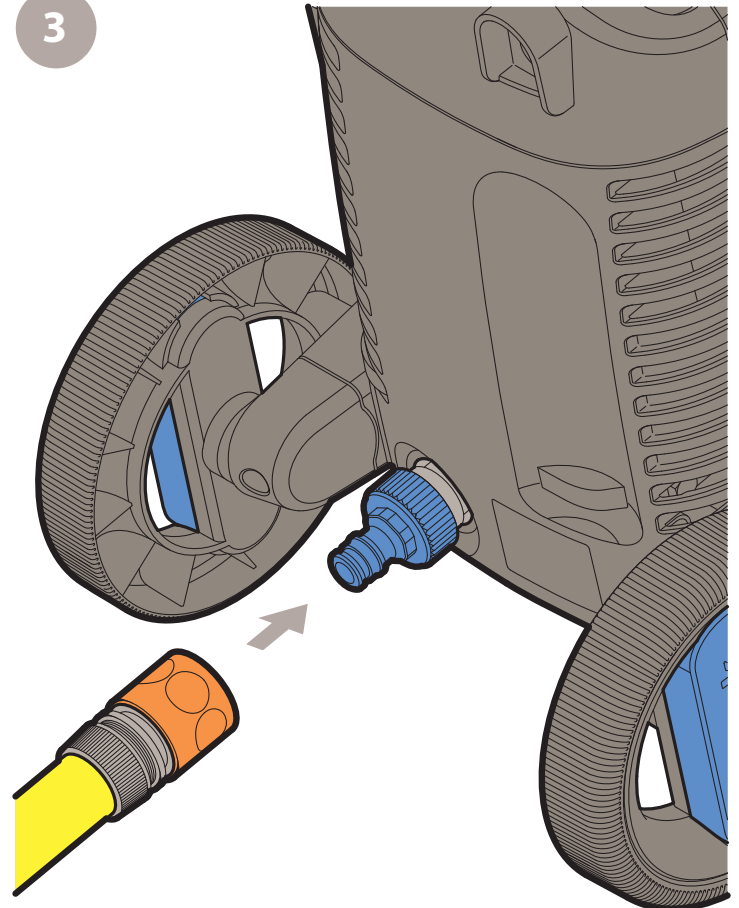

B



4

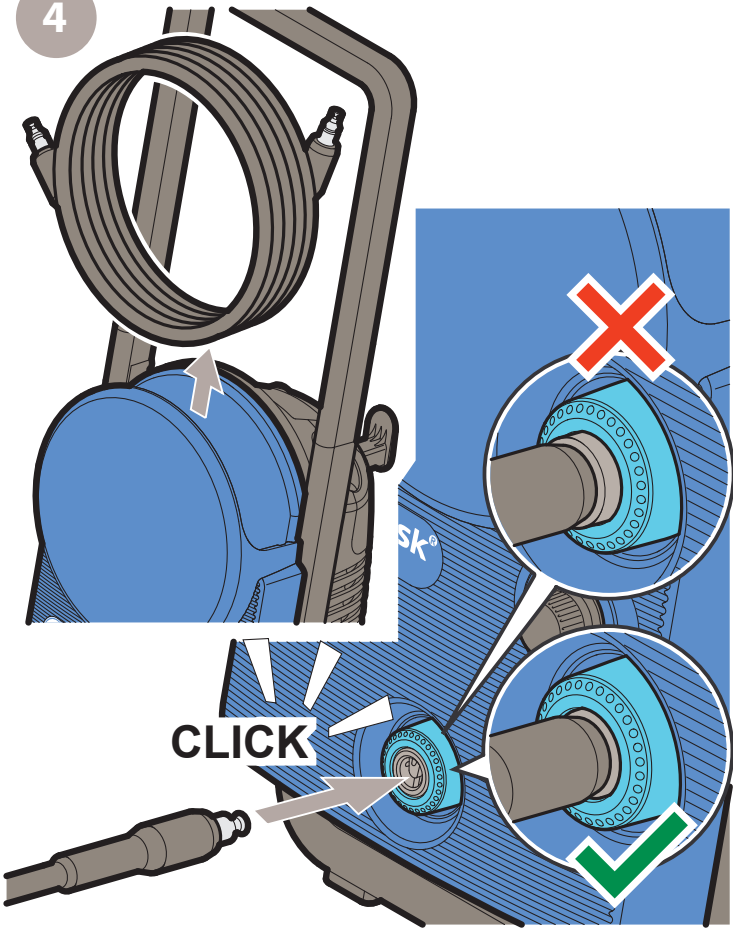

5

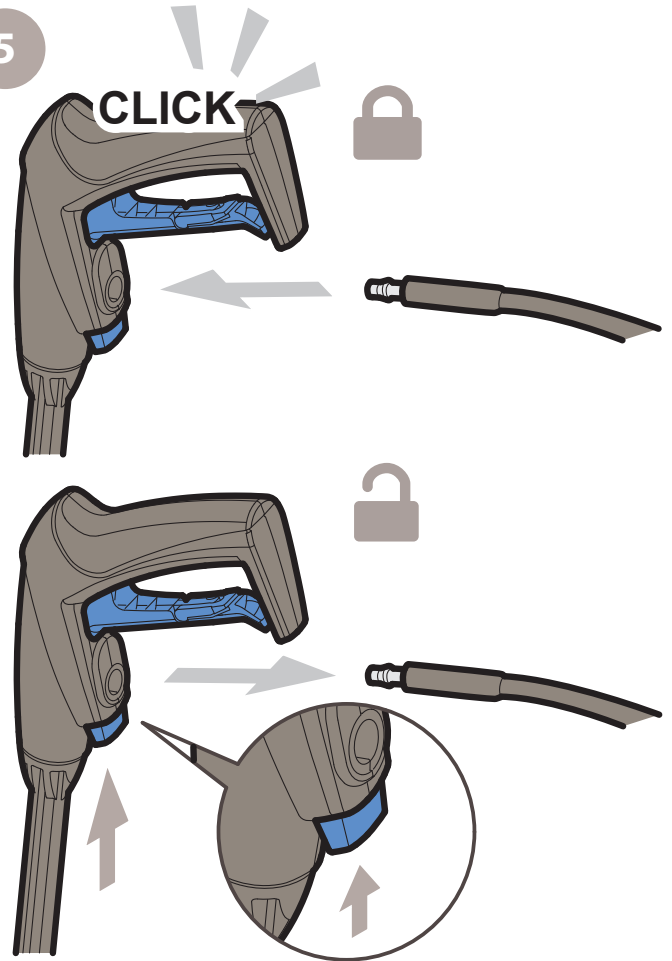

6

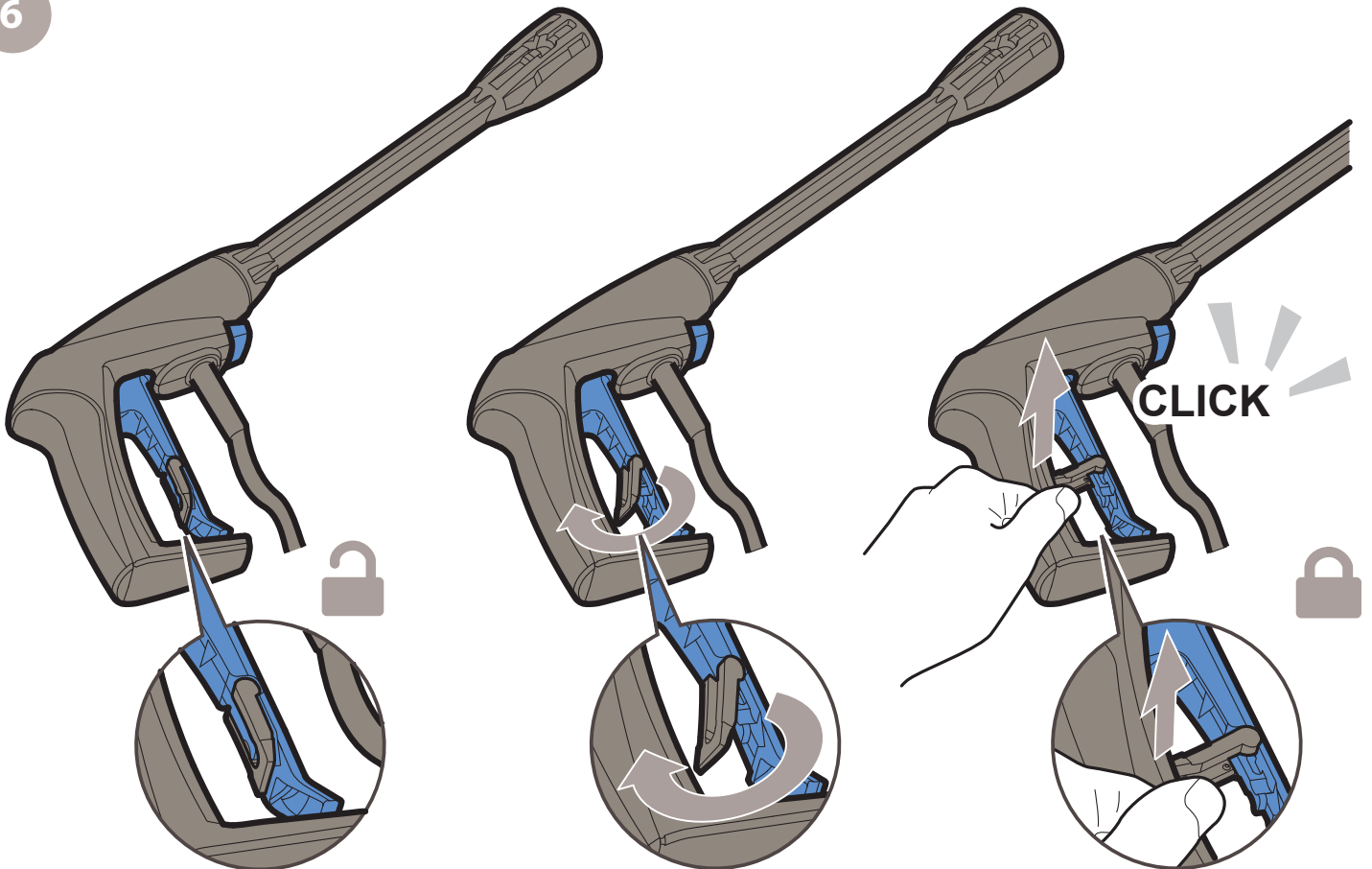

B



7

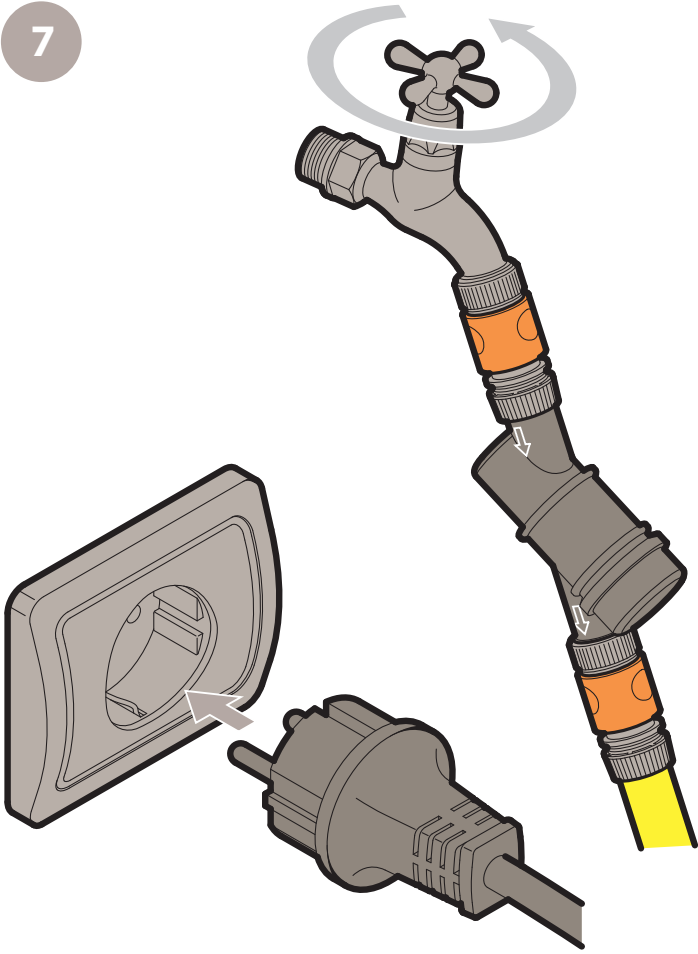

8

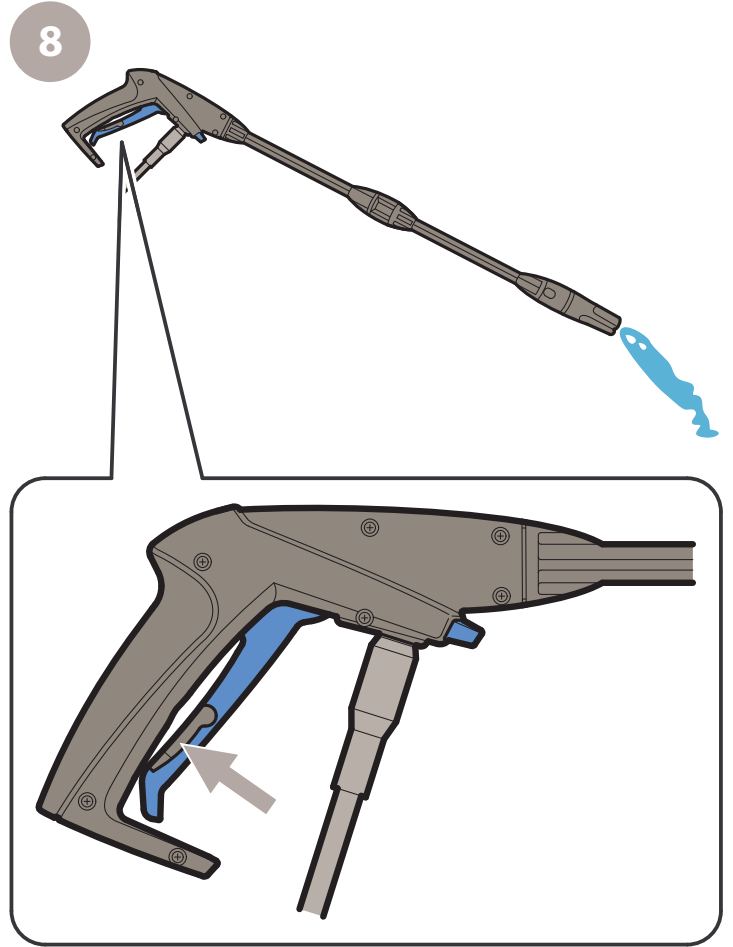

9

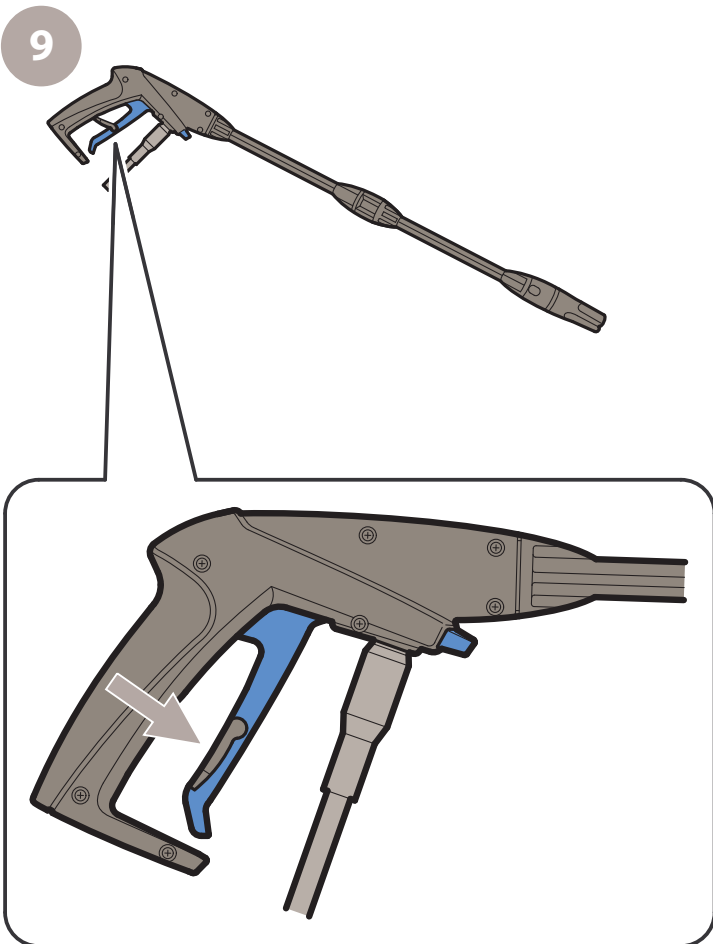

10

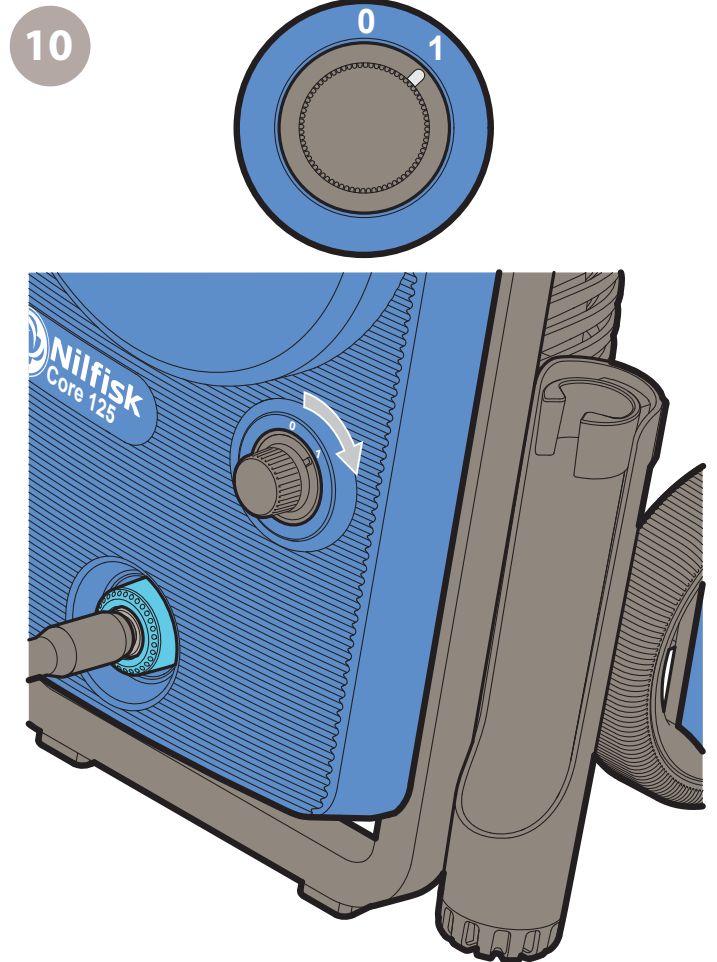

B



11

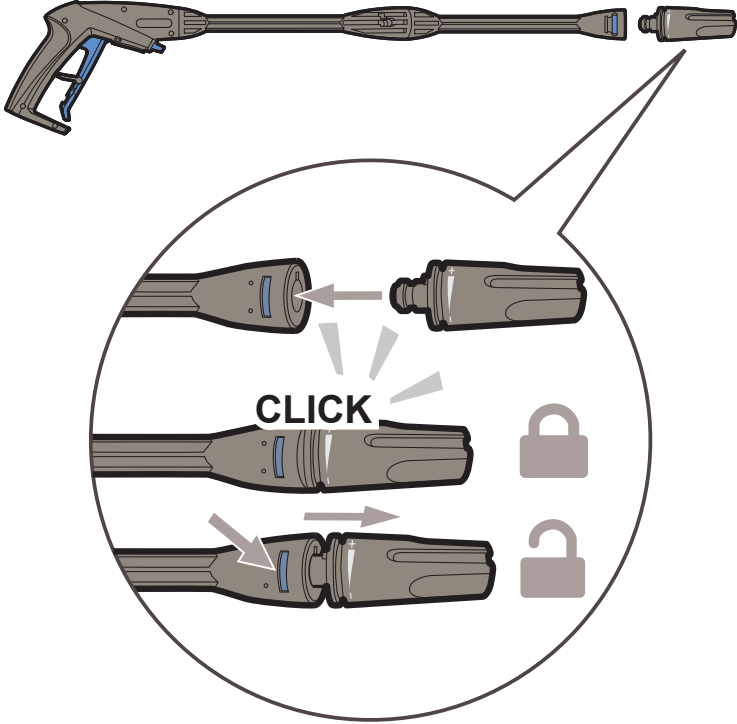

12

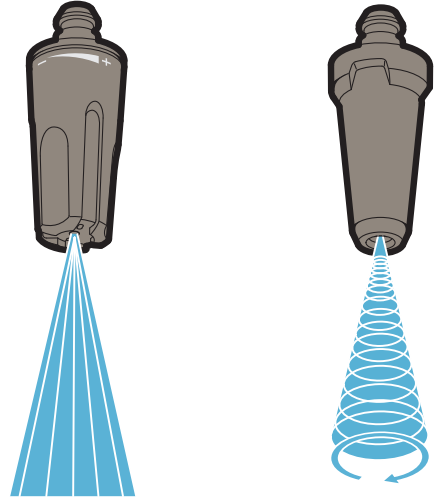

GENTLE NOZZLE

ROUGH NOZZLE

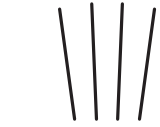

HARD SURFACES ONLY

13

MAX
MPa/bar



MIN
MPa/bar

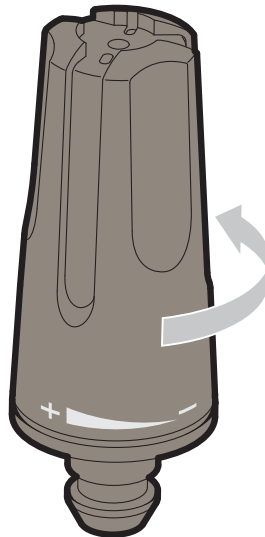
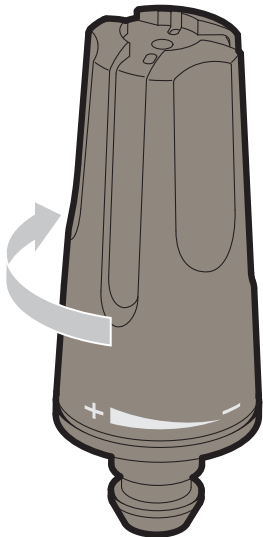

GENTLE NOZZLE

14



C

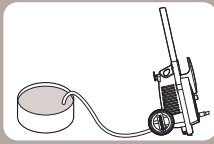

1

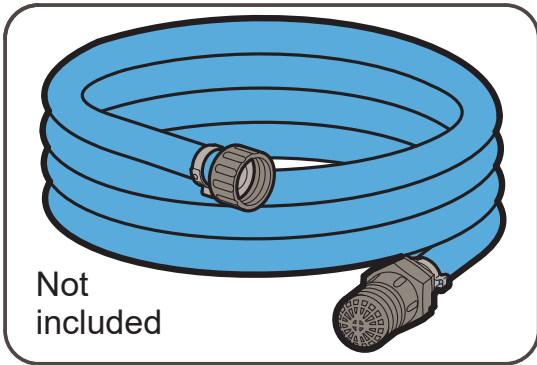

Not included

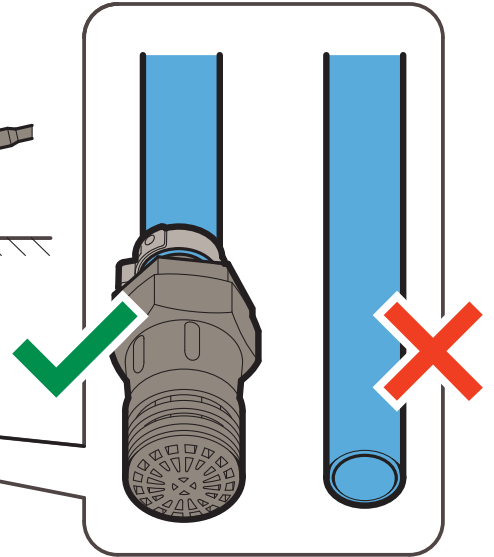
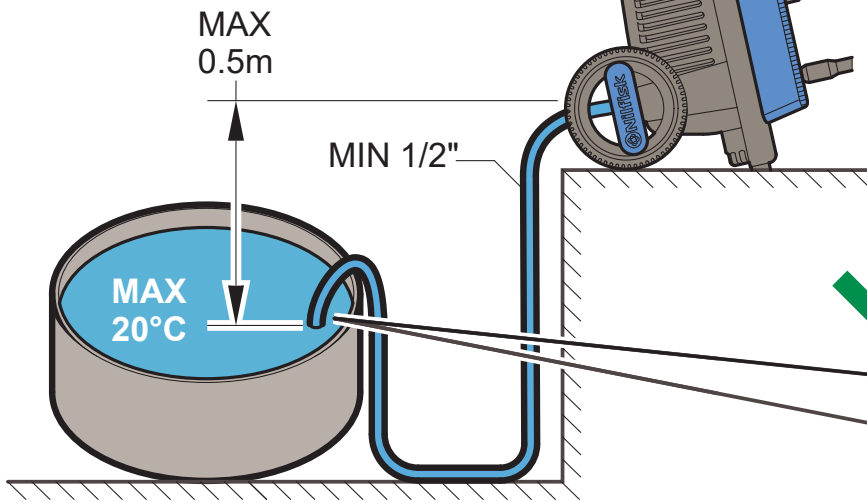
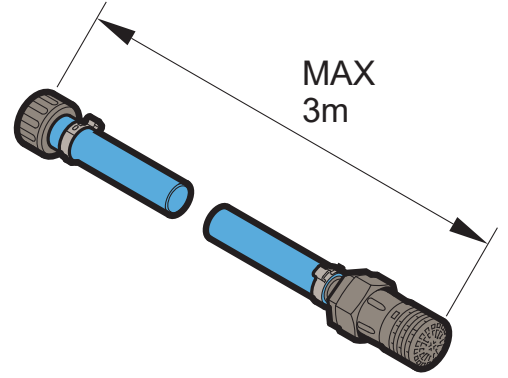

2

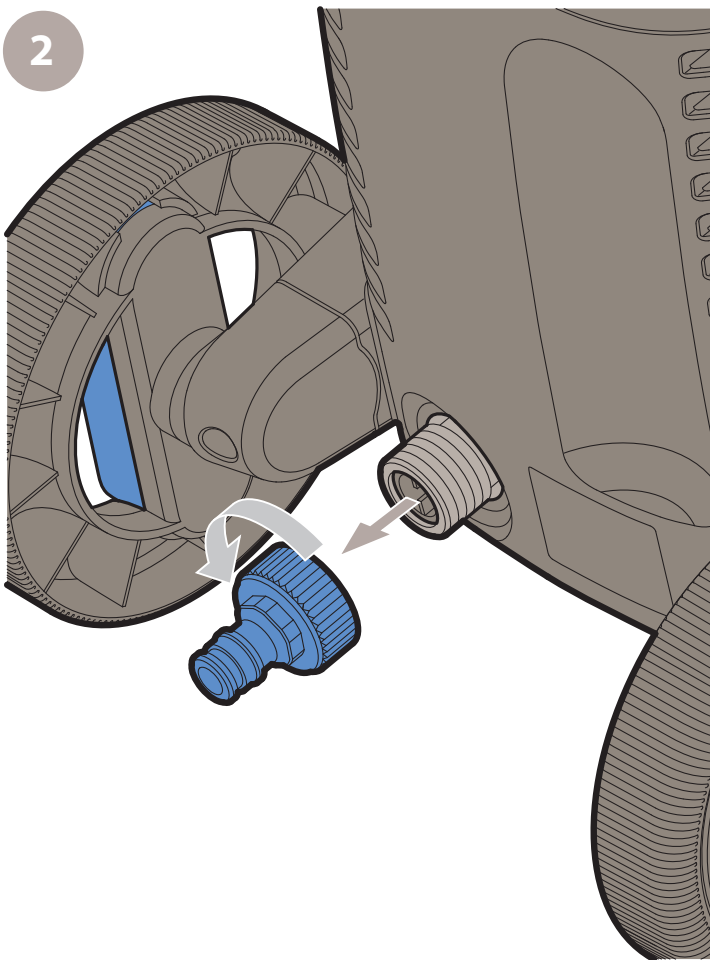

3

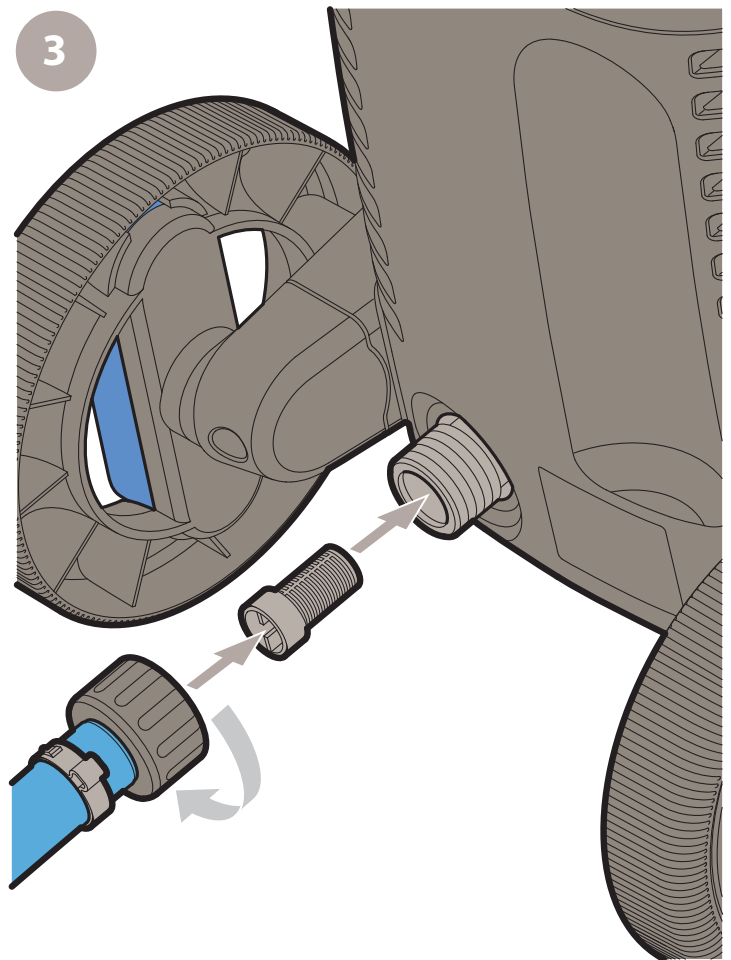

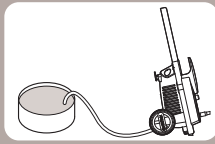

4

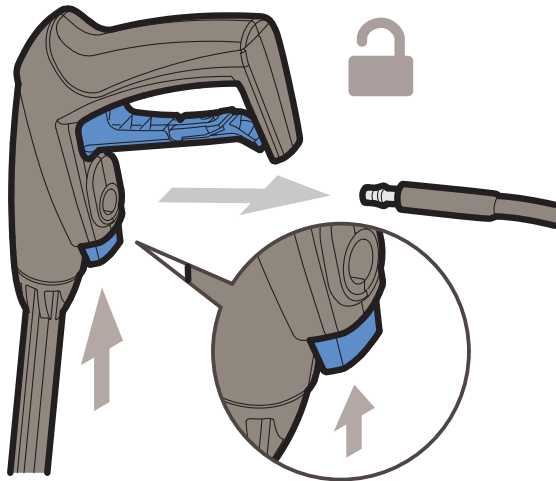

5

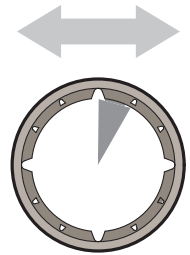
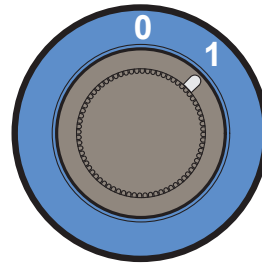

MAX 2min

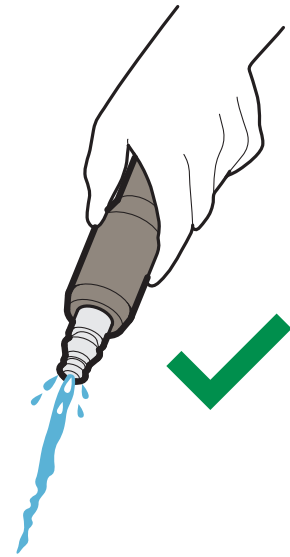

6

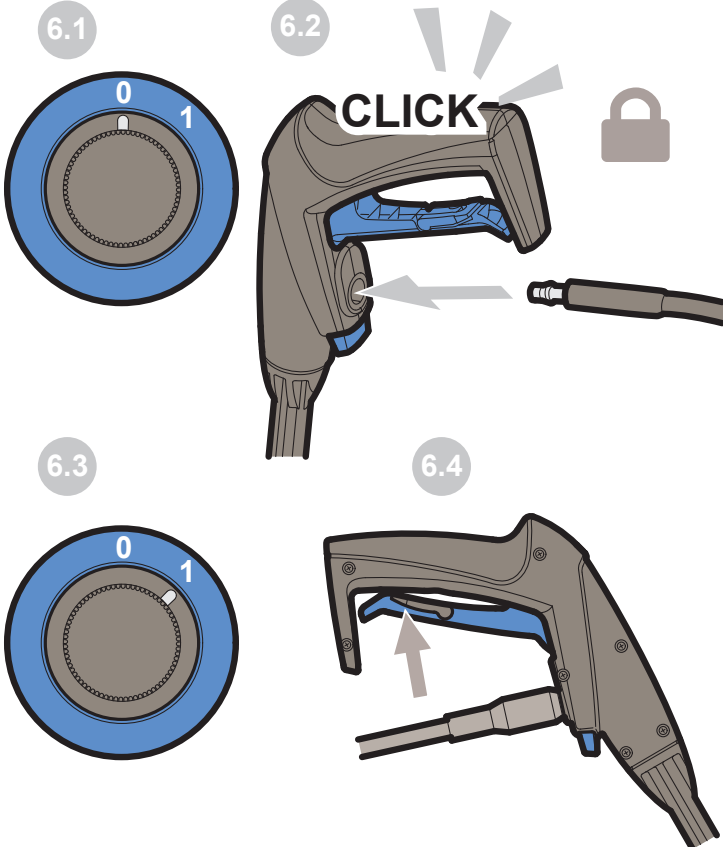

7



D



>5min



1

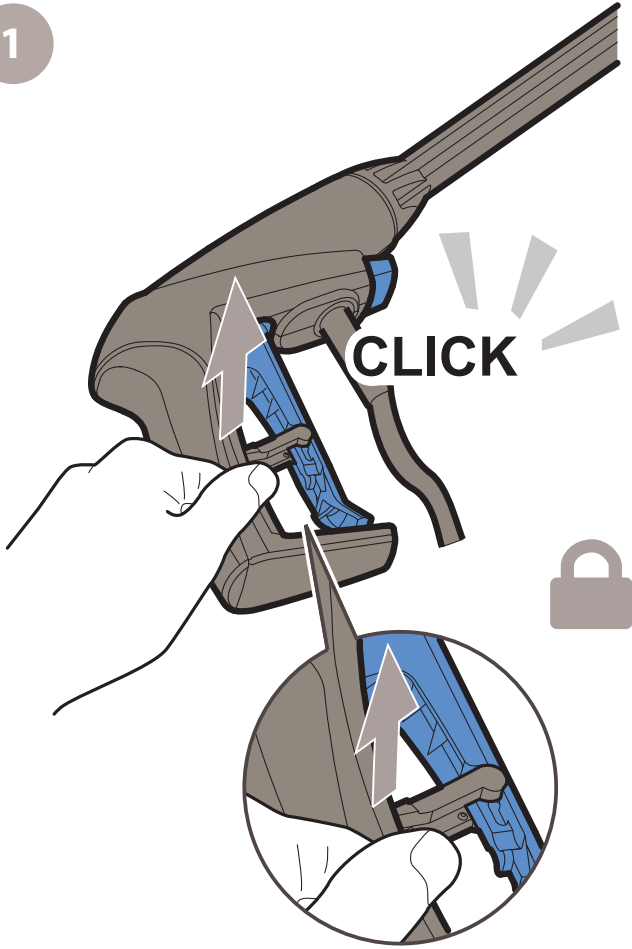

2

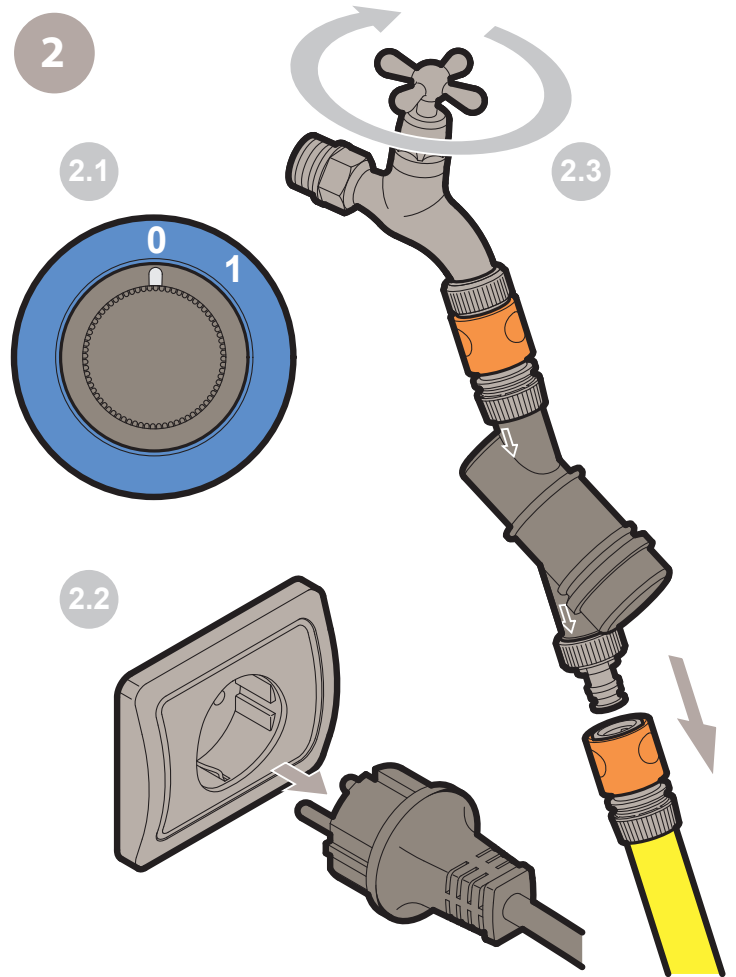

E

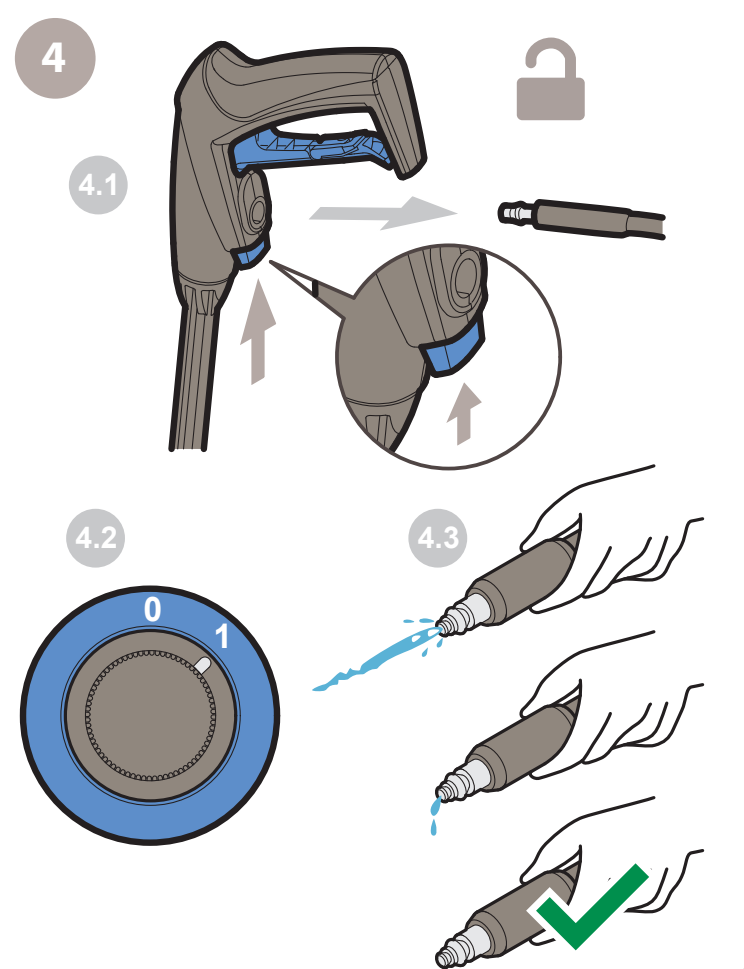
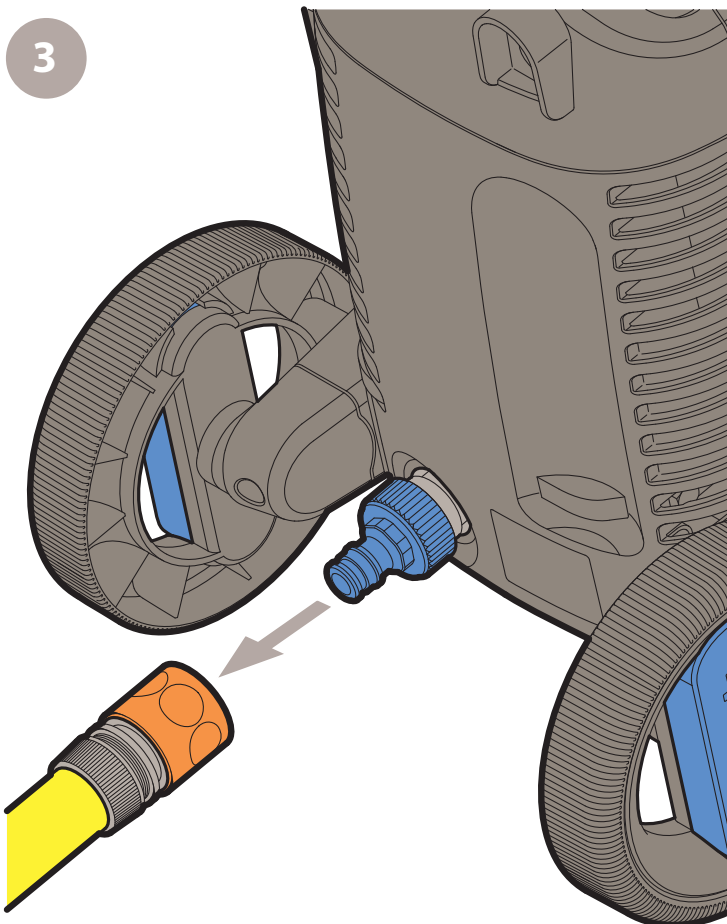
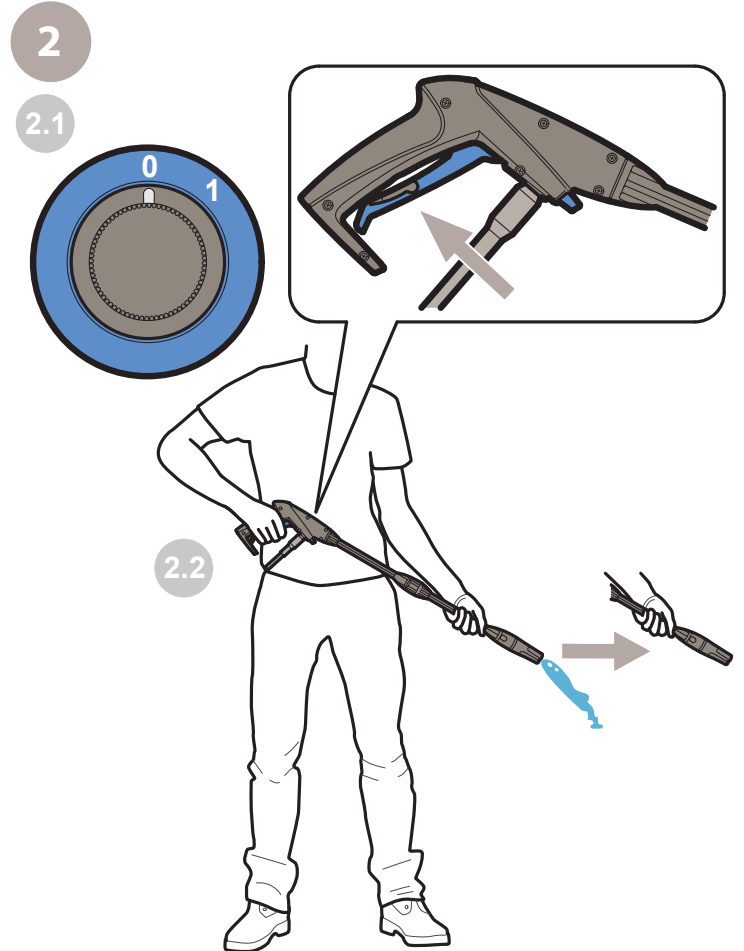
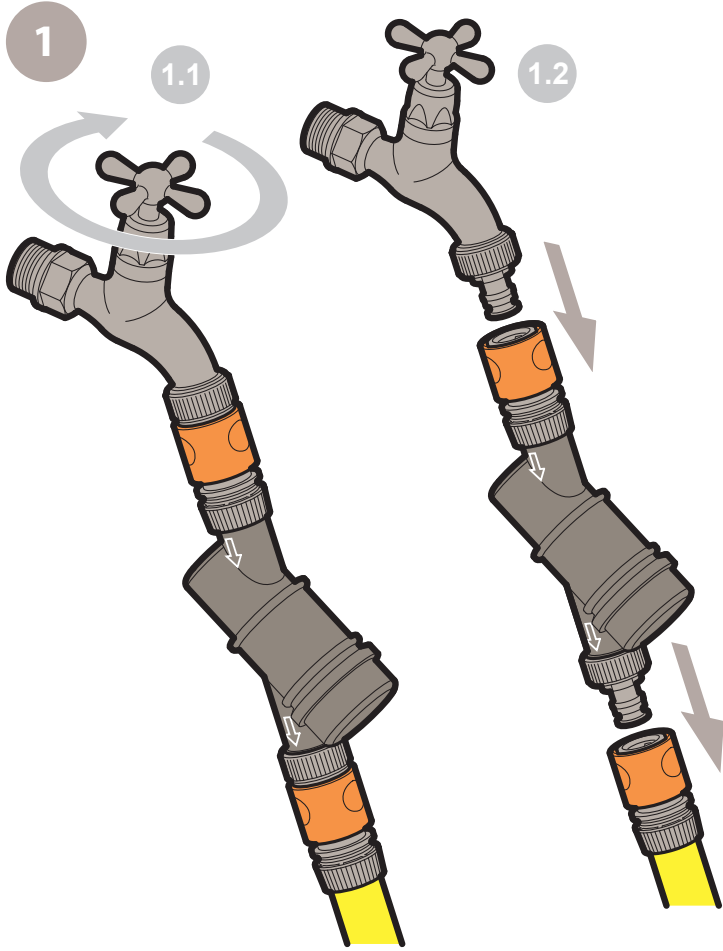
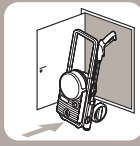

E

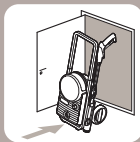

5

5.1

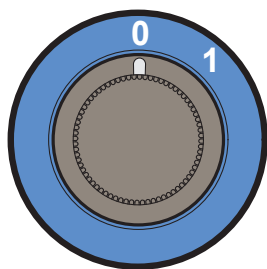

5.2

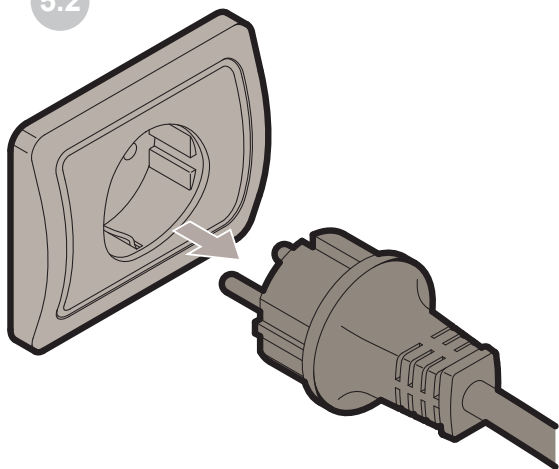

6

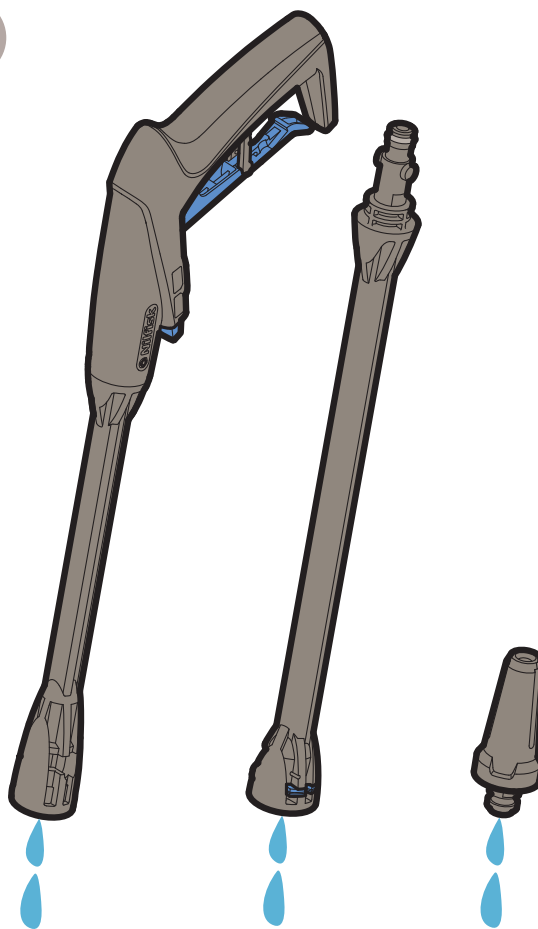

7

7.1

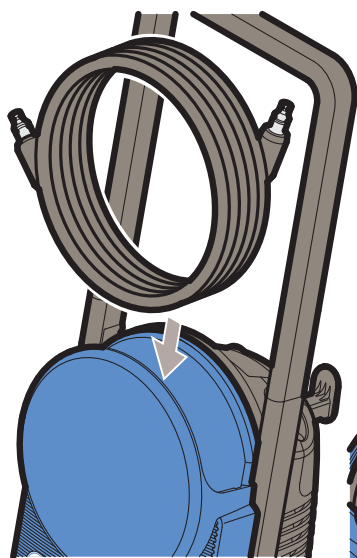

7.2

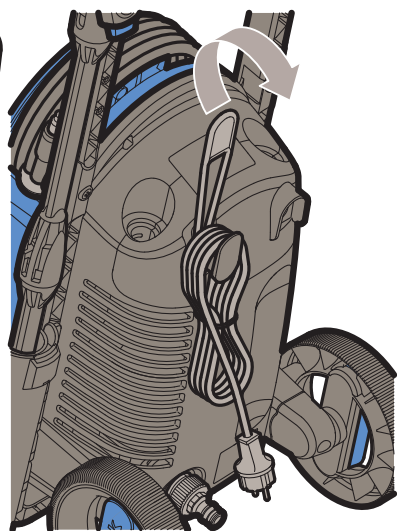

8

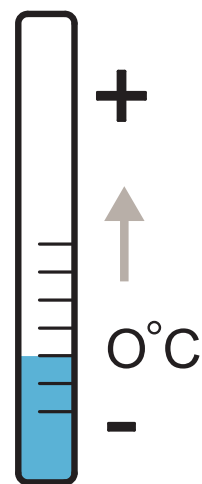
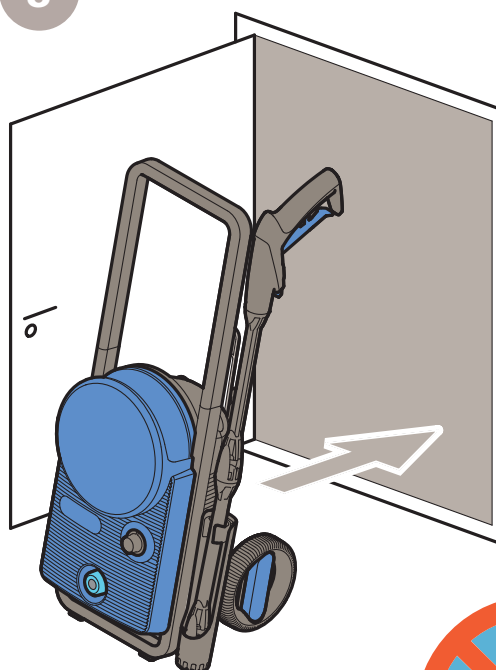

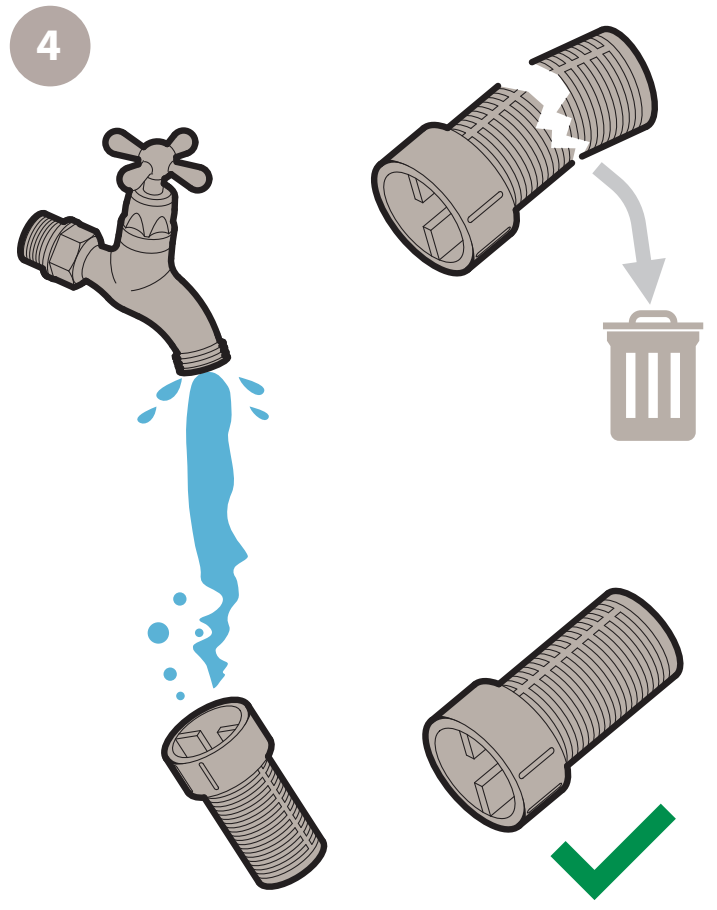
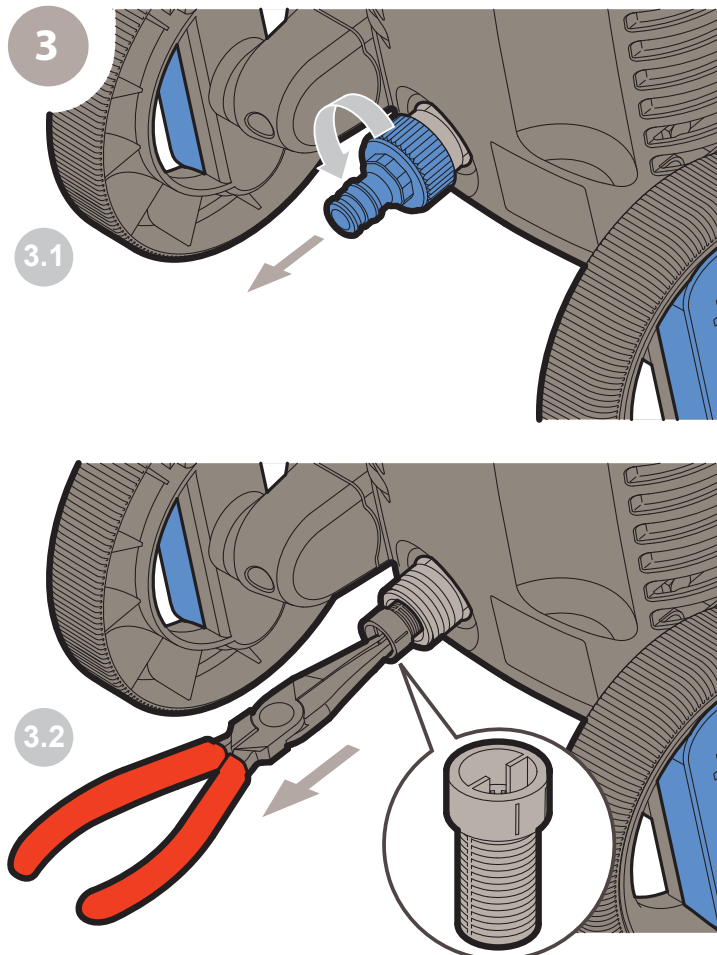
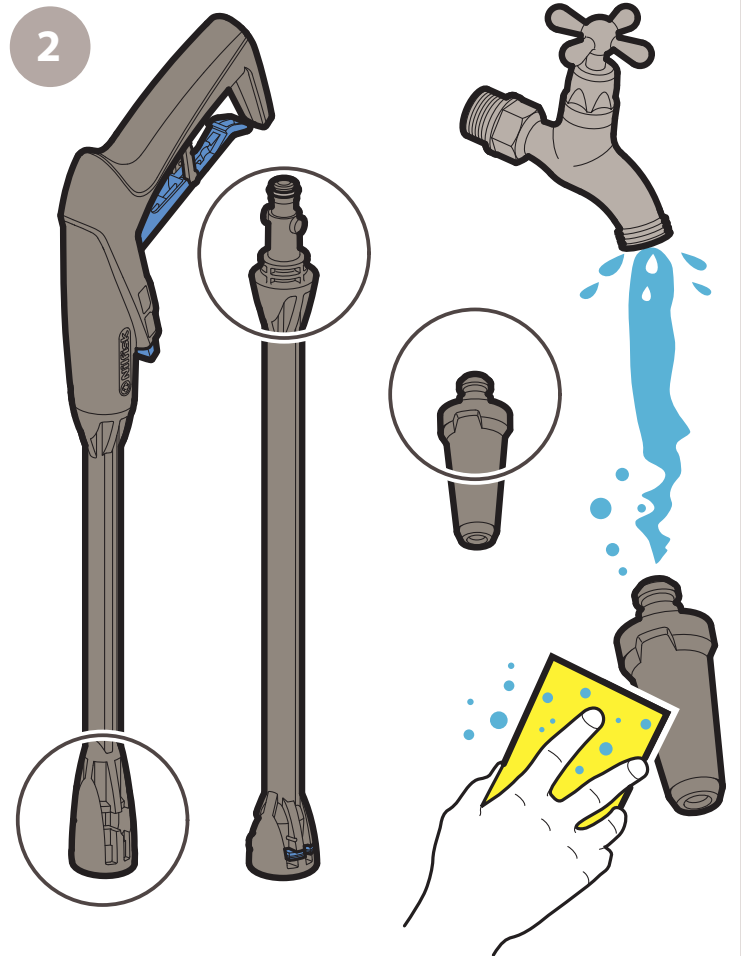
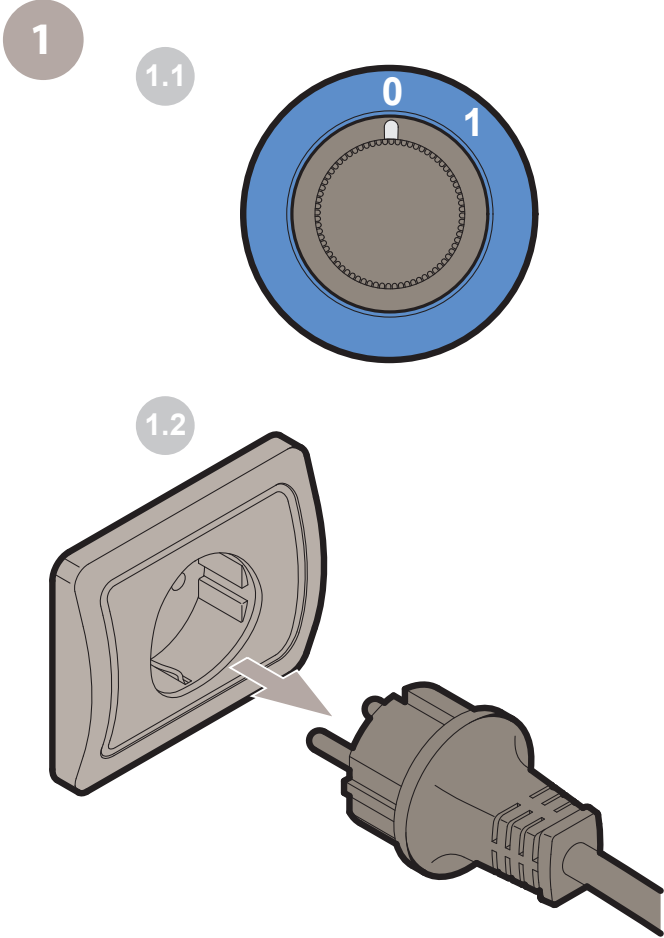



5

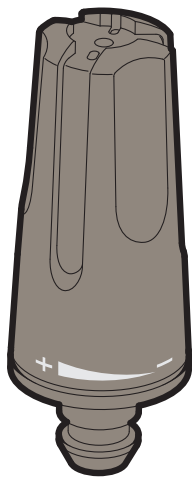
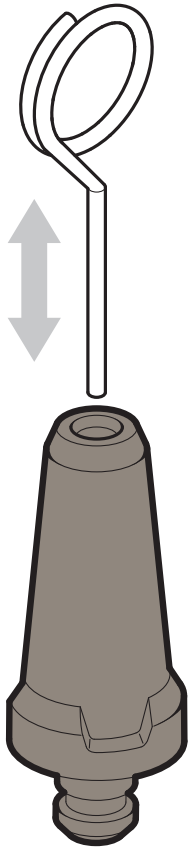

6

