



Ergonomic vertical wireless mouse



Manual DA-20155

The Digitus ergonomic wireless mouse makes it possible to maintain the natural arm and hand position, no matter whether you are working for a long period of time or surfing. The vertical design promises softer movements and relieves the joints. As a result, the source of arm, shoulder and back pains is combated as an auxiliary effect. The fully rubberized coating prevents the hand from slipping, even when working for a long time. Thanks to the rechargeable li-ion battery, the regular change of battery is eliminated, which saves on the wallet as well as the environment. The integrated rechargeable battery, with its 300 mAh, offers an operating time of up to 50 days with normal usage behavior. The mouse itself offers 6 buttons as well as three adjustment possibilities.

Work, surf and play more healthily - with the DIGITUS ergonomic wireless mouse.

Features

1. Built-in Li-ion rechargeable battery
2. Sensitivity - 3 dpi modes: DPI 800-1200-1600 Adjustable
3. 6 buttons: left, right, mid-scroll, DPI, forward, backward
4. Measurement (LWH): 60*77*105mm
5. Weight: 95g
6. Operational range: 10m
7. Operation voltage: 3.7v
8. battery capacity: 300mah
9. Compatible with: Windows 10/8.1/8/7/Vista/XP, Mac OS X, Linux
10. Full rubber coating finish
11. Intelligent sleep and wake up

Diagram

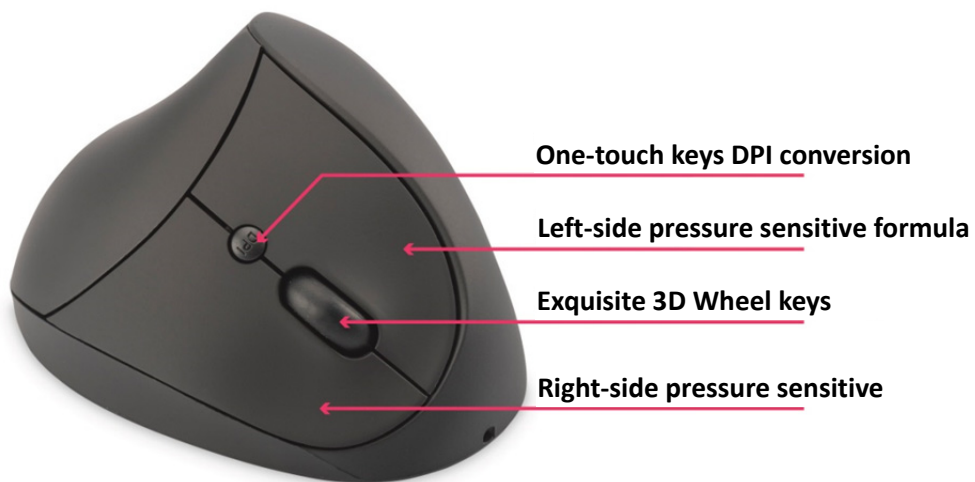

Package content

- 1x Ergonomic vertical wireless mouse
- 1x 3.5" recharging cable
- 1xUSB nano receiver
- 1x User manual

Optical vertical mouse

The mouse is full of vitality, innovation, and has many health benefits. By changing the way you use your wrist and arms, you will effectively reduce pain and discomfort. Add rubber oil coating to prevent sweaty fingers from sliding. From the office to gaming, using the optical vertical mouse is comfortable and healthy.

How to connect with the USB Receiver

Take out the receiver from inside the box and insert USB receiver into the USB port on your computer. Please toggle the power switch on the bottom of the mouse to the "On" position for the first time. The mouse and USB receiver will automatically connect.

Turning off the mouse

When the mouse does not need to be used, toggle the power switch to the "OFF" position. You can leave the USB receiver in computer or pull it out and keep together with vertical mouse.

Hereby ASSMANN Electronic GmbH, declares that this device is in compliance with the requirements of Directive 2014/53/EU and the Directive 2011/65/EU for RoHS compliance. The complete declaration of conformity can be requested by post under the below mentioned manufacturer address.

Warning:

This device is a class B product. This equipment may cause some radio interference in living environment. In this case, the user can be requested to undertake appropriate measures to prevent interference.

www.assmann.com

Assmann Electronic GmbH
Auf dem Schüffel 3
58513 Lüdenscheid
Germany

