

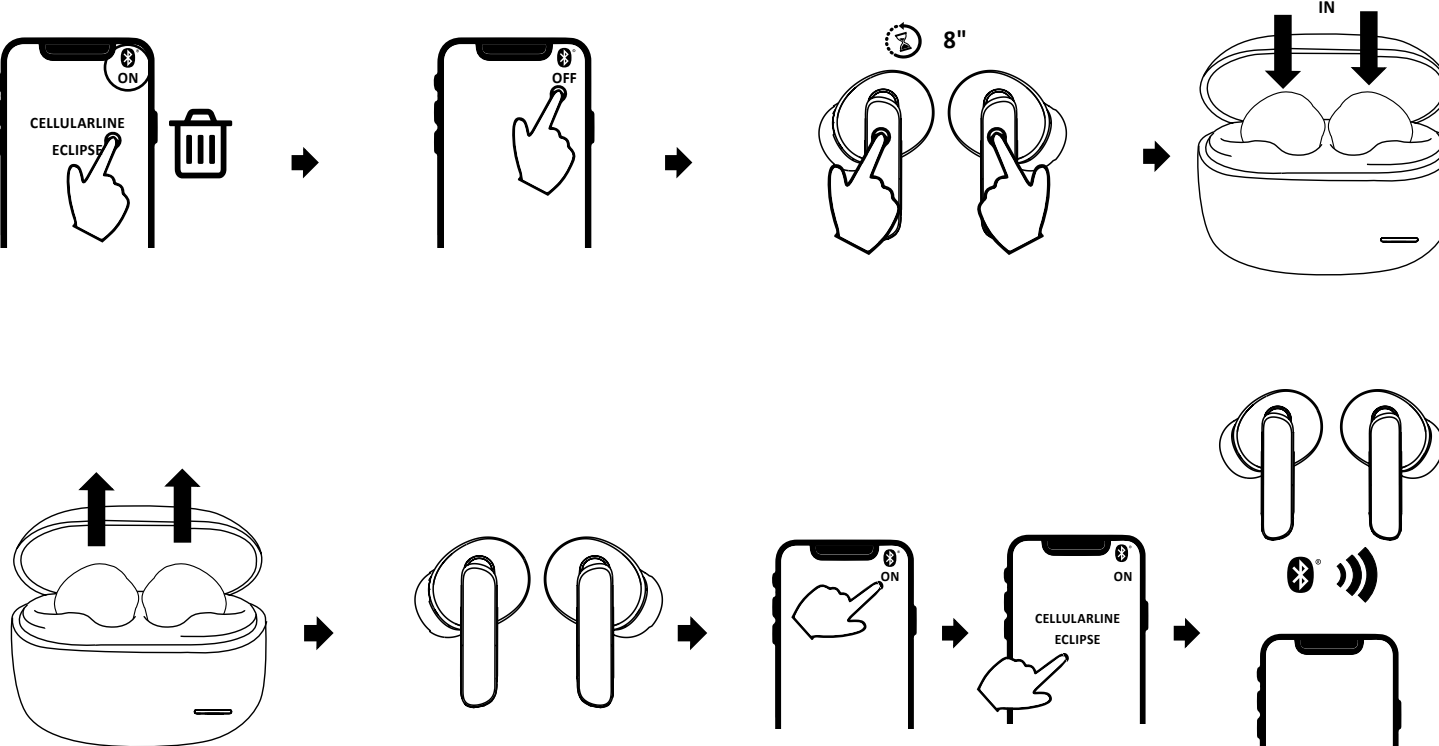

**ECLIPSE**  
WIRELESS HEADSET

BTECLIPSETWSW  
BTECLIPSETWSK

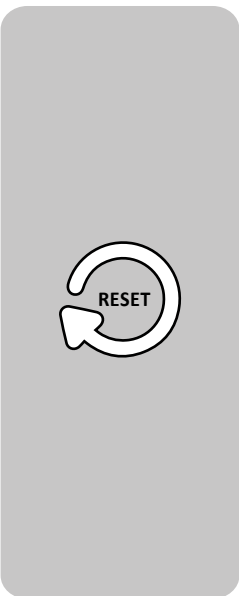
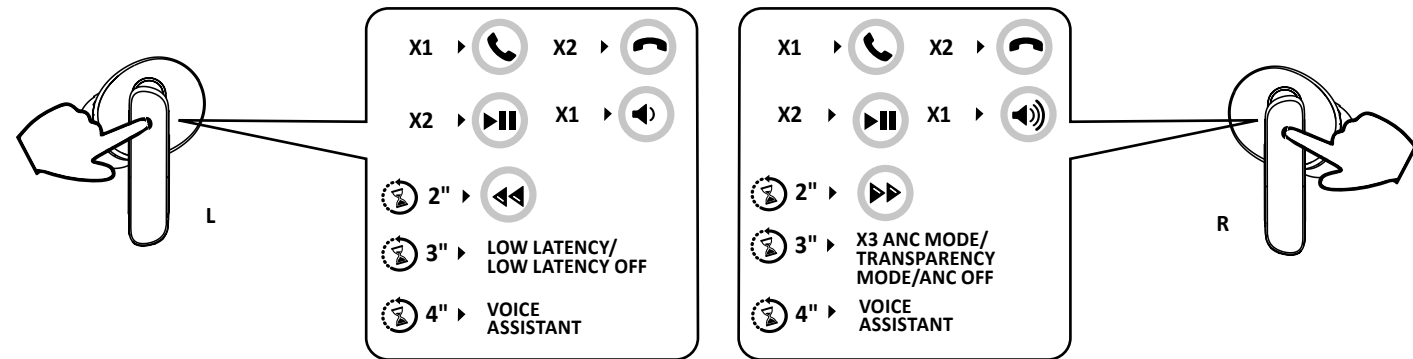
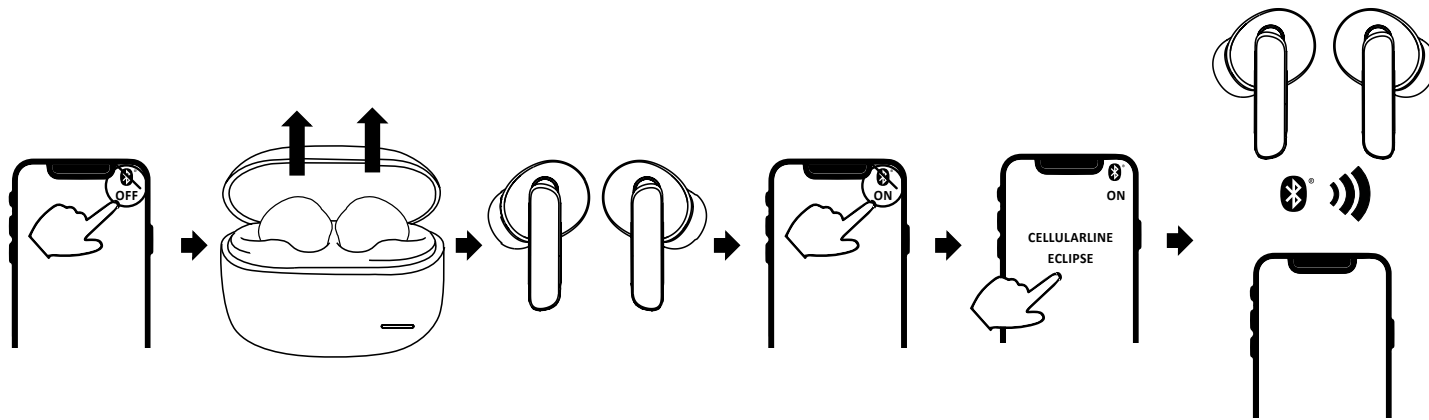
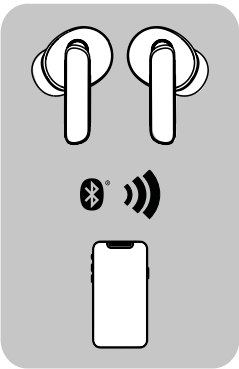
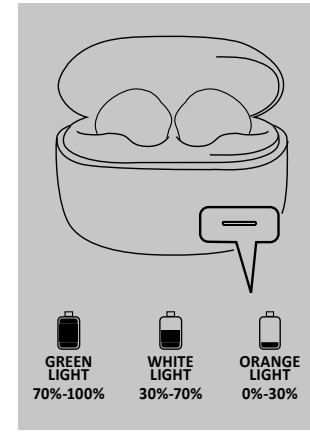
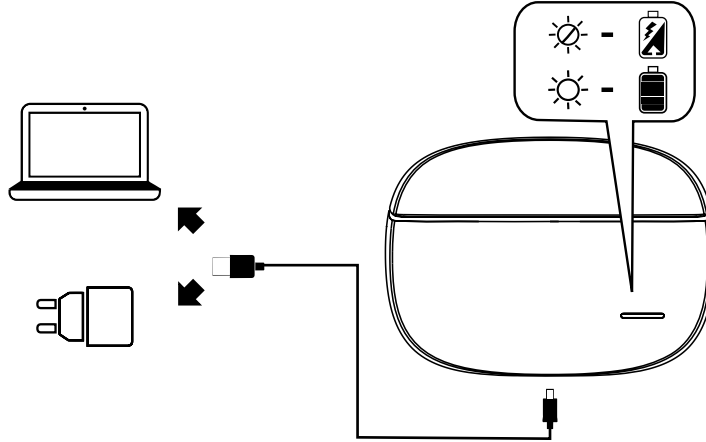
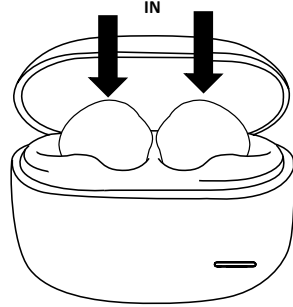
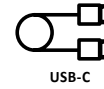
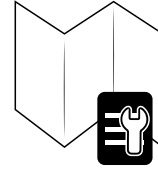
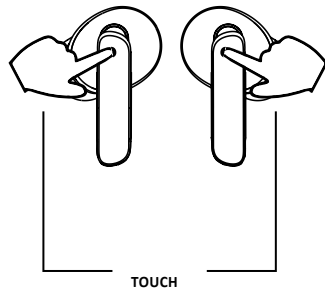
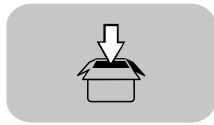

**EN**  
**Technical specifications:**  
Bluetooth® / version: 5.3  
Supported profiles: Headset – Handsfree – A2DP – AVRCP  
Range / metres: 10  
Bluetooth® Frequency Range / Mhz: 2402-2480  
Battery Voltage / Volts: 3.7  
Battery Capacity / mAh: 40  
Charging Case Battery Capacity / mAh: 250  
USB-C port Voltage (V) / Volts: 5  
USB-C port current (A) / Amper: 0.23  
Maximum EIRP / dBm: +9  
Standby Time / hours: 38  
Talk Time / hours: 5  
Play Time / hours: 6  
Earphone recharge / hours/ approx.: 1.5  
Charging Case recharge / hours/ approx.: 2  
Weight / grams: 36

**IT**  
**Specifiche tecniche:**  
Bluetooth® / versione: 5.3  
Profili supportati: Headset – Handsfree – A2DP – AVRCP  
Portata / metri: 10  
Bluetooth® Frequenza Range / Mhz: 2402-2480  
Tensione della batteria / Volt: 3.7  
Capacità della batteria / mAh: 40  
Capacità della batteria del Charging Case / mAh: 250  
Tensione del port USB-C (V) / Volt: 5  
Corrente del port USB-C (A) / Ampere: 0.23  
PIRE max / dBm: +9  
Autonomia in stand-by / ore: 38  
Autonomia in conversazione / ore: 5  
Tempo di riproduzione / ore: 6  
Ricarica auricolari / ore/circa: 1.5  
Ricarica Charging Case / ore/circa: 2  
Peso / grammi: 36

**FR**  
**Spécifications techniques:**  
Bluetooth® / version: 5.3  
Profils supportés: Écouteurs – Mains libres – A2DP – AVRCP  
Portée / mètres: 10  
Gamme de fréquences Bluetooth® / Mhz: 2402-2480  
Tension de la batterie / Volt: 3.7  
Capacité de la batterie / mAh: 40  
Capacité de la batterie du Charging Case / mAh: 250  
Tension du port USB-C (V) / Volt: 5  
Courant du port USB-C (A) / Ampère: 0.23  
PIRE max / dBm: +9  
Autonomie en stand-by / heures: 38  
Autonomie en conversation / heures: 5  
Autonomie en lecture / heures: 6  
Recharge des écouteurs / heures (environ): 1.5  
Recharge du Charging Case / heures (environ): 2  
Poids / grammes: 36

**DE**  
**Technische Eigenschaften:**  
Bluetooth® / Version: 5.3  
Unterstützte Profile: Headset – Handsfree – A2DP – AVRCP  
Reichweite / Meter: 10  
Bluetooth®-Frequenzbereich / Mhz: 2402-2480  
Akkuspannung / Volt: 3.7  
Akkukapazität / mAh: 40  
Charging Case Akkukapazität / mAh: 250  
USB-C-Anschluss Spannung (V) / Volt: 5  
USB-C-Anschluss Strom (A) / Amper: 0.23  
Maximum EIRP / dBm: +9  
Standby-Autonomie / Stunden: 38  
Gesprächszeit / Stunden: 5  
Musikwiedergabezeit / Stunden: 6  
Aufladen Headset / Stunden/ca.: 1.5  
Aufladen Charging Case / Stunden/ca.: 2  
Gewicht / Gramm: 36

**ES**  
**Especificaciones técnicas:**  
Bluetooth® (versión): 5.3  
Perfiles admitidos: Headset – Handsfree – A2DP – AVRCP  
Alcance (metros): 10  
Rango de frecuencia Bluetooth® (Mhz): 2402-2480  
Voltaje de la batería (volts): 3.7  
Capacidad de la batería (mAh): 40  
Capacidad de la batería del Charging Case /mAh: 250  
Voltaje del puerto USB-C (volts): 5  
Corriente del puerto USB-C (amperios): 0.23  
Potencia isotrópica radiada equivalente máxima (dBm): +9  
Tiempo en stand-by (horas): 38  
Tiempo de conversación (horas): 5  
Tiempo de reproducción (horas): 6  
Recarga de los auriculares (horas aprox.): 1.5  
Recarga del Charging Case (horas aprox.): 2  
Peso (gramos): 36

**TR**  
**Teknik özellikler:**  
Bluetooth® / sürüm: 5.3  
Desteklenen profiller: Kulaklık – Eller Serbest – A2DP – AVRCP  
Kapsama alanı / metre: 10  
Bluetooth® Frekans Aralığı/ Mhz: 2402-2480  
Pil Voltajı / Volt: 3.7  
Pil Kapasitesi / mAh: 40  
Charging Case Pil Kapasitesi / mAh: 250  
USB-C port Gerilimi (V) / Volt: 5  
USB-C port akımı (A) / Amper: 0.23  
Maksimum EIRP / dBm: +9  
Bekleme Süresi / saat: 38  
Konuşma Süresi / saat: 5  
Çalma Süresi / saat: 6  
Kulak içi kulaklıkların yeniden şarj edilmesi / saat/yaklaşık: 1.5  
Charging Case Yeniden Şarj Edilmesi / saat/yaklaşık: 2  
Ağırlık / gram: 36

**NL**  
**Technische gegevens:**  
Bluetooth® / Versie: 5.3  
Ondersteunde profielen: Headset – Handsfree – A2DP – AVRCP  
Bereik / meter: 10  
Bluetooth® Frequentiebereik / Mhz: 2402-2480  
Batterijspanning / Volt: 3.7  
Batterijcapaciteit / mAh: 40  
Charging Case Pijlcapaciteit / mAh: 250  
Spanning USB-C-poort (V) / Volt: 5  
Stroomsterkte USB-C-poort (A) / Amper: 0.23  
Maximum EIRP / dBm: +9  
Tijdsduur in stand-by / uur: 38  
Tijdsduur in gesprek / uur: 5  
Afspeeltijd / uur: 6  
Opladtid headset / uur/circa: 1.5  
Opladtid oplaadcase / uur/circa: 2  
Gewicht / gram: 36

**FI**  
**Kuulokkeen tekniset:**  
Bluetooth® / versio: 5.3  
Tuetut profiilit: Headset – Handsfree – A2DP – AVRCP  
Kantavuus / metri: 10  
Bluetooth® taajuusalue / Mhz: 2402-2480  
Akun jännite / voltti: 3.7  
Akun kapasiteetti / mAh: 40  
Charging Case -latauskotelon akun kapasiteetti / mAh: 250  
USB-C -portin jännite (V) / Volt: 5  
USB-C -portin virta (A) / Ampeeri: 0.23  
Maksimi EIRP / dBm: +9  
Standby-aika / tuntia: 38  
Puheskäyttö / tuntia: 5  
Musikkunteluaika / tuntia: 6  
Kuulokkeiden lataaminen / tuntia/noin: 1.5  
Charging Case-latauskotelon lataaminen / tuntia/noin: 2  
Paino / grammaa: 36

**SV**  
**Tekniska specifikationer:**  
Bluetooth® / version: 5.3  
Profiler som stöds: Headset – Handsfree – A2DP – AVRCP  
Räckvidd / meter: 10  
Bluetooth® frekvensområde / Mhz: 2402-2480  
Batterispänning / Volt: 3.7  
Batterikapacitet / mAh: 40  
Batterikapacitet laddningsfodral / mAh: 250  
USB-C-portens spänning (V) / Volt: 5  
USB-C-portens ström (A) / Amper: 0.23  
Maximal EIRP / dBm: +9  
Standbytid / timmar: 38  
Samtalstid / timmar: 5  
Speltid / timmar: 6  
Laddning av hörlurar / timmar/cirka: 1.5  
Laddning laddningsfodral / timmar/cirka: 2  
Vikt / gram: 36

